

SURVEY & REMONUMENTATION
For corner of Lansing Twp.
Ingham Co.
APR 10 1995
COMMISSION

LAND CORNER RECORDATION CERTIFICATE
Filing Requirement of Act 74, Mich. P.A. 1970

Nov 29 9 31 AM '94

REGISTER OF DEEDS
Ingham County
INGHAM COUNTY, MICH.

- Located In: _____ Corner Code: L-1
- Public Land Section T 4N R 2W _____ L-1 _____
T _____ R _____
T _____ R _____
T _____ R _____
 - Property Controlling in Section S _____ T _____ R _____
S _____ T _____ R _____
 - Miscellaneous Property in Sec. S _____ T _____ R _____
S _____ T _____ R _____
 - Lot No. _____ Recorded Plat _____
 - Private Claims _____

Register of Deeds Stamp & File Number

I, Larry A. Bryan, in a field survey on April 7, 19 94, do hereby certify that under requirements of P.A. 74, Michigan P.A. of 1970, the corner points mentioned in lines 1 and 2 above were in conformance with regulations and rules therefore as required in the current manual of survey instructions of the United States Department of the Interior, Bureau of Land Management or by a decree of a Court of Law and/or that the corner points mentioned in lines 3, 4 and 5 above were in conformance with the rules of the Michigan Board of Land Surveyors or by a Decree of a Court of Law; established, re-established, monumented, re-monumented, recovered, found as expressed below:

NOTE: Not more than 4 corners, all in the same town and range, may be recorded on this certificate.

	A	B	C	D	E	F	G	H	I	J	K	L	M
2	6		5		4		3		2				
3													
4	7		8		9		10		11		12		
5													
6	16		17		16		15		14		13		
7													
8	19		20		21		22		23		24		
9													
10	30		29		28		27		26		25		
11													
12	31		32		33		34		35		36		
13													

A. Description of original monument and accessories and/or subsequent restoration:
L-1,

1. No record of this corner being established in original government survey.

(Continued on Back)

B. Description of corner evidence found and/or method applied in restoring or reestablishing corner:

L-1, Investigation at this corner revealed a 1/2' bar in a concrete monument as called for in item #4. All of the witnesses listed in item #3 were gone. A nail and tag #16053 was found in a 10" dead Elm, Southeast 26.55' and in a 8" Elm, Southwest 38.05' from item #4. The remaining witnesses in item #4 were not found. Comparison of the distances between K-1 and L-1 shown on the survey listed in item #3 and the recorded plat of The Crossings at Abbott Parkside reveals a discrepancy of 13.35 feet. This is approximately the falling distance between K-1, T4N, R2W and K-13, T5N, R2W as shown in the G.L.O. notes. Further investigation shows that K-13, T5N, R2W is not recorded. The 3/4" pinch pipe presumed to be K-13, T5N, R2W and used to set K-1, T4N, R2W as shown in Liber 4 of Corners, Page 108 was found. (Continued on Back)

C. Description of monument for corner and accessories established to perpetuate locating the position of the corner:

L-1, T4N-R2W
Set 1/2" I.D. pipe 36" long set as noted above.
Found nail & tag #16053 in Northeast side 10" dead Elm, S70°E, 32.37'.
Found nail & tag #16053 in Northwest side 8" Elm S10°W 34.66'.
Set nail & tag #25832 in South side 6" Poplar, N50°W, 15.26'.
Found concrete monument, East, 7.26'.
Set 1/2" bar and cap #25832, South 1/4 corner Section 36, T5N, R2W, East 5.98'.

Signed by Larry A. Bryan
Surveyor's Michigan License No. 25832

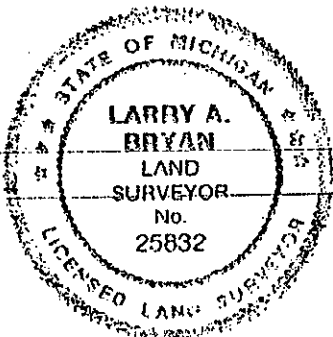

Date 11-23-94

P.A. 345 INGHAM COUNTY
PEER APPROVED 5/11/94

PART "A" CONTINUED

2. Corner referred to in a resurvey of Lansing township by R.J. Robb, County Surveyor, in August and September 1909 (vol. 3, page 218 and 219 County Surveyor Records) and identified as a "cement post 3" square at top and 4" square on bottom and 2.5 feet long, by anchor post of fence going South, under Co. line fence".

3. Marvin F. Fouty, P.S. #18989, recorded corner on 02/27/75 in Liber 3 of Corners, Page 341, and in Liber 2 of Surveys, Pages 308-309, stating no evidence was found of Post set by County Surveyor R.J. Robb in item #2, and set a 1/2" bar in a concrete monument on the Township line midway between the NE and NW Section Corners after researching the records of eight area registered land surveyors. The monument was witnessed by:

Survey tag and nail SW side 6" Poplar NW 56.00'
 Survey tag and nail NW side 8" Poplar NE 60.87'
 Survey tag and nail NE side 4" tree SE 26.28'

4. James E. Stephens, P.S. #16053, recorded corner on 09/13/88 in Liber 6 of Corners, Page 392, as a rod in concrete monument witnessed by survey tags nailed to:

NE side of 10" Elm tree S30°E 26.55 feet
 NW side of 8" Beech tree N55°E 48.07 feet
 West side of 14" Elm tree N30°E 67.76 feet
 NW side of 6" Elm tree S40°W 38.05 feet

5. Corner referred to in Recorded Subdivision Plats: The Crossings at Abbott Parkside, James E. Stephens P.S. #16053, January 18, 1991, Liber 46 of Plats, Page 24, 25 and 26, The Crossings at Abbott Parkside No.2, James E. Stephens P.S. #16053, March 12, 1993, Liber 48 of Plats, Page 3 and 4, The Crossings at Abbott Parkside No.3, James E. Stephens P.S. #16053, July 9, 1993, Liber 48 of Plats, Page 22 and 23.

PART "B" CONTINUED

Its location as K-13, T5N, R2W, is supported by fence remains found North of the 3/4" pinch pipe and measurements to K-12, T5N, R2W, and to the Northeast corner of the Southeast 1/4 of the Southeast 1/4 of Section 35, T5N, R2W. A traverse between J-13, K-13, T5N, R2W and J-1, K-1, L-1 (as recorded) and M-1, T4N, R2W was completed with the following results:

J-1 to K-1	2623.44 feet meas.	
J-13 to K-13	2644.72 feet meas.	
K-1 to L-1	2663.46 feet meas.	2663.32 feet rec. from plat
K-13 to L-1	2651.49 feet meas.	2649.97 feet rec. from survey
L-1 to M-1	2648.91 feet meas.	2649.97 feet rec. from survey
K-13 to M-1	5300.40 feet meas.	5299.94 feet rec. from survey

It appears that L-1 (item #3), T4N, R2W, was supposed to be set 1/2 way between K-1 and M-1 T4N, R2W but was incorrectly set 1/2 way between K-13, T5N, R2W, and M-1 T4N, R2W. It also appears that a 1 foot error was made in the calculations for L-1, and the concrete monument occupies a position +1 foot East of the mathematical location for L-13, T5N, R2W. A diligent search of the area around the mathematical location of L-1, for the monumentation set by R.J. Robb in item #2 revealed no additional information. Set 1/2" I.D. pipe 36" long and cap stamped P.A. 345, P.S. #25832 for L-1, T4N, R2W, 1/2 way between K-1 and M-1, T4N, R2W, and on township line between K-13 and the concrete monument set for L-1.