

FEB 16 1999

REMONUMENTATION CORNER

SECTION

LAND CORNER RECORDATION CERTIFICATE  
Filing Requirement of Act 74, Mich. P.A. 1970

For corners in

IOSCO (County)	Located In:	Corner Code #
1. Public Land Survey	T <u>21</u> NR <u>6E</u>	<u>G-1</u>
	T ___ R ___	_____
	T ___ R ___	_____
	T ___ R ___	_____
2. Property Controlling in Section	S ___ T ___ R ___	_____
	S ___ T ___ R ___	_____
3. Miscellaneous Property in Sec.	S ___ T ___ R ___	_____
	S ___ T ___ R ___	_____

STATE OF MICHIGAN  
IOSCO COUNTY  
FILED

98-29  
DEC 1 1998

RONITA M. COYLE  
REGISTER OF DEEDS

4. Lot No. \_\_\_\_\_, Recorded Plat \_\_\_\_\_  
5. Private Claims \_\_\_\_\_

Register of Deeds Stamp & File Number

	A	B	C	D	E	F	G	H	I	J	K	L	M
1													
2		6		5		4		3		2		1	
3													
4		7		8		9		10		11		12	
5													
6		18		17		16		15		14		13	
7													
8		19		20		21		22		23		24	
9													
10		30		29		28		27		26		25	
11													
12		31		32		33		34		35		36	
13													

I, JAMES H. GRANGER, in a field survey on SEPTEMBER 29, 19 98 do hereby state that under requirements of P.A. 74, Michigan P.A. of 1970, the corner points mentioned in lines 1 and 2 above were in conformance with regulations and rules therefore as required in the current manual of survey instructions of the United States Department of the Interior, Bureau of Land Management or by a decree of a Court of Law and/or that the corner points mentioned in lines 3, 4 and 5 above were in conformance with the rules of the Michigan Board of Land Surveyors or by a Decree of a Court of Law; established, re-established, monumented, recovered, found as expressed below:

NOTE: Not more than 2 corners, all in the same town and range, may be recorded on this certificate.

A. Description of original monument and accessories and/or subsequent restoration:

1843 GLO John Mullett Set wood post 12" cedar S39°W 8 lks  
12" hemlock S53°E 26 lks  
10 lks W of SW cor. sec. 34 T22N, R6E

1972 Survey & LCRC Jerry Wilcox #14102  
Fd. 3/4" pipe Set 4 witnesses L217, pg 361 L72, pg 13

ACCEPTED BY THE IOSCO COUNTY  
SURVEY PEER GROUP AS THE  
OFFICIAL CORNER UNDER P.A.  
345 OF 1990 AT A MEETING  
HELD ON 9-22-98

*James H. Granger*

B. Description of corner evidence found and/or method applied in restoring or reestablishing corner:

Field measured from NE cor Sec. 3 to NW cor. Sec. 6. Established approx. location by Single Proportionate Measurement. Fd 1" pipe in approx. location and a 2" pipe 73.5' NW'ly which appeared to be SW cor. sec. 34, T22N, R6E.

Evaluated measurements on both sides of Township line to establish consistency of measured vs. recorded distances. Neither pipe fits prorated measurements nor closing corner offset per GLO. Established corner location 17.84' west of 1" pipe on line between fd. pipe and NW cor. Sec. 6 at 5,230.14 W of NE corner Sec 3

C. Description of monument for corner and accessories established to perpetuate locating the position of the corner:

Set 5/8" x24" iron rod w/ remon cap

2" Iron pipe	N60°W	57.46'	
1" Iron pipe	EAST	17.84'	
W. Birch 12" dia.	N71°W	3.52'	nail & tag
Aspen 18" dia.	S7°W	19.40'	nail & flag

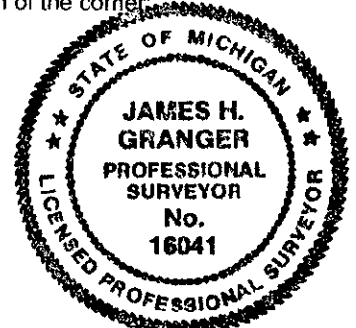

Signed by *James H. Granger*  
Surveyor's Michigan License No. 16041

Date November 2, 1998