

SURVEY & REMONUMENTATION

DEC 13 1993

**IOSCO COUNTY REMONUMENTATION CORNER
LAND CORNER RECORDATION CERTIFICATE
Filing Requirement of Act 74, Mich. P.A. 1970**

REGISTER OF DEEDS
 IOSCO COUNTY, MICH.
Richard L. Miller

93-18 FILED
 Nov 24 4 32 PM '93

For corners in **COMMISSION**

<u>IOSCO</u> (County)	Located In:	Corner Code <u>##</u>
1. Public Land Survey	T <u>22N</u> R <u>6E</u>	<u>K-6</u>
	T _____ R _____	_____
	T _____ R _____	_____
	T _____ R _____	_____
2. Property Controlling in Section	S _____ T _____ R _____	_____
	S _____ T _____ R _____	_____
3. Miscellaneous Property in Sec.	S _____ T _____ R _____	_____
	S _____ T _____ R _____	_____
4. Lot No. _____, Recorded Plat _____		
5. Private Claims _____		

Register of Deeds Stamp & File Number

I, RICHARD L. MILLER in a field survey on OCTOBER 1, 19 93, do hereby certify that under requirements of P.A. 74, Michigan P.A. of 1970, the corner points mentioned in lines 1 and 2 above were in conformance with regulations and rules therefore as required in the current manual of survey instructions of the United States Department of the Interior, Bureau of Land Management or by a decree of a Court of Law and/or that the corner points mentioned in lines 3, 4 and 5 above were in conformance with the rules of the Michigan Board of Land Surveyors or by a Decree of a Court of Law; established, re-established, monumented, re-monumented, recovered, found as expressed below:

A	B	C	D	E	F	G	H	I	J	K	L	M
2	6		5		4		3		2		1	
3												
4	7		8		9		10		11		12	
5												
6	18		17		16		15		14		13	
7												
8	19		20		21		22		23		24	
9												
10	30		29		28		27		26		25	
11												
12	31		32		33		34		35		36	
13												

NOTE: Not more than 4 corners, all in the same town and range, may be recorded on this certificate.

A. Description of original monument and accessories and/or subsequent restoration:

1843 ORIGINAL SUBDIVISION MULLETT & BURT

- SET WOOD POST
- 16" Y. PINE N.14 W. 37 LKS
- 20" W. OAK S.31 E. 35 LKS

1931 DEPENDANT RESURVEY GUY VEAL, APPROVED 1933

- SET 3 1/2" BRASS TABLET IN 6" DIAMETER CONCRETE CYLINDER, 24" LONG
- 13" W. OAK S.8 1/2 E. 165 LKS
- 7" W. OAK N.63 3/4 W. 127 1/2 LKS

1964 U.S.F.S. ROBERT A. GRIFFIN R.L.S. #13584

B. Description of corner evidence found and/or method applied in restoring or reestablishing corner:

FOUND CORNER MONUMENT REPLACED BY GRIFFIN IN 1964. CORNER 14' EAST OF NORTH-SOUTH ROAD CENTERLINE, PLACED 1.0' BELOW SURFACE.

C. Description of monument for corner and accessories established to perpetuate locating the position of the corner:

- 3" DIAMETER BRASS CAP IN 6" REINFORCED CONCRETE MONUMENT 36" LONG
- 10" DOCK SPIKE IN N.W. SIDE OF 14" RED PINE N.40 E. 71.95' (1964)
- 10" DOCK SPIKE IN S.W. SIDE OF 13" RED PINE S.28 E. 75.90' (1964)
- SET WITNESS TAG IN W. SIDE OF 24" W. OAK S.8 1/2 E. 108.84' (1931 & 1964)
- 10" DOCK SPIKE IN S.W. SIDE OF 13" RED PINE N.60 W. 80.55' (1964)

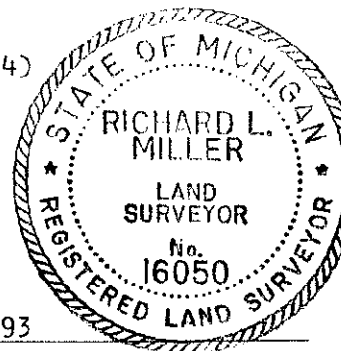

Signed by *Richard L. Miller*

Date NOVEMBER 17, 1993

Surveyor's Michigan License No. 16050