

**SURVEY & REMONUMENTATION**

DEC 13 1993

**COMMISSION IOSCO COUNTY REMONUMENTATION CORNER LAND CORNER RECORDATION CERTIFICATE**  
 Filing Requirement of Act 74, Mich. P.A. 1970

93-42

FILED

DEC 1 11 07 AM '93

REGISTER OF DEEDS  
 IOSCO COUNTY, MICH.  
*Debra M. Cagle*

Register of Deeds Stamp & File Number

For corners in

Iosco (County)	Located In:	Corner Code #
1. Public Land Survey	T <u>22N</u> R <u>6E</u>	<u>M-6</u>
	T _____ R _____	_____
	T _____ R _____	_____
	T _____ R _____	_____
2. Property Controlling in Section	S _____ T _____ R _____	_____
	S _____ T _____ R _____	_____
3. Miscellaneous Property in Sec.	S _____ T _____ R _____	_____
	S _____ T _____ R _____	_____
4. Lot No. _____, Recorded Plat _____		
5. Private Claims _____		

	A	B	C	D	E	F	G	H	I	J	K	L	M
2	6		5		4		3		2		1		
3													
4	7		8		9		10		11		12		
5													
6	18		17		16		15		14		13		
7													
8	19		20		21		22		23		24		
9													
10	30		29		28		27		26		25		
11													
12	31		32		33		34		35		36		
13													

I, James H. Granger, in a field survey on November 15-17, 19 93, do hereby certify that under requirements of P.A. 74, Michigan P.A. of 1970, the corner points mentioned in lines 1 and 2 above were in conformance with regulations and rules therefore as required in the current manual of survey instructions of the United States Department of the Interior, Bureau of Land Management or by a decree of a Court of Law and/or that the corner points mentioned in lines 3, 4 and 5 above were in conformance with the rules of the Michigan Board of Land Surveyors or by a Decree of a Court of Law; established, re-established, monumented, re-monumented, recovered, found as expressed below:

**NOTE: Not more than 4 corners, all in the same town and range, may be recorded on this certificate.**

A. Description of original monument and accessories and/or subsequent restoration:

- 1838 Original Survey, Lewis Clason
- Set Wood Post
- 18" Yellow Pine S60°W 77 lks.
- 5" White Oak N68°W 52 lks.
- 1931 Dependent Resurvey, Guy Veal
- 1964 USFS Robert Griffin #13584

B. Description of corner evidence found and/or method applied in restoring or reestablishing corner:

- Fd. 3 1/4" dia brass cap on conc. cylinder
- No evidence of 1964 witnesses

C. Description of monument for corner and accessories established to perpetuate locating the position of the corner:

- 3 1/4" dia. brass cap on conc. cylinder
- 1931 BT 16" Red Pine N67°E 84.30'
- 1931 BT 28" White Oak S12.75°W 42.17'
- 10" Dock Spk 8" Red Oak S39°E 88.85'
- 10" Dock Spk 12" White Oak N87°W 94.30' (94.25'R)
- 10" Dock Spk 6" White Oak N18°W 78.67' (78.60'R)
- 5"x7" Cedar Post N 1.3'

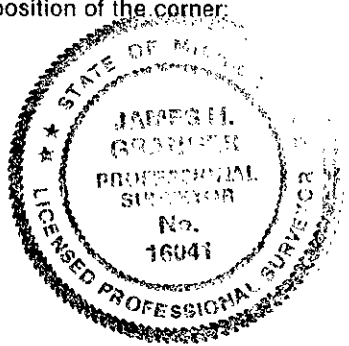

Signed by James H. Granger Date Nov. 30, 1993  
 Surveyor's Michigan License No. 16041