

LAND CORNER RECORDATION CERTIFICATE
Filing Requirement of Act 74, Mich. P.A. 1970 as Amended

For corners in

Iron	Located In:	Corner Code #
<small>(County)</small>		
1. Public Land Survey	T ___ R ___	_____
	T ___ R ___	_____
	T ___ R ___	_____
2. Property Controlling in Section	S ___ T ___ R ___	_____
	S <u>3</u> T <u>41N</u> R <u>33W</u>	<u>1</u>
3. Miscellaneous Property in Sec.	S <u>3</u> T <u>41N</u> R <u>33W</u>	<u>SMC south of #1</u>
	S ___ T ___ R ___	_____
	S ___ T ___ R ___	_____
4. Lot No. _____, Recorded Plat _____		
5. Private Claims		

Register of Deeds Stamp & File
Number

1	A	B	C	D	E	F	G	H	I	J	K	L	M
2	6	5	4	3	2	1							
3													
4	7	8	9	10	11	12							
5													
6	18	17	16	15	14	13							
7													
8	19	20	21	22	23	24							
9													
10	30	29	28	27	26	25							
11													
12	31	32	33	34	35	36							
13													

Apr 29 2004

I, Stephan J. Szyszkoski, in a field survey on _____, 20__ do hereby state that under requirements of P.A. 74, Michigan P.A. of 1970, the corner points mentioned in lines 1 and 2 above were in conformance with regulations and rules therefore as required in the current manual of survey instructions of the United States Department of the Interior, Bureau of Land Management or by a decree of a Court of Law and /or that the corner points mentioned in lines 3, 4 and 5 above were in conformance with the rules of the Michigan Board of Land Surveyors or by a Decree of a Court of Law; established, re-established, monumented, recovered, found as expressed below:

NOTE: Not more than 2 corners, all in the same town and range, may be recorded on this certificate.

A. Description of original monument and accessories and/or subsequent restoration:

(1-Sec. 3) West 1/16 corner between Sections 3 T41N-R33W and 34 T42N-R33W. Not established in the original survey.
 (SMC south of #1) Special meander corner on the left bank of the Brule River between Government Lots 4 and 5, Section 3. Not established in the original survey.

B. Description of corner evidence found and/or method applied in restoring or reestablishing corner:

(1-Sec. 3) Established the corner midway and on a line of mean true bearing between Section corner 1318.88' West and Quarter corner 1318.88' East.
 (SMC south of #1) Established the corner on the 1/16 line between Government Lots 4 and 5 (determined by mean bearing of Section and Quarter lines) and on the bank of the Brule River, 1039.52' South of the monument at 1/16 corner #1, Sec. 3. Water's edge is 13' south.

C. Description of monument for corner and accessories established to perpetuate locating the position of the corner:

(1) Set 1"IDx32" I.pipe with 4" alum. MDNR cap. Blazed, scribed, and set measuring nails in:	(SMC) Set 1"IDx32" I.pipe with 4" alum. MDNR cap. Blazed, scribed, and set measuring nails in:
6" Oak in clump N66E 34.3' "1/16S BT"	6" Spruce N33W 18.7' "SMC BT"
6" Oak S47E 39.0' do	9" Cedar N12W 32.4' do
5" Spruce N88W 51.9' do	11" B.Ash N70E 6.9' do
8" Maple N35W 62.5' do	8" B.Ash S62E 10.8' do
Bearings are magnetic. Distances are to nail with tag.	Set sq'd post adjacent. Bearings are magnetic. Distances are to nail with tag.

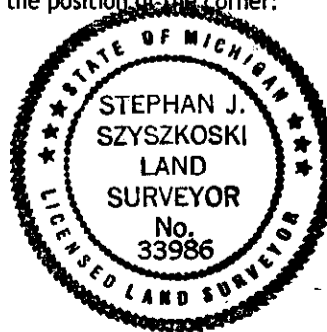

Signed by Stephan J. Szyszkoski
 Surveyor's Michigan License No. 33986

Date 6/24/04

For the Michigan Department of Natural Resources, Office of Land and Facilities