

SURVEY & REMONUMENTATION

FEB 21 2001

SECTION

COMMENCING YEAR 2000
RECEIVED FOR RECORD
IRON COUNTY, MICHIGAN

00 DEC -5 PM 12:48

L.C. Records 12.8.192

LAND CORNER RECORDATION CERTIFICATE
Filing Requirement of Act 74, Mich. P.A. 1970

Robert A. Goodreau
REGISTERED PROFESSIONAL SURVEYOR

For corners in

IRON

(County)

Located In:

Corner Code #

- | | | |
|------------------------------------|-------------------------|-------|
| 1. Public Land Survey | T 42N R 31W | B-11 |
| | T 43N R 31W | B-13 |
| | T _____ R _____ | _____ |
| | T _____ R _____ | _____ |
| 2. Property Controlling in Section | S _____ T _____ R _____ | _____ |
| | S _____ T _____ R _____ | _____ |
| 3. Miscellaneous Property in Sec. | S _____ T _____ R _____ | _____ |
| | S _____ T _____ R _____ | _____ |

Register of Deeds Stamp & File Number

4. Lot No. _____, Recorded Plat _____
5. Private Claims _____

I, Robert A. Goodreau, in a field survey on November 13, 2000 do hereby state that under requirements of P.A. 74, Michigan P.A. of 1970, the corner points mentioned in lines 1 and 2 above were in conformance with regulations and rules therefore as required in the current manual of survey instructions of the United States Department of the Interior, Bureau of Land Management or by a decree of a Court of Law and/or that the corner points mentioned in lines 3, 4 and 5 above were in conformance with the rules of the Michigan Board of Land Surveyors or by a Decree of a Court of Law; established, re-established, monumented, recovered, found as expressed below:

NOTE: Not more than 2 corners, all in the same town and range, may be recorded on this certificate.

	A	B	C	D	E	F	G	H	I	J	K	L	M
1		●											
2	6		5		1		3		2			1	
3													
4	7		0		9		10		11			12	
5													
6	10		1		16		15		14			13	
7													
8	19		20		21		22		23			24	
9													
10	30		29		29		27		26			25	
11													
12	31		32		33		34		35			36	
13		●											

- A. Description of original monument and accessories and/or subsequent restoration:
B-1/B-13

Original corner established by John Burt, U.S. Deputy Surveyor, on 30 July 1846.

Original witnesses: Tamarack 5" N48°E 8 links
Tamarack 5" N47°W 48 links

Murray Yates, RLS restored corner by setting a pipe on 3 December 1953 from a found original bearing tree and an old square tree (Liber 2, Page 18).

- B. Description of corner evidence found and/or method applied in restoring or reestablishing corner:

B-1/B-13

Found 5' iron rod with cap in pipe. Iron rod with cap set by unknown surveyor. Pipe is assumed to have been set by Yates.

No witnesses found.

County record research on file with county representative.

PEER GROUP APPROVED

Erin ...

COUNTY REPRESENTATIVE

- C. Description of monument for corner and accessories established to perpetuate locating the position of the corner:

B-1/B-13

Accepted corner as found.

Note: Measurements taken to a nail in side of witnesses.

New witnesses: 8" Tamarack N85°W 51.73'
5" Spruce N28°W 62.86'
10" Tamarack N60°E 14.60'
8" Tamarack S54°E 11.45'
Sign post South 1'

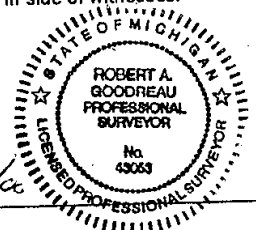

Signed by *RA Goodreau* Date 11/20/00

Surveyor's Michigan License No. 43053

FORM APPROVED BY MICHIGAN STATE BOARD OF PROFESSIONAL SURVEYORS, JAN. 28, 1971
REVISED MAY 14, 1975
REVISED JAN. 1983
REVISED OCT., 1995