

LAND CORNER RECORDATION CERTIFICATE
Filing Requirement of Act 74, Mich. P.A. 1970 as Amended

For corners in

Iron	Located In:	Corner Code #
<small>(County)</small>		
1. Public Land Survey	T <u>42N</u> R <u>31W</u>	<u>F2</u>
	T _____ R _____	_____
	T _____ R _____	_____
	S _____ T _____ R _____	_____
2. Property Controlling in Section	S <u>4</u> T <u>42N</u> R <u>31W</u>	<u>4</u>
	S _____ T _____ R _____	_____
3. Miscellaneous Property in Sec.	S _____ T _____ R _____	_____
	S _____ T _____ R _____	_____
4. Lot No. _____, Recorded Plat _____		
5. Private Claims	<u>4</u> Nov 09 2006	
	<u>F2</u> Nov 06 2006	

Register of Deeds Stamp & File Number

	A	B	C	D	E	F	G	H	I	J	K	L	M
1													
2	6		5					3		2			1
3													
4	7		8			9		10		11			12
5													
6	18		17			16		15		14			13
7													
8	19		20			21		22		23			24
9													
10	30		29			28		27		26			25
11													
12	31		32			33		34		35			36
13													

I, Stephan J. Szyszkoski, in a field survey on _____, 20____ do hereby state that under requirements of P.A. 74, Michigan P.A. of 1970, the corner points mentioned in lines 1 and 2 above were in conformance with regulations and rules therefore as required in the current manual of survey instructions of the United States Department of the Interior, Bureau of Land Management or by a decree of a Court of Law and /or that the corner points mentioned in lines 3, 4 and 5 above were in conformance with the rules of the Michigan Board of Land Surveyors or by a Decree of a Court of Law; established, re-established, monumented, recovered, found as expressed below:

NOTE: Not more than 2 corners, all in the same town and range, may be recorded on this certificate.

A. Description of original monument and accessories and/or subsequent restoration:

- (F2) Center of Section 4. Not established in the original survey.
- (4-Sec. 4) Northwest 1/16 corner, Section 4. Not established in the original survey.

B. Description of corner evidence found and/or method applied in restoring or reestablishing corner:

- (F2) Established the corner at the intersection of straight lines connecting opposite 1/4 corners.
- (4-Sec. 4) Established the corner at the intersection of straight lines connecting opposite 1/16 corners.

C. Description of monument for corner and accessories established to perpetuate locating the position of the corner:

- | | |
|--|--|
| (F2) Set 1"IDx32" I.pipe with 4" alum.
MDNR cap. Set measuring nails in:
10" Cedar N02W 6.7' mrkd "C1/4 BT"
9" Cedar S21E 18.4' do
8" Cedar S30W 15.7' do
11" Cedar N72W 10.0' do
Set sq'd cedar post adjacent. Bearings are magnetic. Distances are to nail with tag. | (4) Set 1"IDx32" I.pipe with 4" alum.
MDNR cap. Set measuring nails in:
5" Sugar N26W 14.7' mrkd "1/16S BT"
5" Balsam N81E 39.2' do
9" Maple S63E 58.5' do
5" Maple N58W 10.6' do
Set sq'd cedar post adjacent. Bearings are magnetic. Distances are to nail with tag. |
|--|--|

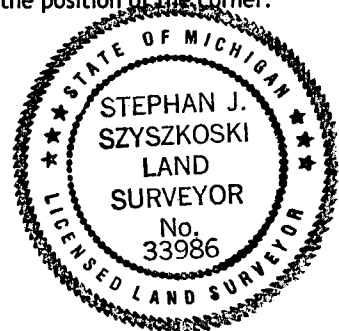

Signed by Stephan J. Szyszkoski
 Surveyor's Michigan License No. 33986

Date 11/13/06

For the Michigan Department of Natural Resources, Office of Land and Facilities