

LAND CORNER RECORDATION CERTIFICATE
Filing Requirement of Act 74, Mich. P.A. 1970 as Amended

For corners in

<u>Iron</u> <small>(County)</small>	Located In:	Corner Code #	
1. Public Land Survey	T <u>42N</u> R <u>32W</u>	<u>G4</u>	
	T _____ R _____	_____	
	T _____ R _____	_____	
	S _____ T _____ R _____	_____	
2. Property Controlling in Section	S <u>10</u> T <u>42N</u> R <u>32W</u>	<u>3</u>	
	S _____ T _____ R _____	_____	
3. Miscellaneous Property in Sec.	S _____ T _____ R _____	_____	
	S _____ T _____ R _____	_____	
4. Lot No. _____, Recorded Plat _____			
5. Private Claims			

Register of Deeds Stamp & File Number

	A	B	C	D	E	F	G	H	I	J	K	L	M
1													
2	6		5		4		3		2		1		
3													
4	7		8		9		10		11		12		
5													
6	18		17		16		15		14		13		
7													
8	19		20		21		22		23		24		
9													
10	30		29		28		27		26		25		
11													
12	31		32		33		34		35		36		
13													

Mar 09 2006

I, Stephan J. Szyszkoski, in a field survey on _____, 20____ do hereby state that under requirements of P.A. 74, Michigan P.A. of 1970, the corner points mentioned in lines 1 and 2 above were in conformance with regulations and rules therefore as required in the current manual of survey instructions of the United States Department of the Interior, Bureau of Land Management or by a decree of a Court of Law and /or that the corner points mentioned in lines 3, 4 and 5 above were in conformance with the rules of the Michigan Board of Land Surveyors or by a Decree of a Court of Law; established, re-established, monumented, recovered, found as expressed below:

NOTE: Not more than 2 corners, all in the same town and range, may be recorded on this certificate.

A. Description of original monument and accessories and/or subsequent restoration:

(G4) Quarter corner common to Sections 9 and 10. 1971: Reestablished by A.O.Enger RLS midway and on line between Section corners 39.997 chains North and South. Set 1"IDx36" I.pipe with 4" aluminum cap. J.Pine 5" N60E 28.1', J.Pine 5" S25E 33.8'.
 (3-Sec. 10) North 1/16 corner between Sections 9 and 10. Established in 1971 by A.O.Enger RLS, on line between section corner 19.998 ch. N and 1/4 corner 19.998 ch. S. Set 1"IDx36" iron pipe with 4" aluminum cap. J.Pine 11" S17E 23.0', J.Pine 13 S83E 35.3'.

B. Description of corner evidence found and/or method applied in restoring or reestablishing corner:

(G4) Recovered the 1971 monument in good condition. The 1971 witness trees were not recovered. Verified the position of the corner with respect the Section corners north and south and accepted same as a careful and faithful reestablishment of the position of the original corner.
 (3-Sec. 10) Found the 1971 monument, in good condition, and at record bearing and distance from the remaining 1971 NBT J.Pine S83E, in good condition. Verified the position of the monument with respect to the Section and Quarter corners and found it to be in accordance with the 1971 record. Left the monument in place and made new witnesses as described below.

C. Description of monument for corner and accessories established to perpetuate locating the position of the corner:

(G4) Found 1"ID I.pipe with 4" alum. MI Dept. of Conservation cap. Set measuring nails in:	(3) Found 1"ID I.pipe with 4" alum MI Dept. of Conservation cap. Set measuring nails in:
6" J.Pine S86E 20.5' mrkd "1/4S NBT"	14" J.Pine S79E 35.8' mrkd "1/16S BT" *
4" J.Pine S24W 8.5' do	6" J.Pine S39W 9.8' do
9" J.Pine S66W 30.7' do	9" J.Pine N42W 15.6' do
3" J.Pine S88W 18.2' do	8" J.Pine N42E 10.0' do
Set sq'd cedar post adjacent. Bearings are magnetic. Distances are to nail with tag.	Set sq'd J.Pine post adjacent. Bearings are magnetic. Distances are to nail with tag. * denotes 1971 NBT.

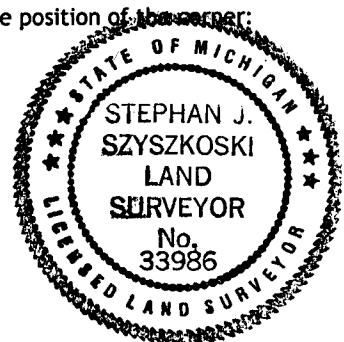

Signed by Stephan J. Szyszkoski
 Surveyor's Michigan License No. 33986

Date 7/27/06

For the Michigan Department of Natural Resources, Office of Land and Facilities