

LAND CORNER RECORDATION CERTIFICATE
Filing Requirement of Act 74, Mich. P.A. 1970 as Amended

For corners in

Iron <small>(County)</small>	Located In:	Corner Code #
1. Public Land Survey	T <u>42N</u> R <u>32W</u>	<u>J5</u>
	T <u>42N</u> R <u>32W</u>	<u>J4</u>
	T _____ R _____	_____
	S _____ T _____ R _____	_____
2. Property Controlling in Section	S _____ T _____ R _____	_____
	S _____ T _____ R _____	_____
3. Miscellaneous Property in Sec.	S _____ T _____ R _____	_____
	S _____ T _____ R _____	_____
4. Lot No. _____, Recorded Plat _____		
5. Private Claims	J4 Jun 01 2006	
	J5 Mar 16 2006	

Register of Deeds Stamp & File
Number

	A	B	C	D	E	F	G	H	I	J	K	L	M
1													
2	6		5		4		3		2		1		
3													
4	7		8		9		10		11		12		
5													
6	18		17		16		15		14		13		
7													
8	19		20		21		22		23		24		
9													
10	30		29		28		27		26		25		
11													
12	31		32		33		34		35		36		
13													

I, Stephan J. Szyszkoski, in a field survey on _____, 20____ do hereby state that under requirements of P.A. 74, Michigan P.A. of 1970, the corner points mentioned in lines 1 and 2 above were in conformance with regulations and rules therefore as required in the current manual of survey instructions of the United States Department of the Interior, Bureau of Land Management or by a decree of a Court of Law and /or that the corner points mentioned in lines 3, 4 and 5 above were in conformance with the rules of the Michigan Board of Land Surveyors or by a Decree of a Court of Law; established, re-established, monumented, recovered, found as expressed below:

NOTE: Not more than 2 corners, all in the same town and range, may be recorded on this certificate.

A. Description of original monument and accessories and/or subsequent restoration:

- (J5) Quarter corner common to Sections 11 and 14. 2001: Gary L. Pisoni, RLS found and accepted a WI-MI Power Company concrete monument with brass cap marking the corner position. New witnesses: J.Pine 7" N23E 19.79', J.Pine 8" S68E 33.71', J.Pine 16" S28W 12.52', J.Pine 9" N39W 10.66', Steel sign post N80E 0.85'. The corner record was approved by the Iron County Peer Review group and is recorded in L.9 of L.C.R. P. 175.
- (J4) Center of Section 11. Not established in the original survey. Found no subsequent record.

B. Description of corner evidence found and/or method applied in restoring or reestablishing corner:

- (J5) Found and accepted a 7" sq. concrete monument with brass cap by WI-MI Power Company, in good condition, and at record bearing and distance from the 2001 witnesses, three of which are now dead and down. Left the monument in place and made new witnesses as described below.
- (J4) Established the corner at the intersection of 1/4 lines. The E-W 1/4 line is a straight line between Quarter corners, and the N-S 1/4 line is a straight line from the S1/4 corner to the midpoint between Section corners I3 and K3, both of record. From the position thus established, I found a WI-MI Power Company monument, with brass cap stamped to indicate the Center of Section, S84E 60.0' distant. I did not accept the WMPCO monument as marking the position for the corner.

C. Description of monument for corner and accessories established to perpetuate locating the position of the corner:

- | | |
|---|--|
| (J5) Found WI-MI Power Company concrete monument. | (J4) Set 1"IDx32" I.pipe with 4" alum. MDNR cap. Set measuring nails in: |
| 6" N.Pine N48E 72.4' wrkd "1/4S NBT" | 7" Poplar N06W 17.3' wrkd "C1/4 BT" |
| 8" R.Pine S53W 106.1' do | 6" Poplar N42E 14.3' do |
| 6" R.Pine N20W 18.7' do | 8" Poplar S42W 19.7' do |
| Fd. 8" J.Pine S66E 33.6' "X BT" w/nail | 10" Poplar N66W 24.0' do |
| Fd. Steel sign post N75E 0.85' | Set sq'd cedar post adjacent. Bearings |
| Bearings are magnetic. Distances to trees are to nail with tag. | are magnetic. Distances are to nail with tag. |

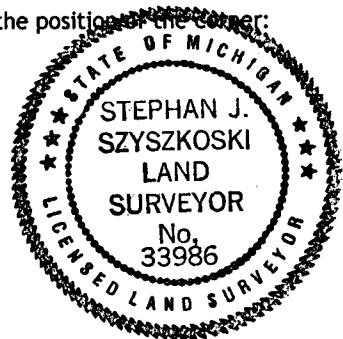

Signed by Stephan J. Szyszkoski
 Surveyor's Michigan License No. 33986

Date 7/27/06

For the Michigan Department of Natural Resources, Office of Land and Facilities