

# SURVEY & REMONUMENTATION

FORM NO. 985-A



Stock No. 26273

MAR 19 1997

## COMMISSION

### LAND CORNER RECORDATION CERTIFICATE Filing Requirement of Act 74, Mich. P.A. 1970

For corners in

<u>Iron</u> (County)	Located In:	Corner Code #
1. Public Land Survey	T <u>42N</u> R <u>34W</u>	<u>M-11</u>
2. Property Controlling in Section	T <u>42N</u> R <u>33W</u>	<u>A-11</u>
3. Miscellaneous Property in Sec.	T _____ R _____	_____
	S _____ T _____ R _____	_____
	S _____ T _____ R _____	_____
	S _____ T _____ R _____	_____

IRON COUNTY MICHIGAN RECEIVED FOR RECORD

96 DEC 23 AM 9:05  
L.C. Records 1.7, P. 50  
*William J. Pisoni*  
COUNTY CLERK

Register of Deeds Stamp & File Number

4. Lot No. \_\_\_\_\_, Recorded Plat \_\_\_\_\_  
5. Private Claims \_\_\_\_\_

Section Corner 25, T42N R34W, 30, T42N R33W,  
36, T42N R34W, 31, T42N R33W

I, Gary L. Pisoni, in a field survey on November 11, 1996 do hereby state that under requirements of P.A. 74, Michigan P.A. of 1970, the corner points mentioned in lines 1 and 2 above were in conformance with regulations and rules therefore as required in the current manual of survey instructions of the United States Department of the Interior, Bureau of Land Management or by a decree of a Court of Law and /or that the corner points mentioned in lines 3, 4 and 5 above were in conformance with the rules of the Michigan Board of Land Surveyors or by a Decree of a Court of Law; established, re-established, monumented, recovered, found as expressed below:

	A	B	C	D	E	F	G	H	I	J	K	L	M
1													
2	6		5		4		3		2		1		
3													
4	7		8		9		10		11		12		
5													
6	18		17		16		15		14		13		
7													
8	19		20		21		22		23		24		
9													
10	30		29		28		27		26		25		
11													
12	31		32		33		34		35		36		
13													

NOTE: Not more than 2 corners, all in the same town and range, may be recorded on this certificate.

A. Description of original monument and accessories and/or subsequent restoration:

Original corner established by Austin Burt, U.S. Deputy Surveyor on September 8, 1846.  
Original corner: Ironwood Post  
Original bearing trees:  
Cedar 10" S 60° E 27 links (17.82 feet)  
Cedar 12" N 72° W 16 links (10.56 feet)  
Original Subdivision established by Guy H. Carleton in October, 1851.  
Original bearing trees:  
Sugar Maple 16" N 23° E 62 Links (40.92 feet)  
Sugar Maple 10" S 33° W 31 Links (20.46 feet)

PEER GROUP APPROVED  
*Iron Gary L. Pisoni 12-11-96*  
COUNTY REPRESENTATIVE

B. Description of corner evidence found and/or method applied in restoring or reestablishing corner:

No original corner evidence found.  
In 1973, Donald D. Lappala RLS found an iron pipe marking section corner position-said pipe located in a farm field and along a fence line running North and East. Also section corner is part of the Plat of the Village of Pentoga dated 1901.  
In 1994, I found section corner pipe bent over, replaced pipe with a 5/8" by 30" long rebar.  
In 1996, found same rebar marking section corner position and accepted the pin as the best available evidence for restoring the section corner.  
Corner Record Research on file with County Representative.

C. Description of monument for corner and accessories established to perpetuate locating the position of the corner:

Over the top of the existing rebar pin, I set a 2" diameter by 30" long split base aluminum pipe monument with a 3" cast aluminum cap, stamped to read: Iron County Remonumentation, T42N, R34W, R33W, S-25, S-30, S-36, S-31, 1996, RLS-27457 from which I established the following new reference objects:

Iron Bar	1" x 4'	S 67° E	5.22 feet
Rebar	5/8" x 30"	S 25° E	22.38 feet
Rebar	5/8" x 30"	S 37° W	52.34 feet
Rebar	5/8" x 30"	N 40° W	51.44 feet
Rebar	5/8" x 30"	N 41° E	14.88 feet
Snow Fence Stake		N 67° W	0.30 feet
Steel Sign Post	6'	South	1.28 feet

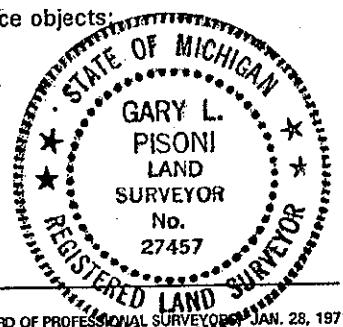

#96-28  
Signed by Gary L. Pisoni Date 12-10-96  
Surveyor's Michigan License No. 27457

L.7 P.50