

SURVEY & REMONUMENTATION

FORM NO. 985-A



Stock No. 26273

MAR 19 1997

COMMISSION

LAND CORNER RECORDATION CERTIFICATE Filing Requirement of Act 74, Mich. P.A. 1970

For corners in

<u>Iron</u> (County)	Located In:	Corner Code #
1. Public Land Survey	T <u>42N</u> R <u>R33W</u>	<u>G-11</u>
	T _____ R _____	_____
	T _____ R _____	_____
	T _____ R _____	_____
2. Property Controlling in Section	S _____ T _____ R _____	_____
	S _____ T _____ R _____	_____
3. Miscellaneous Property in Sec.	S _____ T _____ R _____	_____
	S _____ T _____ R _____	_____

IRON COUNTY
MICHIGAN
RECEIVED FOR RECORD

96 DEC 23 AM 9:11

L.C. Records L. 7, P. 63

Gary L. Pisoni
REGISTERED LAND SURVEYOR

Register of Deeds Stamp & File Number

4. Lot No. _____, Recorded Plat _____
5. Private Claims _____

Section Corner 27, 28, 33 & 34, T42N R33W

I, Gary L. Pisoni, in a field survey on November 12, 1996 do hereby state that under requirements of P.A. 74, Michigan P.A. of 1970, the corner points mentioned in lines 1 and 2 above were in conformance with regulations and rules therefore as required in the current manual of survey instructions of the United States Department of the Interior, Bureau of Land Management or by a decree of a Court of Law and for that the corner points mentioned in lines 3, 4 and 5 above were in conformance with the rules of the Michigan Board of Land Surveyors or by a Decree of a Court of Law; established, re-established, monumented, recovered, found as expressed below:

NOTE: Not more than 2 corners, all in the same town and range, may be recorded on this certificate.

	A	B	C	D	E	F	G	H	I	J	K	L	M
1													
2	6		5		4		3		2		1		
3													
4	7		8		9		10		11		12		
5													
6	18		17		16		15		14		13		
7													
8	19		20		21		22		23		24		
9													
10	30		29		28		27		26		25		
11													
12	31		32		33		34		35		36		
13													

A. Description of original monument and accessories and/or subsequent restoration:

Original corner established by Guy H. Carleton, U.S. Deputy Surveyor in 1851.
Original corner: Wood Post
Original bearing trees:
Sugar 10" S 18°E 24 links (15.84 feet)
Sugar 12" N 57°W 50 links (33.00 feet)

PEER GROUP APPROVED
Iron Gary L. Pisoni 12-1-96
COUNTY REPRESENTATIVE

B. Description of corner evidence found and/or method applied in restoring or reestablishing corner:

No original corner evidence found.

Found an old fence corner marking corner position. Fence line runs North and West. John Novey and his father homesteaded the farm property back in the early 1900's. Mr. Novey showed me the fence corner which has been used as the section corner since the early 1900's.

I accept the fence corner as the best available evidence for restoring corner position.

Corner Record Research on file with County Representative.

C. Description of monument for corner and accessories established to perpetuate locating the position of the corner:

At the fence corner, I set a 2" diameter by 30" long split base aluminum pipe monument with a 3" cast aluminum cap, stamped to read: Iron County Remonumentation, T42N, R33W, S-28, S-27, S-33, S-34, 1996, RLS-27457 from which I established the following new blazed and scribed bearing trees: (all measurements taken to a nail in side of tree)

White Birch	9"	N 14° E	13.28 feet
White Ash	9"	N 80° E	29.70 feet
Red Maple	6"	S 16° E	35.11 feet
Red Maple	6"	N 88° W	58.12 feet
Snow Fence Stake		S 16° E	0.90 feet
Steel Sign Post	6'	N 60° E	0.76 feet

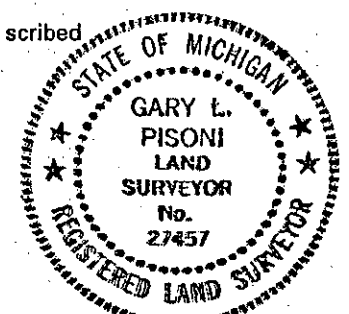

#96-41
Signed by Gary L. Pisoni

Date 12-10-96

Surveyor's Michigan License No. 27457

L7 P.63