

**SURVEY &
REMONUMENTATION**

JAN 19 1999

SECTION

**LAND CORNER RECORDATION CERTIFICATE
Filing Requirement of Act 74, Mich. P.A. 1970**

For corners in

<u>Iron</u> (County)	Located In:	Corner Code #
1. Public Land Survey	T <u>42N</u> R <u>33W</u>	<u>H-3</u>
	T _____ R _____	_____
	T _____ R _____	_____
	T _____ R _____	_____
2. Property Controlling in Section	S _____ T _____ R _____	_____
	S _____ T _____ R _____	_____
3. Miscellaneous Property in Sec.	S _____ T _____ R _____	_____
	S _____ T _____ R _____	_____

IRON COUNTY
MICHIGAN
RECEIVED FOR RECORD
98 DEC 28 AM 11:25
L.C. Records: L. T. P. 316
Gary L. Pisoni
REGISTERED LAND SURVEYOR
Register of Deeds Stamp & File Number

4. Lot No. _____, Recorded Plat _____
5. Private Claims _____

Quarter Corner Sections 3 and 10, T42N, R33W

I, Gary L. Pisoni, in a field survey on Dec. 7, 1998 do hereby state that under requirements of P.A. 74, Michigan P.A. of 1970, the corner points mentioned in lines 1 and 2 above were in conformance with regulations and rules therefore as required in the current manual of survey instructions of the United States Department of the Interior, Bureau of Land Management or by a decree of a Court of Law and /or that the corner points mentioned in lines 3, 4 and 5 above were in conformance with the rules of the Michigan Board of Land Surveyors or by a Decree of a Court of Law; established, re-established, monumented, recovered, found as expressed below:

A	B	C	D	E	F	G	H	I	J	K	L	M
1												
2	6		5		4		3		2		1	
3							●					
4	7		8		9		10		11		12	
5												
6	18		17		16		15		14		13	
7												
8	19		20		21		22		23		24	
9												
10	30		29		28		27		26		25	
11												
12	31		32		33		34		35		36	
13												

NOTE: Not more than 2 corners, all in the same town and range, may be recorded on this certificate.

A. Description of original monument and accessories and/or subsequent restoration:
Original corner established in October, 1851 by Guy H. Carleton, U.S. Deputy Surveyor

Original Corner; Wood Post
Original Bearing Trees;
Yellow Birch 12" N 55°E 24 links (15.84 feet)
Cedar 10" S 45°W 15 links (9.90 feet)

PEER GROUP APPROVED
Gary L. Pisoni 12-18-98
COUNTY REPRESENTATIVE

B. Description of corner evidence found and/or method applied in restoring or reestablishing corner:
No evidence of original B.T.s found. Corner located on the West edge of a farm field and the South side of a gas pipeline.
Corner restored by single proportionate measurement methods and on line between the Southeast and Southwest Section corners of Section 3.

Corner record research on file with County Representative.

C. Description of monument for corner and accessories established to perpetuate locating the position of the corner:
At the corner position, set a 3/4" diameter aluminum rod monument, flush with ground surface, 3 feet long with a 3" diameter aluminum cap stamped as follows: Iron County Remonumentation, T42N, R33W, 1/4, S-3, S-10, 1998, RLS 27457 from which I established the following new blazed and scribed bearing trees: (All measurements taken to a nail in side of tree)

Red Maple	16" dbi	S 24°W	71.87 feet
Balsam	5"	S 57°W	33.57 feet
Red Maple	9"	N 58°W	110.49 feet
White Spruce	7"	N 25°E	126.40 feet
Steel sign post		West	0.70 feet

98-39
Signed by *Gary L. Pisoni* Date 12-31-98
Surveyor's Michigan License No. 27457

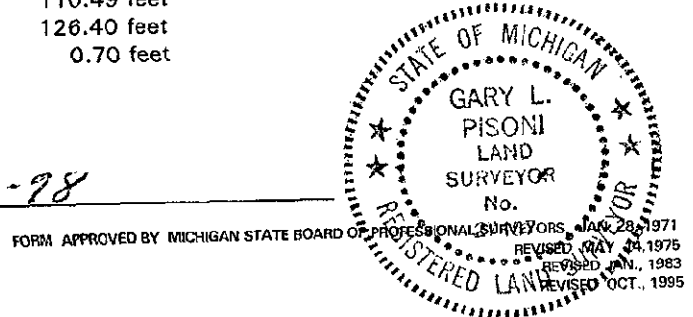

L. T. P. 316