

LAND CORNER RECORDATION CERTIFICATE
Filing Requirement of Act 74, Mich. P.A. 1970 as Amended

For corners in

Iron <small>(County)</small>	Located In:	Corner Code #
1. Public Land Survey	T 42N R 33W	K12
	T _____ R _____	_____
	T _____ R _____	_____
2. Property Controlling in Section	S _____ T _____ R _____	_____
3. Miscellaneous Property in Sec.	S 35 T 42N R 33W	7
	S _____ T _____ R _____	_____
	S _____ T _____ R _____	_____

Register of Deeds Stamp & File Number

4. Lot No. _____, Recorded Plat _____
 5. Private Claims _____

May 06 2004

I, Stephan J. Szyszkoski, in a field survey on _____, 20____ do hereby state that under requirements of P.A. 74, Michigan P.A. of 1970, the corner points mentioned in lines 1 and 2 above were in conformance with regulations and rules therefore as required in the current manual of survey instructions of the United States Department of the Interior, Bureau of Land Management or by a decree of a Court of Law and /or that the corner points mentioned in lines 3, 4 and 5 above were in conformance with the rules of the Michigan Board of Land Surveyors or by a Decree of a Court of Law; established, re-established, monumented, recovered, found as expressed below:

1	A	B	C	D	E	F	G	H	I	J	K	L	M
2	6		5		4		3		2		1		
3													
4	7		8		9		10		11		12		
5													
6	18		17		16		15		14		13		
7													
8	19		20		21		22		23		24		
9													
10	30		29		28		27		26		25		
11													
12	31		32		33		34		35		36		
13													

NOTE: Not more than 2 corners, all in the same town and range, may be recorded on this certificate.

A. Description of original monument and accessories and/or subsequent restoration:

(K12) Quarter corner common to Sections 35-36. Established in 1851 by Guy Carleton: [North] "between Sections 35&36... 40.08 Set quarter post. Yellow Pine 16 N38W 25 links, Yellow Pine 18 S38E 19 links. ...80.16 Set post corner of Sections 25-26-35-36.
 (7-Sec. 35) North 1/16 corner between Sections 35-36. Not established in the original survey.

B. Description of corner evidence found and/or method applied in restoring or reestablishing corner:

(K12) The original post and accessories were not recovered. Reestablished the corner by single proportionate measurement to the original record between Section corners 2628.45' north and south.
 (7-Sec. 35) Established the corner midway and on a straight line between Section corner 1314.22' north and Quarter corner 1314.22' south. Old E-W fence is 4' north.

C. Description of monument for corner and accessories established to perpetuate locating the position of the corner:

(K12) Set 1" IDx32" I.pipe with 4" alum. MDNR cap. Blazed, scribed, and set measuring nails in: 9" Aspen N06E 22.6' "1/4S NBT" 6" Aspen S70E 3.7' do 4" Aspen S19W 11.9' do 4" R.Pine N88W 21.0' do Set sq'd cedar post adjacent. Bearings are magnetic. Distances are to nail with tag.	(7) Set 1" IDx32" I.pipe with 4" alum. MDNR cap. Blazed, scribed, and set measuring nails in: 3" Cherry S04E 42.6' "1/16S BT" 6" Aspen S28W 78.6' do 5" Cherry N77W 30.0' do 7" Aspen N13W 134.2' do Set sq'd cedar post adjacent. Bearings are magnetic. Distances are to nail with tag.
---	--

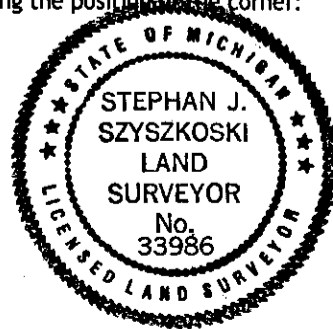

Signed by Stephan J. Szyszkoski
 Surveyor's Michigan License No. 33986

Date 6/24/04