

MAR 09 2000

SECTION

LAND CORNER RECORDATION CERTIFICATE  
Filing Requirement of Act 74, Mich. P.A. 1970

For corners in

| Iron<br>(County)                      | Located In:             | Corner Code # |
|---------------------------------------|-------------------------|---------------|
| 1. Public Land Survey                 | T 43N R 34W             | F-13 ✓        |
|                                       | T 42N R 34W             | F-1 ✓         |
|                                       | T _____ R _____         | _____         |
|                                       | T _____ R _____         | _____         |
| 2. Property Controlling<br>in Section | S _____ T _____ R _____ | _____         |
|                                       | S _____ T _____ R _____ | _____         |
| 3. Miscellaneous<br>Property in Sec.  | S _____ T _____ R _____ | _____         |
|                                       | S _____ T _____ R _____ | _____         |

IRON COUNTY  
MICHIGAN  
RECEIVED FOR RECORD

99 DEC 30 AM 10:26

L.C. Records: L.S.P. 99  
*Gilbert J. Pisoni*  
REGISTERED SURVEYOR

Register of Deeds Stamp & File Number

4. Lot No. \_\_\_\_\_, Recorded Plat \_\_\_\_\_  
5. Private Claims \_\_\_\_\_

Quarter Corner to Section 33, T43N, R34W  
Quarter Corner to Section 4, T42N, R34W

I, Gary L. Pisoni, in a field survey on Oct. 23, 1999 do hereby state that under requirements of P.A. 74, Michigan P.A. of 1970, the corner points mentioned in lines 1 and 2 above were in conformance with regulations and rules therefore as required in the current manual of survey instructions of the United States Department of the Interior, Bureau of Land Management or by a decree of a Court of Law and /or that the corner points mentioned in lines 3, 4 and 5 above were in conformance with the rules of the Michigan Board of Land Surveyors or by a Decree of a Court of Law; established, re-established, monumented, recovered, found as expressed below:

|    | A  | B | C | D  | E | F  | G | H  | I | J  | K | L | M  |
|----|----|---|---|----|---|----|---|----|---|----|---|---|----|
| 1  |    |   |   |    |   | ●  |   |    |   |    |   |   |    |
| 2  | 6  |   |   | 5  |   | 4  |   | 3  |   | 2  |   |   | 1  |
| 3  |    |   |   |    |   |    |   |    |   |    |   |   |    |
| 4  | 7  |   |   | 8  |   | 9  |   | 10 |   | 11 |   |   | 12 |
| 5  |    |   |   |    |   |    |   |    |   |    |   |   |    |
| 6  | 18 |   |   | 17 |   | 16 |   | 15 |   | 14 |   |   | 13 |
| 7  |    |   |   |    |   |    |   |    |   |    |   |   |    |
| 8  | 19 |   |   | 20 |   | 21 |   | 22 |   | 23 |   |   | 24 |
| 9  |    |   |   |    |   |    |   |    |   |    |   |   |    |
| 10 | 30 |   |   | 29 |   | 28 |   | 27 |   | 26 |   |   | 25 |
| 11 |    |   |   |    |   |    |   |    |   |    |   |   |    |
| 12 | 31 |   |   | 32 |   | 33 |   | 34 |   | 35 |   |   | 36 |
| 13 |    |   |   |    |   | ●  |   |    |   |    |   |   |    |

NOTE: Not more than 2 corners, all in the same town and range, may be recorded on this certificate.

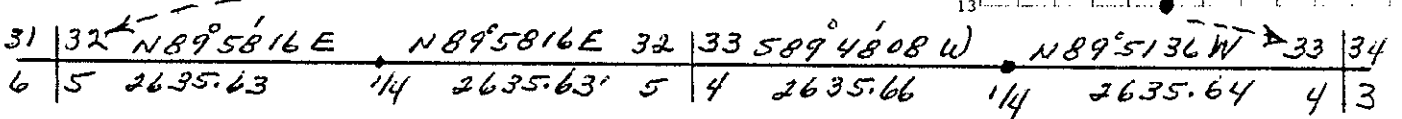

A. Description of original monument and accessories and/or subsequent restoration:

Original corner established on September 8, 1846 by William A. Burt, U.S. Deputy Surveyor.  
Original Corner; Ironwood Post  
Original Bearing Trees:  
Yellow Birch 7" N 32° E 25 lks (16.50 feet)  
Sugar 5" N 53° W 27 lks (17.82 feet)

PEER GROUP APPROVED  
Gary L. Pisoni 12-31-99  
COUNTY REPRESENTATIVE

B. Description of corner evidence found and/or method applied in restoring or reestablishing corner:

No evidence of original B.T.s found.  
Restored the corner position on an old fenceline and midway between the Northeast and Northwest Section corners of Section 4, T42N, R34W. Corner is located 46 feet East of a fenceline which runs North and South.  
Corner record research on file with County Representative.

C. Description of monument for corner and accessories established to perpetuate locating the position of the corner:

At the corner position, set a 5/8" diameter by 30" long rebar with a 3" diameter aluminum cap stamped as follows: Iron County Remonumentation, T43N, R34W, 1/4, S-33, S-4, T42N, 1999, RLS 27457 from which I established the following new blazed and scribed bearing trees: (All measurements taken to a nail in side of tree)

|                 |     |               |            |
|-----------------|-----|---------------|------------|
| Sugar Maple     | 12" | N 75° E       | 39.17 feet |
| Sugar Maple     | 11" | S 39° E       | 34.02 feet |
| Sugar Maple     | 12" | S 59° W       | 14.84 feet |
| Steel sign post |     | N 58° E       | 0.7 feet   |
| Roof Bolt       |     | S 69° 51'53"W | 46.56 feet |

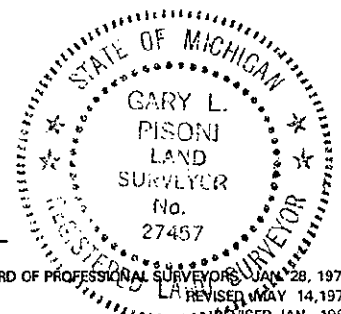

99-97  
Signed by Gary L. Pisoni Date 12-28-99  
Surveyor's Michigan License No. 27457