

1993

COMMISSION

LAND CORNER RECORDATION CERTIFICATE
Filing Requirement of Act 74, Mich. P.A. 1970

For corners in

<u>Iron</u> (County)	Located In:	Corner Code #
1. Public Land Survey	T <u>42N</u> R <u>34W</u>	<u>G-3</u>
	T _____ R _____	_____
	T _____ R _____	_____
	T _____ R _____	_____
2. Property Controlling in Section	S _____ T _____ R _____	_____
	S _____ T _____ R _____	_____
3. Miscellaneous Property in Sec.	S _____ T _____ R _____	_____
	S _____ T _____ R _____	_____
4. Lot No. _____, Recorded Plat _____		
5. Private Claims _____		

IRON COUNTY
MICHIGAN
RECEIVED FOR RECORD
IRON COUNTY
MICHIGAN
93 DEC 29 PM 2:20
RECEIVED FOR RECORD
93 DEC 29 PM 2:20
Giles & Gibbs
REGISTER OF DEEDS
Giles & Gibbs
REGISTER OF DEEDS
93 DEC. 29 PM 2:20
L.C. RECORDS L. 6 P. 293

Register of Deeds Stamp & File Number

Section Corner 3-4-9-10 T42N R34W

I, Gary L. Pisoni, in a field survey on December 20, 1993 do hereby certify that under requirements of P.A. 74, Michigan P.A. of 1970, the corner points mentioned in lines 1 and 2 above were in conformance with regulations and rules therefore as required in the current manual of survey instructions of the United States Department of the Interior, Bureau of Land Management or by a decree of a Court of Law and/or that the corner points mentioned in lines 3, 4 and 5 above were in conformance with the rules of the Michigan Board of Land Surveyors or by a Decree of a Court of Law; established, re-established, monumented, re-monumented, recovered, found as expressed below:

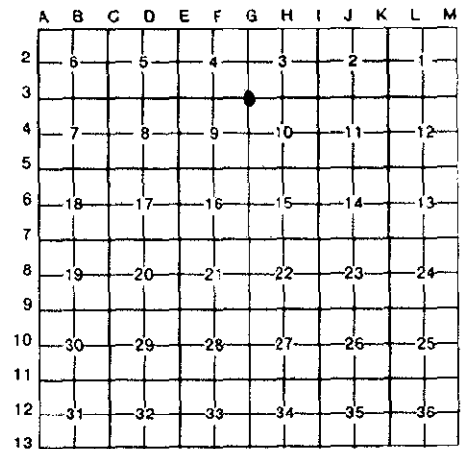

NOTE: Not more than 4 corners, all in the same town and range, may be recorded on this certificate.

A. Description of original monument and accessories and/or subsequent restoration:

Original corner established by Guy H. Carleton, U.S. Deputy Surveyor in 1851.

Original corner: Wood Post

Original bearing trees:

Hemlock	20"	N 75° W	25 links (16.50 feet)
Maple	10"	N 20° E	23 links (15.18 feet)

B. Description of corner evidence found and/or method applied in restoring or reestablishing corner:

No evidence of original corner or bearing tree remains. Corner position found marked by a 1 1/4" X 38" iron pipe. Corner position has been used and accepted as the corner locally, for many years. Layed iron pipe next to aluminum monument as described below. Monument is 3" above ground surface.

This corner is accepted as the best available evidence of the position of the original corner.

C. Description of monument for corner and accessories established to perpetuate locating the position of the corner:

At the corner position, I set a 2" diameter by 30" long split base aluminum pipe monument with a 3" cast aluminum cap, stamped to read: Iron County Remonumentation, T42N, R34W, S-4, S-3, S-9, S-10, 1993, RLS 27457 from which I established the following new blazed and scribed bearing trees; (all measurements taken to a nail in side of tree)

Hemlock (existing)	12"	N 28° E	31.72 feet
Balsam (existing)	8"	N 73° E	10.50 feet
Balsam (NBT)	8"	S 79° W	19.71 feet
Balsam (NBT)	7"	N 59° W	19.03 feet
Steel Sign Post		North	0.60 feet

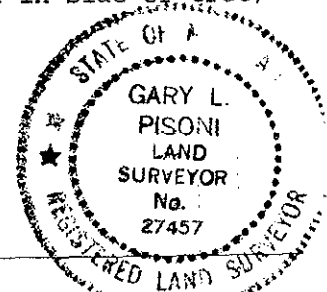

Signed by Gary L. Pisoni

Date 12-28-93

Surveyor's Michigan License No. 27457