

LAND CORNER RECORDATION CERTIFICATE
Filing Requirement of Act 74, Mich. P.A. 1970 as Amended

For corners in

Iron	Located In:	Corner Code #
<small>(County)</small>		
1. Public Land Survey	T <u>42N</u> R <u>35W</u>	<u>G4</u>
	T <u>42N</u> R <u>35W</u>	<u>F5</u>
	T _____ R _____	_____
	S _____ T _____ R _____	_____
2. Property Controlling in Section	S _____ T _____ R _____	_____
	S _____ T _____ R _____	_____
3. Miscellaneous Property in Sec.	S _____ T _____ R _____	_____
	S _____ T _____ R _____	_____
4. Lot No. _____, Recorded Plat _____		
5. Private Claims		

Register of Deeds Stamp & File Number

A	B	C	D	E	F	G	H	I	J	K	L	M
1												
2	6	5	4	3	2	1						
3												
4	7	8	9	10	11	12						
5												
6	18	17	16	15	14	13						
7												
8	19	20	21	22	23	24						
9												
10	30	29	28	27	26	25						
11												
12	31	32	33	34	35	36						
13												

Nov 14 2005

I, Stephan J. Szyszkoski, in a field survey on _____, 20____ do hereby state that under requirements of P.A. 74, Michigan P.A. of 1970, the corner points mentioned in lines 1 and 2 above were in conformance with regulations and rules therefor as required in the current manual of survey instructions of the United States Department of the Interior, Bureau of Land Management or by a decree of a Court of Law and /or that the corner points mentioned in lines 3, 4 and 5 above were in conformance with the rules of the Michigan Board of Land Surveyors or by a Decree of a Court of Law; established, re-established, monumented, recovered, found as expressed below:

NOTE: Not more than 2 corners, all in the same town and range, may be recorded on this certificate.

A. Description of original monument and accessories and/or subsequent restoration:

(G4) Quarter corner common to Sections 9-10. 1851 - Established by Harvey Mellen, Deputy Surveyor: S9'E between Sections 9 & 10 ... 40.00 Set post quarter corner. Lynn 14 N33W 13 links, Sugar 7 S82E 26 links. ... 80.00 Set post cor. of Sections 9-10-15-16.
 (F5) Quarter corner common to Sections 9-16. 1851 - Established by Harvey Mellen, Deputy Surveyor: N89 deg. 48'N corrected between 9 & 16 ... 40.04 Set post qr. Section corner. Sugar 10 N45E 21, Sugar 10 S53E 30. ... 80.08 Section corner.

B. Description of corner evidence found and/or method applied in restoring or reestablishing corner:

(G4) The original post and accessories were not recovered. Reestablished the corner at the intersection of old fence lines North, South, and East. An adjacent land owner in Section 10, Mr. Leonard Wurzel, stated that the original fence along the E-W 1/4 line in that section was constructed prior to 1929 and has always been accepted as the property line. This fence is still in place and appears to have been improved from time to time over the years. My measurements show that the fence runs quite straight from the reestablished corner herein described to the monumented 1/4 corner common to Sections 10 and 11. The reestablished G4 is 6.9' west of a straight line between G3 and G5 and is 31.9' south of point midway between same. I accept the fence intersection as the best available evidence of the position of the original corner.
 (F5) The original post and accessories were not recovered. Found no acceptable evidence of the position of the original corner on the ground. Reestablished the corner by single proportionate measurement to the original record between monumented Section corners 2652.50' east and west.

C. Description of monument for corner and accessories established to perpetuate locating the position of the corner:

(G4) Set 1"IDx32" I.pipe with 4" alum. MDNR cap in fence intersection. Set measuring nails in: 6" Maple S81E 28.4' mrkd "1/4S NBT" 5" Sugar S39E 16.5' do 8" twin Maple S17W 18.4' do 5" Elm N34W 60.6' do a metal fence post is adjacent. Bearings are magnetic. Distances are to nail with tag.	(F5) Set 1"IDx32" I.pipe with 4" alum. MDNR cap. Set measuring nails in: 8" Sugar N57E 26.2' mrkd "1/4S NBT" 7" Sugar S06W 8.4' do 8" Sugar West 9.9' do 6" Sugar N01W 9.7' do Set sq'd sugar post adjacent. Bearings are magnetic. Distances are to nail with tag.
--	---

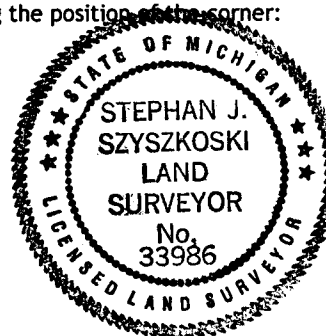

Signed by Stephan J. Szyszkoski
 Surveyor's Michigan License No. 33986

Date 12/19/05