

FEB 22 1996

COMMISSION

LAND CORNER RECORDATION CERTIFICATE  
Filing Requirement of Act 74, Mich. P.A. 1970

For corners in  
Iron  
(County)

Located In:

Corner Code #

- 1. Public Land Survey Section 7 T 43N R 32W  
T 43N R 33W  
T \_\_\_\_\_ R \_\_\_\_\_  
T \_\_\_\_\_ R \_\_\_\_\_
- 2. Property Controlling S \_\_\_\_\_ T \_\_\_\_\_ R \_\_\_\_\_  
in Section S \_\_\_\_\_ T \_\_\_\_\_ R \_\_\_\_\_
- 3. Miscellaneous S \_\_\_\_\_ T \_\_\_\_\_ R \_\_\_\_\_  
Property in Sec. S \_\_\_\_\_ T \_\_\_\_\_ R \_\_\_\_\_

A-3  
M-3

IRON COUNTY  
MICHIGAN  
RECEIVED FOR RECORD

95 JAN 17 AM 8:42  
L.C. RECORDS L.6 P. 326

*Silvia Stiles*  
REGISTER OF DEEDS

Register of Deeds Stamp & File Number

- 4. Lot No. \_\_\_\_\_, Recorded Plat \_\_\_\_\_
- 5. Private Claims \_\_\_\_\_  
NW Section 7

I, John R. Garske, in a field survey on November 1, 1994, do hereby certify that under requirements of P.A. 74; Michigan P.A. of 1970, the corner points mentioned in lines 1 and 2 above were in conformance with regulations and rules theretofore as required in the current manual of survey instructions of the United States Department of the Interior, Bureau of Land Management or by a decree of a Court of Law and/or that the corner points mentioned in lines 3, 4 and 5 above were in conformance with the rules of the Michigan Board of Land Surveyors or by a Decree of a Court of Law; established, re-established, monumented, re-monumented, recovered, found as expressed below:

NOTE: Not more than 4 corners, all in the same town and range, may be recorded on this certificate.

	A	B	C	D	E	F	G	H	I	J	K	L	M
2	6	5	4	3	2	1							
3													
4	7	8	9	10	11	12							
5													
6	16	17	18	19	20	21	22	23	24	25	26	27	28
7													
8	19	20	21	22	23	24	25	26	27	28	29	30	31
9													
10	30	31	32	33	34	35	36	37	38	39	40	41	42
11													
12	31	32	33	34	35	36	37	38	39	40	41	42	43
13													

A. Description of original monument and accessories and/or subsequent restoration:

1846 - Township Boundary by Austin Burt. Original bearing trees: Maple 12" - S43°W, 16; Do 7" - N45°E, 19. Fir 10" - S45°E, 42.

1969 - MDOT construction plans show a 1" iron pipe found, witnesses to corner position: 4" poplar - S20°E, 6.59 feet; 8" poplar - N80°E, 15.00 feet; 6" poplar - N75°W, 24.63 feet.

3. Description of corner evidence found and/or method applied in restoring or reestablishing corner:

I found a 1/2" steel pin in a monument box as shown on the 1969-70 MDOT plans for Highway U.S. 141. No remains of the MDOT bearing trees could be found but the iron pin checks with distances shown to the highway centerline and distances to found corners shown on the plans north and south. I am accepting this corner position as the best available evidence.

County Record Reserch and field search forms on file with the County Representative. See sketch in L.6 P.325 of Land Corner Records.

PEER GROUP APPROVED

*Iron* *Henry J. Pascoe*  
COUNTY REPRESENTATIVE  
A.P. 12-15-94

Description of monument for corner and accessories established to perpetuate locating the position of the corner:

Set standard Iron County aluminum monument consisting of a 2 1/2" diameter x 30" long aluminum pipe with a 3 1/4" diameter stamped cap at corner location, removed monument box, and established the following references: centerline U.S. 141 east, 69.5 feet; found 8" oak - S86°E, 158.91 feet; found 17" spruce - S51°E, 146.18 feet; chiseled "X" in R/W post - N88°W, 31.51 feet; steel sign post - west, 1.54 feet.

igned by John R. Garske  
urveyor's Michigan License No. 28410

Date 12/15/94 No. 28410

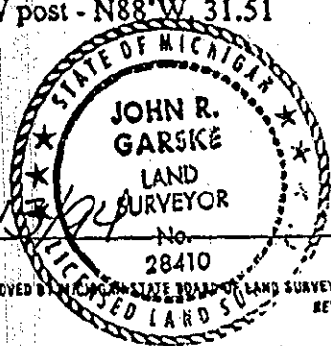

LIBER 6 PAGE 326 A-3