

SURVEY & REMONUMENTATION

JAN 19 1999

SECTION

LAND CORNER RECORDATION CERTIFICATE
Filing Requirement of Act 74, Mich. P.A. 1970

For corners in

<u>Iron</u> (County)	Located In:	Corner Code #
1. Public Land Survey	T <u>43N</u> R <u>32W</u>	<u>C-11</u>
	T _____ R _____	_____
	T _____ R _____	_____
	T _____ R _____	_____
2. Property Controlling in Section	S _____ T _____ R _____	_____
	S _____ T _____ R _____	_____
3. Miscellaneous Property in Sec.	S _____ T _____ R _____	_____
	S _____ T _____ R _____	_____

IRON COUNTY MICHIGAN
RECEIVED FOR RECORD
98 DEC 28 AM 11:24
L.C. Register L. T. P. 310
[Signature]
Register of Deeds Stamp & File Number

4. Lot No. _____, Recorded Plat _____
5. Private Claims _____

Section Corner Sections 30, 29, 31, 32, T43N, R32W

I, Gary L. Pisoni, in a field survey on Dec. 14, 1998 do hereby state that under requirements of P.A. 74, Michigan P.A. of 1970, the corner points mentioned in lines 1 and 2 above were in conformance with regulations and rules therefore as required in the current manual of survey instructions of the United States Department of the Interior, Bureau of Land Management or by a decree of a Court of Law and/or that the corner points mentioned in lines 3, 4 and 5 above were in conformance with the rules of the Michigan Board of Land Surveyors or by a Decree of a Court of Law; established, re-established, monumented, recovered, found as expressed below:

	A	B	C	D	E	F	G	H	I	J	K	L	M
1													
2		6		5		4		3		2		1	
3													
4		7		8		9		10		11		12	
5													
6		18		17		16		15		14		13	
7													
8		19		20		21		22		23		24	
9													
10		30		29		28		27		26		25	
11													
12		31		32		33		34		35		36	
13													

NOTE: Not more than 2 corners, all in the same town and range, may be recorded on this certificate.

A. Description of original monument and accessories and/or subsequent restoration:

Original corner established on August 9, 1849 by Zelotes B. Searls, U.S. Deputy Surveyor.
Original Corner: Sugar Wood Post
Original Bearing Trees:

Sugar	24"	S 69° W	27 lks (17.82 feet)
Sugar	20"	N 33° E	29 lks (19.14 feet)

PEER GROUP APPROVED
Iron A. Pisoni 12-18-98
COUNTY REPRESENTATIVE

In 1995, Gary L. Pisoni RLS restored the corner position at the intersection of an East/West rock fence line with an old fence line running North. Corner falls on the North edge of a large rock fence line, set a 5/8" x 30" long rebar pin as a witness corner on line between the Southeast corner of Section 30 and the East quarter corner of Section 30, said pin bears, N 00° 14' 57" W, 5.60 feet from the SE corner of Section 30. No bearing trees set.

B. Description of corner evidence found and/or method applied in restoring or reestablishing corner:

No evidence of original B.T.s found. Found rebar pin as described above and I accept the rebar pin as the best available evidence for restoring the corner position.

Distances to adjoining corners are consistent with GLO distances.

Corner record research on file with County Representative.

C. Description of monument for corner and accessories established to perpetuate locating the position of the corner:

From the above described corner position, set a 3" diameter aluminum cap over the top of the existing rebar pin (witness corner) and stamped as follows: Iron County Remonumentation, T43N, R32W, W.C., S-30, S-29, S-31, S-32, S 00° 14' 57" E, 5.60 feet, 1998, RLS 27457 from which I established the following new blazed and scribed bearing trees: (All measurements taken to a nail in side of tree, bearings are referenced to the W.C.)

Sugar Maple	11"	S 84° W	10.80 feet
Sugar Maple	8"	N 35° W	11.81 feet
Sugar Maple	9"	N 28° E	23.93 feet
Sugar Maple	13"	N 80° E	15.70 feet
Steel sign post		North	2.1 feet
Section Corner (not monumented)		S 00° 14' 57" E	5.60 feet

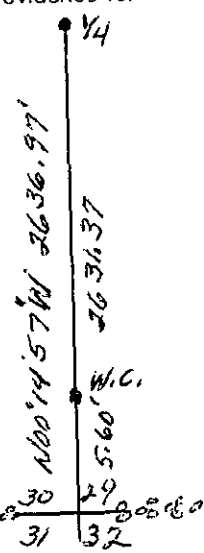

98-9
Signed by Gary L. Pisoni Date 12-21-98
Surveyor's Michigan License No. 27457

FORM APPROVED BY MICHIGAN STATE BOARD OF PROFESSIONAL SURVEYORS, JAN. 28, 1971
REVISED MAY 14, 1975
REVISED JAN. 1983
REVISED OCT., 1995

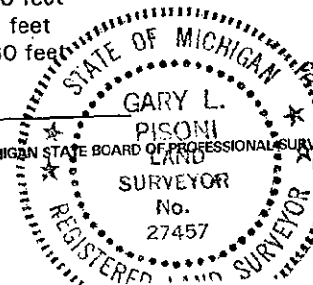

L. T. P. 310