

SURVEY & REMONUMENTATION

APR 27 1995

COMMISSION

LAND CORNER RECORDATION CERTIFICATE
Filing Requirement of Act 74, Mich. P.A. 1970

IRON COUNTY
MICHIGAN
RECEIVED FOR RECORD

For corners in

IRON
(County)

Located in:

Corner Code #

1. Public Land Survey	T	<u>43N</u>	R	<u>33W</u>	<u>C-13</u>
	T		R		
	T	<u>42N</u>	R	<u>33W</u>	<u>C-1</u>
	T		R		
2. Property Controlling in Section	S		T	R	
	S		T	R	
3. Miscellaneous Property in Sec.	S		T	R	
	S		T	R	

95 FEB 10 PM 3:27
L.C. RECORDS 2.6 P. 349
Robert Stiles
REGISTER OF DEEDS

Register of Deeds Stamp & File Number

4. Lot No. _____, Recorded Plat _____
5. Private Claims _____

	A	B	C	D	E	F	G	H	I	J	K	L	M
2	6		5		4		3		2		1		
3													
4	7		8		9		10		11		12		
5													
6	18		17		16		15		14		13		
7													
8	19		20		21		22		23		24		
9													
10	30		29		28		27		26		25		
11													
12	31		32		33		34		35		36		
13													

I, Alan K. Pierce, in a field survey on December, 1994, do hereby certify that under requirements of P.A. 74, Michigan P.A. of 1970, the corner points mentioned in lines 1 and 2 above were in conformance with regulations and rules therefore as required in the current manual of survey instructions of the United States Department of the Interior, Bureau of Land Management or by a decree of a Court of Law and/or that the corner points mentioned in lines 3, 4 and 5 above were in conformance with the rules of the Michigan Board of Land Surveyors or by a Decree of a Court of Law; established, re-established, monumented, re-monumented, recovered, found as expressed below:

NOTE: Not more than 4 corners, all in the same town and range, may be recorded on this certificate.

A. Description of original monument and accessories and/or subsequent restoration:

C-1/13: Corner to Sections 5, 6, 31 and 32 T42/43N-R33W.

1846: Austin Burt set a White Pine post during establishment of Township line T42/43N and established the following witnesses: 6" Aspen N57-1/2°E, 25L.; 10' Fir N59°W 53L.

1851: Guy Carleton recovered original post during subdivision of T42N-R33W and established the following witnesses: 10' Fir S35°W 30L.; 9' Fir S55°E 54L.

1983: Corner shown on a Certificate of Survey recorded in Liber 218, Page 164 by R.L.S. No. 27457. Corner was not recorded. Subsequent furnished witnesses are 12" Yellow Birch S64°W 18.37'; 5" Balsam N55°W 16.60'. Note indicates a flat iron bar was replaced with a rebar.

B. Description of corner evidence found and/or method applied in restoring or reestablishing corner:

C-1/13: 1994, E C I: Found 3/4" iron pin and flat iron bar in rock pile. Also recovered 1983 witnesses both scribed "BT" in butt blaze. No original corner evidence recovered. The following measurements were noted to G.L.O. terrain calls: "Top of Ridge - E' 132' G.L.O. - 133' E C I; "Begin to descend hill - N' 594' G.L.O. - 215' E C I; "Bottom of hill - N' 693' G.L.O. - 900' E C I. Terrain calls to North are on an extreme oblique angle to section line and give variable results dependent upon interpretation. Corner position established by acceptance of found 3/4" iron pin as a careful and faithful perpetuation of the position of the original corner. Set Iron County Remonumentation monument, a 2" diameter x 30" long aluminium pipe with 3" diameter aluminum cap stamped to identify the corner, about 0.5' above grade, and established witnesses. The found pin and bar were left lying on the ground beside the monument. Distance West to B-1/13 2639.39', distance East to D-1/13 2638.22'.

PEER GROUP APPROVED
Alan K. Pierce
COUNTY REPRESENTATIVE
AP-1-25-95

C. Description of monument for corner and accessories established to perpetuate locating the position of the corner:

Bearing trees are face, nail, and butt blazed and painted yellow. Distances are measured from a 16d double head nail with an orange plastic washer stamped "E C I -33097" in the side of the bearing tree. Face blaze is scribed with an "X". Butt blaze is scribed "BT". Metal sign/tag placed above face blaze.

C-1/13: Set Iron County Remonumentation monument witnessed by:

11" Maple N85°E 27.83'	13" Yellow Birch S58°E 67.20'
14" Yellow Birch S62°W 18.21'	12" Hemlock N66°W 44.39'
Sign Post S87°E 1.95'	

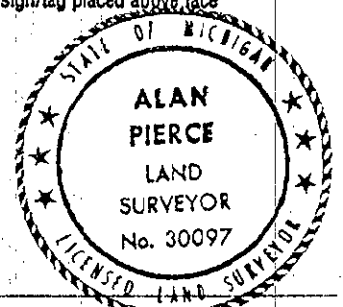

Signed by Alan K. Pierce

Date 1-12-95

Surveyor's Michigan License No. 30097

FORM APPROVED BY MICHIGAN STATE BOARD OF LAND SURVEYORS, JAN. 28, 1971
REVISED MAY 14, 1975
REVISED JAN., 1983