

LAND CORNER RECORDATION CERTIFICATE
Filing Requirement of Act 74, Mich. P.A. 1970

For corners in

Iron (County)	Located In:	Corner Code #
1. Public Land Survey	T ___ R ___	_____
	T ___ R ___	_____
	T ___ R ___	_____
	T ___ R ___	_____
2. Property Controlling in Section	S <u>11</u> T <u>44N</u> R <u>31W</u>	<u>2</u>
	S <u>26</u> T <u>44N</u> R <u>31W</u>	<u>1</u>
3. Miscellaneous Property In Sec.	S ___ T ___ R ___	_____
	S ___ T ___ R ___	_____

Register of Deeds Stamp & File Number

4. Lot No. _____, Recorded Plat _____
5. Private Claims _____

1 Jul 22 1997
2 Sep 22 1997

I, Stephan J. Szyszkoski, in a field survey on _____, 19____ do hereby state that under requirements of P.A. 74, Michigan P.A. of 1970, the corner points mentioned in lines 1 and 2 above were in conformance with regulations and rules therefore as required in the current manual of survey instructions of the United States Department of the Interior, Bureau of Land Management or by a decree of a Court of Law and/or that the corner points mentioned in lines 3, 4 and 5 above were in conformance with the rules of the Michigan Board of Land Surveyors or by a Decree of a Court of Law; established, re-established, monumented, recovered, found as expressed below:

NOTE: Not more than 2 corners, all in the same town and range, may be recorded on this certificate.

	A	B	C	D	E	F	G	H	I	J	K	L	M
1													
2	6	5	4	3	2	1							
3										●			
4	7	8	9	10	11	12							
5													
6	18	17	16	15	14	13							
7													
8	19	20	21	22	23	24							
9										●			
10	30	29	28	27	26	25							
11													
12	31	32	33	34	35	36							
13													

A. Description of original monument and accessories and/or subsequent restoration:

(2-Sec. 11) East 1/16 corner between sections 2-11. Corner not established in the original survey. Ewart Muller, P.S., Iron Mountain related to me that May 1954 notes of his father, Ewart Muller, show that he found post at this corner, probably set by Rudy Johnson, a local timber cruiser. Found no other record.

(1-Sec. 26) West 1/16 corner between Sections 23-26. Corner not established in the original survey. Found no subsequent record.

B. Description of corner evidence found and/or method applied in restoring or reestablishing corner:

(2-Sec. 11) Found no evidence of prior monumentation. The various calls in Muller's 1954 notes could not be made to fit with the conditions as I found them on the ground and so I did not use these notes to reestablish any corners. Established the corner midway and on a straight line between quarter corner 1317.81 feet west and section corner 1317.81 feet east. At the position for the corner, I placed a 1" I.D.x32" iron pipe capped with a 4" dia. cast aluminum MDNR tablet, appropriately stamped. Corner placed and witnessed by D.Lampela and B.Wheeler

(1-Sec. 26) Recovered a 1" dia. iron pipe, set firm and in good condition. Distances east and west to adjacent monumented corners was found to be 1318.95' and 1319.06' respectively. The pipe was found 0.3' north of a straight line between them. Accepted same as a careful and faithful determination of the position of the corner. Left the monument in place and marked new witnesses as described below. Corner re-witnessed by B.Wheeler and D.Lampela, Baraga District Office, MDNR.

C. Description of monument for corner and accessories established to perpetuate locating the position of the corner:

(2) Set 1" iron pipe with 4" MDNR cap.

Blazed and scribed the following:

5" B. Spruce N58E 24.5' 1/16S BT"

20" W. Pine S68E 79.7' 1/16S BT"

9" B. Spruce S04W 81.8' 1/16S BT"

5" B. Spruce S46W 65.5' 1/16S BT"

Placed a squared spruce post adjacent.

Bearings are magnetic

(1) Found 1" dia. iron pipe.

Blazed and scribed the following:

6" Maple clump N77E 5.7' 1/16S BT"

10" W. Pine N11E 28.9' 1/16S BT"

8" Maple S23W 21.9' 1/16S BT"

10" W. Pine N49W 29.9' (slope) do

Placed a squared maple post adjacent.

Bearings are magnetic.

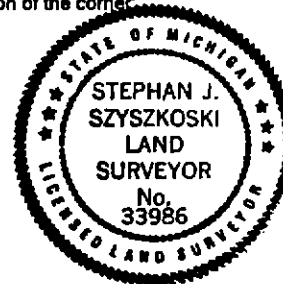

Signed by Stephan J. Szyszkoski
Surveyor's Michigan License No. 33986

Date 11-18-97

For the Michigan Department of Natural Resources - Forest Management Division