

SURVEY & REMONUMENTATION

JAN 13 1998

SECTION

LAND CORNER RECORDATION CERTIFICATE
Filing Requirement of Act 74, Mich. P.A. 1970

IRON COUNTY
MICHIGAN
RECEIVED FOR RECORD

97 DEC 23 PM 1:26

L.C. Records L. 7 P. 132

Gilbert J. Pisoni
REGISTERED DEEDS

For corners in

_____ Iron _____ (County)	Located in:	Corner Code #
1. Public Land Survey	T 44N R 32W	A-9
	T 44N R 33W	M-9
	T _____ R _____	_____
	T _____ R _____	_____
2. Property Controlling in Section	S _____ T _____ R _____	_____
	S _____ T _____ R _____	_____
3. Miscellaneous Property in Sec.	S _____ T _____ R _____	_____
	S _____ T _____ R _____	_____

Register of Deeds Stamp & File Number

4. Lot No. _____, Recorded Plat _____
5. Private Claims _____

Section Corner Sec. 19 and 30, T44N, R32W
Section corner Sec. 24 and 25, T44N, R33W

I, Gary L. Pisoni, in a field survey on November 3, 1997, do hereby state that under requirements of P.A. 74, Michigan P.A. of 1970, the corner points mentioned in lines 1 and 2 above were in conformance with regulations and rules therefore as required in the current manual of survey instructions of the United States Department of the Interior, Bureau of Land Management or by a decree of a Court of Law and /or that the corner points mentioned in lines 3, 4 and 5 above were in conformance with the rules of the Michigan Board of Land Surveyors or by a Decree of a Court of Law; established, re-established, monumented, recovered, found as expressed below:

A	B	C	D	E	F	G	H	I	J	K	L	M
1												
2	6	5	4	3	2	1						
3												
4	7	8	9	10	11	12						
5												
6	18	17	16	15	14	13						
7												
8	19	20	21	22	23	24						
9												
10	30	29	28	27	26	25						
11												
12	31	32	33	34	35	36						
13												

NOTE: Not more than 2 corners, all in the same town and range, may be recorded on this certificate.

A. Description of original monument and accessories and/or subsequent restoration:

Original Corner established in August of 1846 by Austin Burt, U.S. Deputy Surveyor.
Original Corner; Wood Post

Original Bearing Trees;

Yellow Birch	14"	S46°E	55 links (36.30 feet)
Sugar	14"	N68°W	41 links (27.06 feet)

In July of 1849, Zelotes B. Searls, U.S. Deputy Surveyor, made a new bearing tree;

Sugar	18"	N30°E	41 links (27.06 feet)
-------	-----	-------	-----------------------

On 8-17-84, Keith Sackett, RLS with the Michigan Dept. Of Natural Resources, found a 1 1/4 inch diameter iron pipe, 18 inches above ground and located along an old fence line and used as corner for many years. Recorded in Land Corner Certificate L. 5, Page 80, on September 14th, 1984.

1984 Bearing Trees;

Maple	6"	N31°E	28.2 feet
Maple	8"	S45°E	26.1 feet
Y. Birch	9"	S66°W	9.1 feet

B. Description of corner evidence found and/or method applied in restoring or reestablishing corner:

No evidence of original B.T.s found.

On 11-3-97, found iron pipe as found by Keith Sackett in 1984, and the following bearing trees;

Yellow Birch	9"	S70°W	9.26 feet
Maple	8"	N30°E	28.40 feet
Maple	8"	S44°E	26.29 feet

PEER GROUP APPROVED

Gary L. Pisoni 11-11-97
IRON COUNTY REPRESENTATIVE

Corner record research on file with County Representative.

C. Description of monument for corner and accessories established to perpetuate locating the position of the corner:

Inside iron pipe as described above, set a 3/4 outside diameter by 3 foot long aluminum rod monument stamped as follows; Iron County Remonumentation, T44N, R33W, R32W, S24, S19, S25, S30, 1997, RLS 27457. Blazed and scribed the following new bearing trees: (All measurements taken to a nail in side of tree)

Red Maple	7"	N85°E	11.70 feet
Steel Sign Post		S07°W	0.80 feet

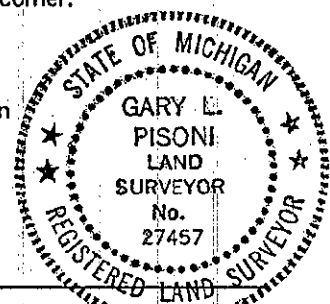

97-17
Signed by Gary L. Pisoni Date November 7, 1997

Surveyor's Michigan License No. 27457