

LAND CORNER RECORDATION CERTIFICATE
Filing Requirement of Act 74, Mich. P.A. 1970

For corners in

Iron

(County)

Located In:

Corner Code #

- | | | |
|------------------------------------|---|-------------|
| 1. Public Land Survey | T <u>44N</u> R <u>33W</u> | <u>L4</u> |
| | T <u> </u> R <u> </u> | <u> </u> |
| | T <u> </u> R <u> </u> | <u> </u> |
| | T <u> </u> R <u> </u> | <u> </u> |
| 2. Property Controlling in Section | S <u>12</u> T <u>44N</u> R <u>33W</u> | <u>9</u> |
| | S <u> </u> T <u> </u> R <u> </u> | <u> </u> |
| 3. Miscellaneous Property in Sec. | S <u> </u> T <u> </u> R <u> </u> | <u> </u> |
| | S <u> </u> T <u> </u> R <u> </u> | <u> </u> |

Register of Deeds Stamp & File Number

4. Lot No. _____, Recorded Plat _____
 5. Private Claims _____

Aug 14 2002

I, Stephan J. Szyszkoski, in a field survey on _____, 20____ do hereby state that under requirements of P.A. 74, Michigan P.A. of 1970, the corner points mentioned in lines 1 and 2 above were in conformance with regulations and rules therefore as required in the current manual of survey instructions of the United States Department of the Interior, Bureau of Land Management or by a decree of a Court of Law and /or that the corner points mentioned in lines 3, 4 and 5 above were in conformance with the rules of the Michigan Board of Land Surveyors or by a Decree of a Court of Law, established, re-established, monumented, recovered, found as expressed below:

NOTE: Not more than 2 corners, all in the same town and range, may be recorded on this certificate.

	A	B	C	D	E	F	G	H	I	J	K	L	M
1													
2		6		5		4		3		2		1	
3													
4		7		8		9		10		11			
5													
6		18		17		16		15		14		13	
7													
8		19		20		21		22		23		24	
9													
10		30		29		28		27		26		25	
11													
12		31		32		33		34		35		36	
13													

- A. Description of original monument and accessories and/or subsequent restoration:**
 (L4) Center of Section 12. Not established in the original survey.
 (9-Sec. 12) East 1/16 corner, Section 12. Not established in the original survey.

- B. Description of corner evidence found and/or method applied in restoring or reestablishing corner:**
 (L4) Established the corner at the intersection of straight lines connecting opposite 1/4 corners. I note that 1/4 corner L3 is a computed position midway and on line between adjacent monumented Section corners and, according to Iron County Remonumentation Program Representative, Gary L. Pisoni PS, will be remonumented at that position during the winter of 2002-2003 to conform to the record position stated in LCRC L8 P299.
 (9-Sec. 12) Established the corner midway and on a straight line between Quarter corner and Center of Section 1320.63' east and west.

- C. Description of monument for corner and accessories established to perpetuate locating the position of the corner:**
- | | |
|--|--|
| (L4) Set 1"IDx32" I.pipe with 4" alum. MDNR cap. Blazed and scribed:
8" W.Birch N05W 2.8' "C1/4 BT"
6" Spruce N61E 25.2' do
5" Spruce S06W 12.7' do
5" Spruce S41W 21.8' do
Set sq'd cedar post adjacent. Bearings are magnetic. Distances are to notch in lower blaze. | (9) Set 1"IDx32" I.pipe with 4" alum. MDNR cap. Blazed and scribed:
5" Spruce N05E 17.3' "1/16S BT"
3" Spruce S27E 52.0' do
3" Poplar S04W 12.3' do
6" Balsam N56W 11.8' do
Set sq'd cedar post adjacent. Bearings are magnetic. Distances are to notch in lower blaze. |
|--|--|

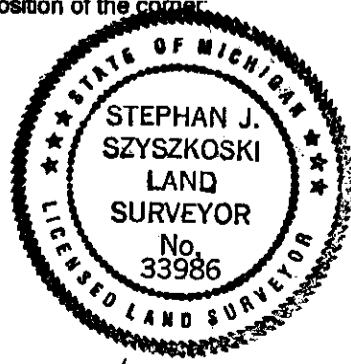

Signed by Stephan J. Szyszkoski Date 8/19/02
 Surveyor's Michigan License No. 33986