

LAND CORNER RECORDATION CERTIFICATE
Filing Requirement of Act 74, Mich. P.A. 1970 as Amended

For corners in

Iron	Located In:	Corner Code #
<small>(County)</small>		
1. Public Land Survey	T <u>45N</u> R <u>34W</u>	<u>I3</u>
	T <u>45N</u> R <u>34W</u>	<u>MC west of K1</u>
	T _____ R _____	_____
	S _____ T _____ R _____	_____
2. Property Controlling in Section	S _____ T _____ R _____	_____
	S _____ T _____ R _____	_____
3. Miscellaneous Property in Sec.	S _____ T _____ R _____	_____
	S _____ T _____ R _____	_____

4. Lot No. _____, Recorded Plat _____
 5. Private Claims

MC May 16 2007
 I3 May 14 2007

I, Stephan J. Szyszkoski, in a field survey on _____, 20____ do hereby state that under requirements of P.A. 74, Michigan P.A. of 1970, the corner points mentioned in lines 1 and 2 above were in conformance with regulations and rules therefore as required in the current manual of survey instructions of the United States Department of the Interior, Bureau of Land Management or by a decree of a Court of Law and /or that the corner points mentioned in lines 3, 4 and 5 above were in conformance with the rules of the Michigan Board of Land Surveyors or by a Decree of a Court of Law; established, re-established, monumented, recovered, found as expressed below:

NOTE: Not more than 2 corners, all in the same town and range, may be recorded on this certificate.

A. Description of original monument and accessories and/or subsequent restoration:

(I3) Corner common to Sections 2-3-10-11. 1851 - Established by Guy Carleton, Deputy Surveyor: Set post. Hemlock 10 N53E 26 links, Sugar 16 S82W 13 links. 1965 - Neal Spherhake RLS notes that this corner is 39.92 chains west of corner J3 (L2-P430).
 (MC west of K1) Meander corner on the Township line between J1 and K1 at the east bank of the "Wide Waters" of the Net River between Sec. 2 T45N-R34W and Sec. 35 T46N-R34W. 1846 - Established by Wm. A. Burt, Deputy Surveyor. Set post 38.92 chains west of the Section corner. Tamarack 14 N83E 77 links, Tamarack 12 N78 1/2E 67 links. Found no subsequent record.

B. Description of corner evidence found and/or method applied in restoring or reestablishing corner:

(I3) The original post and accessories were not recovered. Found a 1.25" ID iron pipe, set firm, 39.898 chains west of corner J3 (40.32 ch. GLO) and conforming fairly well in proportion to GLO record south to I4 (2640.81' M 2659.8 GLO) and west to G3 (5288.92 M 5322.2 GLO). A Northern Paper Mills location poster was found nailed to a nearby moss-covered log, obviously very old. Accepted same as the best available evidence of the position of the original corner.
 (MC west of K1) The original post and accessories were not recovered. Reestablished the corner on the Township line defined by monumented corners at H1 and K1 and at index-corrected record GLO distance west of K1 (38.960 ch. M, 38.92 ch. R). the position for the MC falls in the "Wide Waters" of the Net River and could not be monumented. Established a Witness Corner to the MC, on the Township line, 48.44' east of the position for the Meander Corner. The water's edge is 10' west of the MC.

C. Description of monument for corner and accessories established to perpetuate locating the position of the corner:

(I3) Found 1.25" ID iron pipe. Set measuring nails in:	(MC) Set 1"IDx32" I.pipe with 4" alum. MDNR cap for a Witness Corner 48.44' east of the corner position. Set a squared spruce post 1.2' Westerly. No witness trees available.
7" Poplar S88E 4.6' mrdk "S11 NBT"	
7" Maple S21W 33.2' "S10 NBT"	
9" Maple S78W 40.4' "S10 NBT"	
5" Sugar N18W 3.8' "S3 NBT"	

Bearings are magnetic. Distances are to nail with tag.

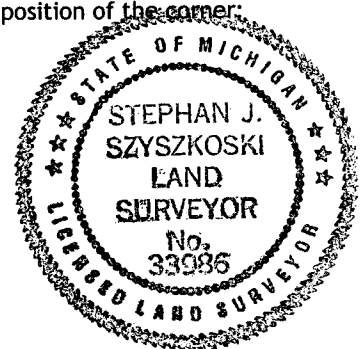

Register of Deeds Stamp & File Number

	A	B	C	D	E	F	G	H	I	J	K	L	M
1													
2	6		5		4		3		2		1		
3													
4	7		8		9		10		11		12		
5													
6	18		17		16		15		14		13		
7													
8	19		20		21		22		23		24		
9													
10	30		29		28		27		26		25		
11													
12	31		32		33		34		35		36		
13													

Signed by Stephan J. Szyszkoski
 Surveyor's Michigan License No. 33986

Date 5/31/07