

**SURVEY &
REMONUMENTATION**

FORM NO. 985-A



Stock No. 26273

MAR 19 1997

COMMISSION

**LAND CORNER RECORDATION CERTIFICATE
Filing Requirement of Act 74, Mich. P.A. 1970**

IRON COUNTY
MICHIGAN
RECEIVED FOR RECORD

96 DEC 23 AM 8:58
L. P. Records L. 7, P. 31
Gail...
REGISTER OF DEEDS

Register of Deeds Stamp & File Number

For corners in

Iron
(County)

Located In:

Corner Code #

1. Public Land Survey

~~T 46N R 34W~~ M-10
T 46N R 34W A-10

2. Property Controlling
in Section

S T R

3. Miscellaneous
Property in Sec.

S T R
S T R

4. Lot No. _____, Recorded Plat _____

5. Private Claims _____

Quarter Corner S.25, T46N R35W, S.30, T46N R34W

I, Gary L. Pisoni, in a field survey on October 11, 1996 do hereby state that under requirements of P.A. 74, Michigan P.A. of 1970, the corner points mentioned in lines 1 and 2 above were in conformance with regulations and rules therefore as required in the current manual of survey instructions of the United States Department of the interior, Bureau of Land Management or by a decree of a Court of Law and/or that the corner points mentioned in lines 3, 4 and 5 above were in conformance with the rules of the Michigan Board of Land Surveyors or by a Decree of a Court of Law; established, re-established, monumented; recovered, found as expressed below:

NOTE: Not more than 2 corners, all in the same town and range, may be recorded on this certificate.

	A	B	C	D	E	F	G	H	I	J	K	L	M
1													
2		6		5		4		3		2		1	
3													
4		7		8		9		10		11		12	
5													
6		18		17		16		15		14		13	
7													
8		19		20		21		22		23		24	
9													
10		30		29		28		27		26		25	
11													
12		31		32		33		34		35		36	
13													

A. Description of original monument and accessories and/or subsequent restoration:

Original corner established by William Burt, U.S. Deputy Surveyor on September 21, 1846.

Original corner: Sugar Post

Original bearing trees:

Hemlock 4" S 57° E 5 links (3.30 feet)
Maple 14" N 49° W 38 links (25.08 feet)

In 1965, Donald D. Lappata, R.L.S., set a 2" dia. X 5 feet long, concrete filled galvanized iron pipe with brass tablet from evidence from original bearing trees as described above.

Recorded in Land Corner Certificate L. 3, Page 202 on June 1, 1966.

1965 Bearing trees:

Yellow Birch 3" N 63° W 15.8 feet
Sugar Maple 3" N 80° E 27.0 feet
Yellow Birch 5" S 45° W 14.2 feet

B. Description of corner evidence found and/or method applied in restoring or reestablishing corner:

Found the monument and bearing trees as described above.

Yellow Birch 9" N 67° W 15.82 feet
Sugar Maple 7" N 82° E 14.22 feet
Yellow Birch 8" S 43° W 27.06 feet
Wood Sign Post N 85° W 3.10 feet

Corner Record Research on file with County Representative.

C. Description of monument for corner and accessories established to perpetuate locating the position of the corner:

From the above described brass capped monument, I established the following new blazed and scribed bearing tree: (all measurements taken to a nail in side of tree)

Sugar Maple 7" N 31° E 12.61 feet
Steel Sign Post 6' S 75° W 0.90 feet

PEER GROUP APPROVED
Iron Gary L. Pisoni 12-11-96
COUNTY REPRESENTATIVE

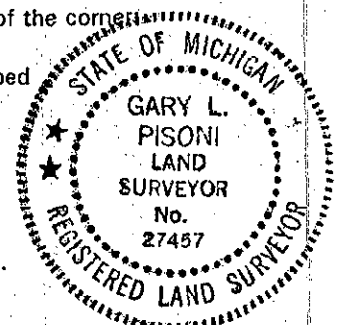

#96-09

Signed by Gary L. Pisoni

Date 12-10-96

Surveyor's Michigan License No. 27457

FORM APPROVED BY MICHIGAN STATE BOARD OF PROFESSIONAL SURVEYORS, JAN. 28, 1971
REVISED MAY 14, 1975
REVISED JAN., 1983
REVISED OCT., 1995

L. 7 P. 31