

MAR 19 1999

133.14

LAND CORNER RECORDATION CERTIFICATE
Filing Requirement of Act 74, Mich. P.A. 1970
Isabella County Remonumentation

SECTION

For corners in

Isabella (County) Located In: Corner Code #
1. Public Land Survey T13 N R 6W H-4
2. Property Controlling in Section S T R
3. Miscellaneous Property in Sec. S T R
4. Lot No. , Recorded Plat
5. Private Claims

9800013344
Filed for Record in
ISABELLA COUNTY, MI
SHARON A BROWN
On 12-30-1998 At 10:28:45 am.
RE LAND COR 9.00
OR Liber 1 Page 261 - 261

Register of Deeds Stamp & File Number

Grid table with columns A-M and rows 2-13. A dot is marked at the intersection of column G and row 4.

I, Timothy E Bebee, in a field survey on December 1, 19 98, do hereby state that under requirements of P.A. 74, Michigan P.A. of 1970, the corner points mentioned in lines 1 and 2 above were in conformance with regulations and rules therefore as required in the current manual of survey instructions of the United States Department of the Interior, Bureau of Land Management or by a decree of a Court of Law and/or that the corner points mentioned in lines 3, 4 and 5 above were in conformance with the rules of the Michigan Board of Land Surveyors or by a Decree of a Court of Law; established, re-established, monumented, recovered, found as expressed below:

NOTE: Not more than 2 corners, all in the same town and range, may be recorded on this certificate.

A. Description of original monument and accessories and/or subsequent restoration

- Corner not set by GLO
No date J. Graham CS.....tamarack stake 3"
1992 G. Gray unrecorded survey.....set 1/2" iron rod & cap at intersection of four way fence lines
1993 G. Gray LCRC 1220.....set 1/2" iron rod & cap at intersection of four way fence lines
1994 G. Gray unrecorded survey.....1/2" iron rod & cap at intersection of four way fence lines
1995 G. Gray unrecorded survey.....found 1/2" iron rod & cap at intersection of four way fence lines

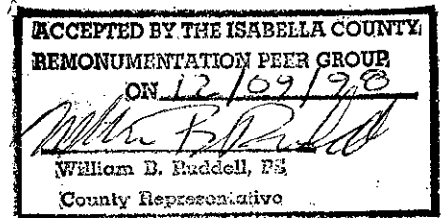

B. Description of corner evidence found and/or method applied in restoring or reestablishing corner:

Found 1/2" capped iron at extension of four way fence lines as set in LCRC 1220. Old broken down fence lines to North and East. Newer intact fence running South and West. Corner falls in lane running Northwest to Southeast. Corner as set is within 0.53' of the recorded county survey distance to G-4, 1.14' to H-5, and 6.97' to I-4. Although, the distance to I-4 is 6.97' long a 6"x12" pointed stone found at the east 1/8 line, and accepted as the 1/8 cor, is 1.46' South of a line from the H-4 to the I-4, and is also within 0.04' of being midway between H-4 and I-4.

C. Description of monument for corner and accessories established to perpetuate locating the position of the corner:
A Remonumentation monument stamped #17741, placed inside a monument box, was set at the position of the corner and is accepted as the best evidence of the perpetuated corner.

Witnesses:

- N 36° E 54.98' nail in 8" cherry
N 42° E 33.08' nail & blaze in 12" dead tree (very old)
S 06° E 36.48' nail in fence post
S 84° W 14.10' nail in fence post
S 60° W 36.48' nail in 8" cherry

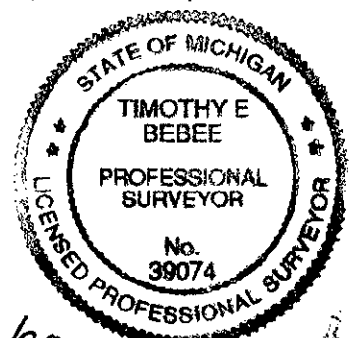

Signed by Timothy E Bebee Date 12/29/98
Surveyor's Michigan License No. 39074