

SURVEY &
REMONUMENTATION
852 16
MAR 1 6 1994
COMMISSION

LAND CORNER RECORDATION CERTIFICATE
Filing Requirement of Act 74, Mich. P.A. 1970
REMONUMENTATION

STATE OF MICHIGAN
COUNTY OF ISABELLA
RECEIVED
Nov 30 11 32 AM '93
000005
Helen L. Elmore
REGISTER OF DEEDS

For corners in Isabella
(County)

Located in: Corner Code #

1. Public Land Survey T 14N R 3W
T _____ R _____
T _____ R _____
T _____ R _____
2. Property Controlling S _____ T _____ R _____
in Section S _____ T _____ R _____
3. Miscellaneous S _____ T _____ R _____
Property in Sec. S _____ T _____ R _____
4. Lot No. _____, Recorded Plat _____
5. Private Claims _____

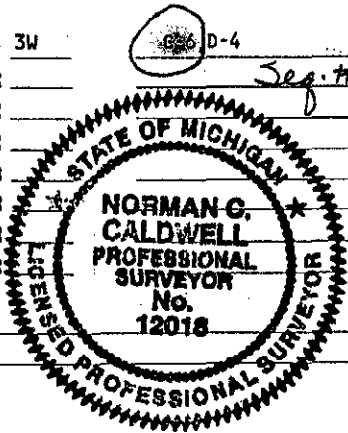

Register of Deeds Stamp & File Number

	A	B	C	D	E	F	G	H	I	J	K	L	M
2	6		5	4	3	2	1						
3													
4	7			●	9	10	11	12					
5													
6	18		●	17	16	15	14	13					
7													
8	19		20	21	22	23	24						
9													
10	30		29	28	27	26	25						
11													
12	31		32	33	34	35	36						
13													

I, Norman C. Caldwell, in a field survey on July, 19 93, do hereby certify that under requirements of P.A. 74, Michigan P.A. of 1970, the corner points mentioned in lines 1 and 2 above were in conformance with regulations and rules therefore as required in the current manual of survey instructions of the United States Department of the Interior, Bureau of Land Management or by a decree of a Court of Law and/or that the corner points mentioned in lines 3, 4 and 5 above were in conformance with the rules of the Michigan Board of Land Surveyors or by a Decree of a Court of Law; established, re-established, monumented, re-monumented, recovered, found as expressed below:

NOTE: Not more than 4 corners, all in the same town and range, may be recorded on this certificate.

A. Description of original monument and accessories and/or subsequent restoration:

(C-6) 1/4 Cor., Sec. 17 & 18, T14N-R3W

Wood pst placed by Joel Whight in 1832 Sub. Twp.: N82°E 23L. (4.627M) 6" (15cm) Beech; S55°W 38L. (7.644M) 14" (35.5cm) Beech.

L.C.R.C. by D. South, Rec in Bk. 1 P. 169, Fnd 20mm Iron in Mon. Box per L. 1 P. 96; SW 19.218M N&C in P.P.; NW 16.377M N&C in P.P.; NE 20.086M N&C in 76cm tree; N89°58'02"E 1607.110M E-6; S0°00'00"E 809.611M C-7

L.C.R.C. by W. Ruddell, Rec. in Bk. 1 P. 187, Bk. 2 P. 508, 546, & 547. Fnd 20mm reinforcement rod in Mon. Box: SW 19.218M N&T in P.P.; NW 16.362M N&T in P.P.; NE 20.004M N&T in 76cm tree

L.C.R.C. by W. Ruddell, rec in Bk. 3 P. 858, Fnd rod in Mon. Box: NW 16.395M N&C in P.P.; SSW 19.035M in P.P.; NE 20.06M CL 91.4cm Elm

L.C.R.C. by J. Radcliffe, rec. in Bk. 1 P. 275, Fnd. Mon. Box in B.T.: N45°E 20.220M Chinese Elm; S20°W 14.667M Fnc pst; S45°W 18.325M P.P.

Surveys by: Courtright L. 1 P. 18 & 20, Ruddell L. 1 P. 96, L. 3 P. 292 L. 5 P. 81 & 119, 128 & 161, Fluharty L. 4 P. 78, County Survey book 4, P. 98 & 148

(D-4) Center 1/4 Cor., Sec. 8, T14N-R3W

This position not established by original government survey.

(No Subsequent Record)

B. Description of corner evidence found and/or method applied in restoring or reestablishing corner:

(C-6) 1/4 Cor., Sec. 17 & 18, T14N-R3W

Found 13mm Iron Rod in Mon. Box per Bk. 1 P. 96, 169, 187 and 275; Bk. 2 P. 508, 546, & 547; and Bk. 3 P. 858

(D-4) Center 1/4 Cor., Sec. 8, T14N-R3W

Found 10.4cm x 10.4cm Conc. Post w/ 16mm Iron Rod. (Origin Unknown)

C. Description of monument for corner and accessories established to perpetuate locating the position of the corner:

(C-6) 1/4 cor. Sec. 17 & 18, T14N-R3W

Fnd 13mm iron rod in Mon. Box per Bk. 1 P. 96, 169, 187, & 275; Bk. 2 P. 508, 546 & 547; and Bk. 3 P. 858 and is accepted as the best available evidence of the position of the original corner.

(D-4) Center 1/4 Cor., Sec. 8, T14N-R3W

Fnd 10.4 x 10.4 cm Conc. Post w/ 16mm Iron Rod (Origin Unknown) and is accepted as a careful and faithful determination of the position of the corner.

N40°W 16.383M Power Pole (R)
N52°E 20.012M 76cm Boxelder (R)
S33°W 19.166M Power Pole (R)
S42°E 20.705M NW Leg of Bingo Sign

N35°W 14.139M 25.5cm White Pine
N60°W 6.406M 18cm White Oak w/old blaze
S70°W 6.709M 12.5cm White Oak
S47°W 11.195M 15cm White Oak

Signed by Norman G. Caldwell
Surveyor's Michigan License No. 12018

Date 26 NOV 93