

81255

MAR 1 9 1984

STATE OF MICHIGAN
COUNTY OF ISABELLA
RECEIVED

Nov 30 11 32 AM '93

000014

Helen L. Stumore
REGISTER OF DEEDS

LAND CORNER RECORDATION CERTIFICATE
Filing Requirement of Act 74, Mich. P.A. 1970

For corners in
Isabella

(County)

Located In:

Corner Code #

1. Public Land Survey

T 14N R 3W

(1-6) 1-7

2. Property Controlling
in Section

S T R

3. Miscellaneous
Property in Sec.

S T R

4. Lot No. _____, Recorded Plat

5. Private Claims

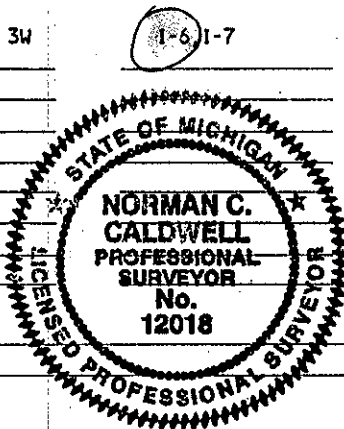

Register of Deeds Stamp & File Number

	A	B	C	D	E	F	G	H	I	J	K	L	M
2	6		5		4		3		2		1		
3													
4	7		8		9		10		11		12		
5													
6	18		17		16		15		14		13		
7													
8	19		20		21		22		23		24		
9													
10	30		29		28		27		26		25		
11													
12	31		32		33		34		35		36		
13													

I, Norman C. Caldwell, in a field survey on July, 1993

do hereby certify that under requirements of P.A. 74, Michigan P.A. of 1970, the corner points mentioned in lines 1 and 2 above were in conformance with regulations and rules therefore as required in the current manual of survey instructions of the United States Department of the Interior, Bureau of Land Management or by a decree of a Court of Law and/or that the corner points mentioned in lines 3, 4 and 5 above were in conformance with the rules of the Michigan Board of Land Surveyors or by a Decree of a Court of Law; established, re-established, monumented, re-monumented, recovered, found as expressed below:

NOTE: Not more than 4 corners, all in the same town and range, may be recorded on this certificate.

A. Description of original monument and accessories and/or subsequent restoration:

(1-6) 1/4 Cor., Sec. 14 & 15, T14N-R3W

Wood Post Placed by Joel Whight in 1832 Sub. of Twp: N50°W 10 L. (2.012M) 16" (40.5cm) Pine; S76°E 17 L. (3.420M) 12" (30.5cm) Beech.

L.C.R.C. by H. Fluharty, Recorded in Bk.2 P.689, Found 16mm Iron in Mon. Box: N28°W 35.988M SE cor Trailer; S39°E 21.312M 45.5cm Tw. Oak; S84°E 10.705M 20cm Pine.

L.C.R.C. by T. Mueller, Recorded in Bk 3 P.939, Found Mon. Box 2.7M+ S. of Fnc to W.: NW 35.954M SE Cor Trailer; SE 21.299M 45.5cm Tw. Oak; East 10.704M 20cm Pine; NNE 27.334M 20cm Pine.

L.C.R.C. by G. Gray, Recorded in Bk.4 P. 1081; Found Mon. Box: NW 35.954M SE Cor Trailer; SE 21.299M 45.5cm Tw. Oak; East 10.705M 20cm Pine; NNE 27.334M 20cm Pine.

Surveys by: Jones, L. 2, pg. 635, Ruddell, L. 3, pg. 78, Mueller, L. 4, pg. 228 & 577, County Surveyor record in Book 3, pg. 75

(1-7) Section Cor., 14, 15, 22, & 23, T14N-R3W

Wood Post Placed by Joel Whight in 1832 Sub. of Twp.: N33°E 8 L. (1.609M) 6" (15cm) Birch; S33°W 32 L. (6.437M) 8" (20cm) Beech

L.C.R.C. by J. Radcliffe, Recorded in Bk. 1 P. 165, Found 26mm Iron: S45°E 28.584M 15cm Poplar; S45°W 14.292M N. End CMP; N45°W 14.088M S. End CMP.

L.C.R.C. by W. Ruddell, Recorded in Bk. 1 P. 190, Found Mon. Box: No witnesses.

L.C.R.C. by H. Fluharty, Recorded in Bk. 2 P. 689, Found 13mm Iron in Mon. Box: S45°W 14.292M S. End CMP; N45°W 14.082M N. End CMP; N45°E 13.996M P. Pole.

L.C.R.C. by H. Fluharty, Recorded in Bk. 3 P.1015, Found 16mm Iron in Mon. Box @ Inter.: N52°E 14.027M P. Pole; N50°W 16.904M P. Pole; S77°W 16.286M Stop Sign; S8°E 48.073M 30.5cm Tree.

L.C.R.C. by G. Gray, Recorded in Bk. 4 P. 1106, Found 13mm Rod in Mon. Box: SE 16.380M T. Pole; NW 16.859M P. Pole; SW 19.614M 10.4cm Oak; ENE 19.614M Face Gas Pipeline Marker.

County Surveyor record in Book 3, pg. 75

B. Description of corner evidence found and/or method applied in restoring or reestablishing corner:

(1-6) 1/4 Cor., Sec. 14 & 15, T14N-R3W

Found 16mm Iron Rod in Mon. Box (no cover) per Bk. 2 P. 689, Bk. 3 P. 939, and Bk. 4 P. 1081.

(1-7) Section Cor., 14, 15, 22, & 23, T14N-R3W

Found 13mm Iron in Mon. Box per Bk.1 Pgs.165 & 190, Bk.2 P.689, Bk. 3 P.1015, and Bk.4 P.1106.

C. Description of monument for corner and accessories established to perpetuate locating the position of the corner:

(1-6) 1/4 Cor., Sec. 14 & 15, T14N-R3W

Found 16mm Iron Rod in Mon. Box (no cover) per Bk. 2 P. 689, Bk 3 P. 939, and Bk. 4 P. 1081, and is accepted as the best available evidence of the position of the original corner.
N30°W 36.000M SE cor Trailer (R)
S35°E 21.304M 35.5cm Tw. White Oak (R)
S87°E 10.708M 25.5cm Jack Pine (R)
N18°E 27.338M 15cm Jack Pine (R)
S40°E 13.398M 20 cm Jack Pine

(1-7) Section Cor., 14, 15, 22, & 23, T14N-R3W

Found 13mm Iron in Mon. Box per Bk. 1 Pgs.165 & 190, Bk. 2 P.689, Bk. 3 P.1015, and Bk. 4 P.1106; and is accepted as the best available evidence of the position of the original corner.
S39°E 16.367M Power Pole (R)
N55°W 16.837M Power Pole (R)
N72°W 28.635M 10.4cm White Pine
S40°W 32.312M 15cm Twin Ash

Signed by *Norman C. Caldwell*
Surveyor's Michigan License No. 12018

Date 26 NOV 93