

00517

LAND CORNER RECORDATION CERTIFICATE
Filing Requirement of Act 74, Mich. P.A. 1970
Isabella County Remonumentation

SURVEY &
REMONUMENTATION
MAR 09 1999

For Corners in
Isabella

SECTION

(County) Located In: Corner Code#:
1. Public Land Survey T. 14N R. 4W B-13
2. Public Controlling in Section S. T. R.
3. Miscellaneous Property in Section S. T. R.
4. Lot No. Recorded Plat
5. Private Claims

9900000517
Filed for Record in
ISABELLA COUNTY, MI
SHARON A BROWN
On 01-19-1999 At 08:13:49 am.
RE LAND COR 9.00
Liber 1 Page 285 - 285

Register of Deeds Stamp & File Number

I, Jan S. Fokens, in a field survey on August 24, 1998, do hereby certify that under requirements of P.A. 74, Michigan P.A. of 1970, the corner points mentioned in lines 1 and 2 above were in conformance with regulations and rules therefore as required in the current manual of survey instructions of the United States Department of the Interior, Bureau of Land Management or by a decree of a Court of Law and/or that the corner points mentioned in lines 3, 4 and 5 above were in conformance with the rules of the Michigan Board of Land Surveyors or by a Decree of a Court of Law, established, re-established, monumented, re-monumented, recovered, found as expressed below.

Table with 13 rows and 12 columns (A-L) containing numbers 1-36 in a grid pattern.

NOTE: Not more than 2 corners, all in the same town and range, may be recorded on this certificate.

A. Description of original monument and accessories and/or subsequent restoration:

- 1. G.L.O Original Survey Township Lines: 1st quarter 1837 John Hodgson Subdivision and Resurvey: 4th quarter 1838 R. Whitcomb Page 238, 298 Original Field Notes
2. County Survey Records: Liber 1, Page 28 No date of name of surveyor Liber 2, Page 165 January 24, 1882 J. A. Graham Set blue stone at proportionate distance
3. L.C.R.C.: Liber 3, Page 865 William Ruddell Recorded date October 14, 1987 Found 3/4" solid rod
4. Surveys of Record: Liber 2, Page 645 Found iron pin Liber 5, Page 387 Found 1" x 2 1/2" "T" bar
5. Unrecorded Survey: Paul B. Lapham & Associates, Inc. Certified Survey Found 1" x 2 1/2" "T" bar Land Surveying Consultants Certified Survey Found 1" x 2 1/2" "T" bar Land Surveying Consultants Field Notes Found 1" x 2 1/2" "T" bar Ruddell Engineering Field Notes Distance noted to N. 1/4 Corner (B-1) No Isabella County Road Commission Notes available in research

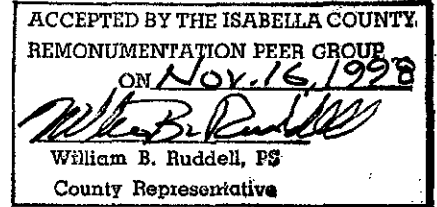

B. Description of corner evidence found and/or method applied in restoring or re-establishing corner: This corner established in Isabella County Remonumentation Program. See dossier for detailed report. This corner is an existent corner. 1. Found 1" x 2 1/2" T-bar 2. Found a large blue rock approximately 10" x 10" next to T-bar 3. Excavated to 3'. Found no further evidence.

Accepted as the best available evidence of the position of the original corner and replaced with Standard Monument Corner.

C. Description of monument for corner and accessories established to perpetuate locating the position of the corner: Set Standard Isabella County Monument in Monument Box, stamped B-13 and PS 21567. B-13 S. 1/4 Corner, Section 31, T.14N.-R.4W., Union Township, Isabella County

Witnesses held from a 1994 Land Surveying Consultants Survey, Liber 5, Page 387
S.65°W. 45.20' Found nail and tag in 36" Maple
S.50°E. 40.77' Found nail and tag in 28" Maple
N.55°E. 43.98' Found nail and tag in 14" Maple
North 62.95' power pole
East 2656.64' SE. Corner, Section 31, T.14N.-R.4W., Union Township, Isabella County.
West 2766.36' SW. Corner, Section 31, T.14N.-R.4W., Union Township, Isabella County.

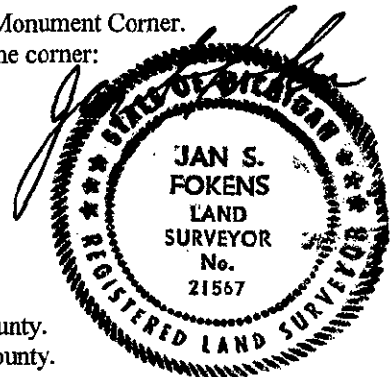

Signed by [Signature] Date Oct. 30, 1998
Surveyor's Michigan License No. 21567