

SURVEY & REMONUMENTATION

APR 27 1995

98315

COMMISSION
REMONUMENTATION CORNER

LAND CORNER RECORDATION CERTIFICATE Filing Requirement of Act 74, Mich. P.A. 1970

For corners in

<u>ISABELLA</u> <small>(County)</small>	Located In:	Corner Code #
1. Public Land Survey	T <u>14N</u> R <u>4W</u>	<u>L-7</u>
	T _____ R _____	_____
	T _____ R _____	_____
	T _____ R _____	_____
2. Property Controlling in Section	S _____ T _____ R _____	_____
	S _____ T _____ R _____	_____
3. Miscellaneous Property in Sec.	S _____ T _____ R _____	_____
	S _____ T _____ R _____	_____
4. Lot No. _____, Recorded Plat _____		
5. Private Claims _____		

STATE OF MICHIGAN
COUNTY OF ISABELLA
RECEIVED FOR RECORD

MAR 23 11 PM '95

25
SHARON A. BROWN
REGISTER OF DEEDS

Register of Deeds Stamp & File Number

	A	B	C	D	E	F	G	H	I	J	K	L	M
2	6	5	4	3	2	1							
3													
4	7	8	9	10	11	12							
5													
6	18	17	16	15	14	13							
7													
8	19	20	21	22	23	24							
9													
10	30	29	28	27	26	25							
11													
12	31	32	33	34	35	36							
13													

I, Wm. B. Ruddell, in a field survey on November, 19 94, do hereby certify that under requirements of P.A. 74, Michigan P.A. of 1970, the corner points mentioned in lines 1 and 2 above were in conformance with regulations and rules therefore as required in the current manual of survey instructions of the United States Department of the Interior, Bureau of Land Management or by a decree of a Court of Law and/or that the corner points mentioned in lines 3, 4 and 5 above were in conformance with the rules of the Michigan Board of Land Surveyors or by a Decree of a Court of Law; established, re-established, monumented, re-monumented, recovered, found as expressed below:

NOTE: Not more than 4 corners, all in the same town and range, may be recorded on this certificate.

A. Description of original monument and accessories and/or subsequent restoration:

- 1838 - Set Post
- 1959 - Found 1/2" iron inside 1 1/4" pipe (MDOT)
- 1968 - Found 1 1/2" iron
- 1981 - Found 1/2" Re-bar
- 1993 - Found 1/2" re-rod in 1 1/2" iron
- 1994 - Found rotten wood stake

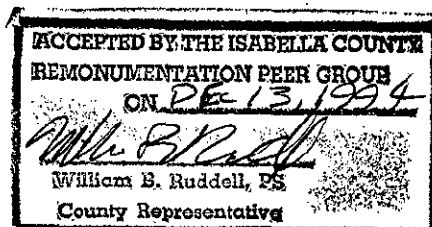

B. Description of corner evidence found and/or method applied in restoring or reestablishing corner:

- 1994 - Found 1/2" re-rod in 1 1/4" pipe (well point) dug down around well point and found top of rotten wood post at depth of 2.6 feet below existing grade, well point on South edge of post.
- Rotten Wood stake taken as original corner

C. Description of monument for corner and accessories established to perpetuate locating the position of the corner:

- 1994 - Replaced re-rod & well point with standard monument, marked L-7, in monument box. Set 4" ± below grade.
- Witnesses: N, 32.05', Nail & cap in 6" Ash
- N 56°W, 58.51', SE corner of E. leg on Freeway sign
- S 5°W, 40.75', Top centerline of anchor post on Fwy. fence
- SSE, 76.66', NW corner of block house
- N 80°W, 2.91', Face of South leg on Rd. Ends sign

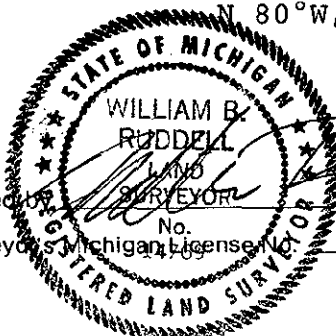

Signed by _____
Surveyor's Michigan License No. 14769

Date December 28, 1994