

MAY 05 1997

COMMISSION

116497

LAND CORNER RECORDATION CERTIFICATE
Filing Requirement of Act 74, Mich. P.A. 1970
Isabella County Remonumentation

For Corners in
Isabella
(County)

Located In: Corner Code#:

- 1. Public Land Survey T. 15 N.R. 4 W. H-3
2. Public Controlling in Section S. T. R.
3. Miscellaneous Property in Section S. T. R.
4. Lot No. Recorded Plat
5. Private Claims

STATE OF MICHIGAN
COUNTY OF ISABELLA
RECEIVED FOR RECORD

DEC 26 9 21 AM '96
000121

SHARON A. DEEDS

Register of Deeds Stamp & File Number

I, Jan S. Fokens, in a field survey on Nov., 1996, do hereby state that under requirements of P.A. 74, Michigan P.A. of 1970, the corner points mentioned in lines 1 and 2 above were in conformance with regulations and rules therefore as required in the current manual of survey instructions of the United States Department of the Interior, Bureau of Land Management or by a decree of a Court of Law and/or that the corner points mentioned in lines 3, 4 and 5 above were in conformance with the rules of the Michigan Board of Land Professionals or by a Decree of a Court of Law, established, re-established, monumented, recovered, found as expressed below.

NOTE: Not more than 2 corners, all in the same town and range, may be recorded on this certificate.

A. Description of original monument and accessories and/or subsequent restoration:

- 1. Original G.L.O. Survey: Township lines Second Quarter 1837 by John Hodgson Subdivision & Re-survey Fourth Quarter 1837 by Henry Nicholson Page 260 original field notes
2. County Survey Records:
3. L.C.R.C.: Liber 1, Page 142 A.V. Courtright July 16, 1973 Liber 3, Page 1083 Gerald J. Gray January 16, 1991
4. Surveys of Record: Liber 5, Page 469
5. Unrecorded Surveys: R.E.I. files Found re-rod or pipe

Table with 13 rows and 13 columns labeled A-M. Contains numbers 1-36 in a grid pattern.

ACCEPTED BY THE ISABELLA COUNTY REMONUMENTATION PEER GROUP ON 12/3/96
William B. Ruddell, PS
County Representative

Set 1/2" pipe 18" long
Found 1/2" pipe

B. Description of corner evidence found and/or method applied in restoring or re-establishing corner:

- This corner established in Isabella County Remonumentation Program. See dossier for detailed report.
1. Found 1/2" X 15" long rod at 0.4' below road surface on line and equidistant from SE. and SW. section corners (G-3 to H-3 2643.57') (I-3 to H-3 2643.60)
2. Hit saturated soil at 3.2' below road surface
3. Stopped excavation at 4.7' deep. No further evidence of other material.
4. Found 1" X 8" pipe 5.3' North- Does not fit witness information (Did not hold)

Accepted as best available evidence of the position of the original corner and replaced with Standard Monument Corner H-3 was approved for remonumentation at a Peer Review Committee meeting on December 3, 1996.

C. Description of monument for corner and accessories established to perpetuate locating the position of the corner:

- Set Standard Isabella County Monument in Monument Box.
S.28°E., 28.22', 24" CMP
S.50°E., 41.53', 24" CMP
S.01°W., 78.50', Found nail and disc in fence post
S.10°W., 53.89', Found nail and disc in power pole

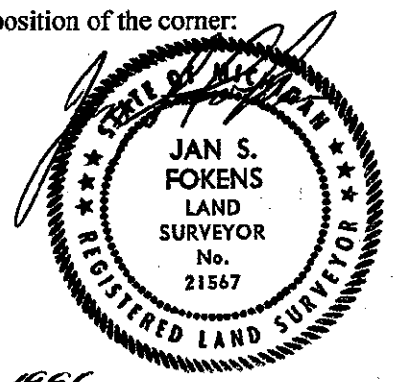

Signed by Jan S. Fokens
Surveyor's Michigan License No. 21567

Date Dec. 19, 1996