

**SURVEY &
REMONUMENTATION**

MAY 05 1997

COMMISSION

116500

LAND CORNER RECORDATION CERTIFICATE

Filing Requirement of Act 74, Mich. P.A. 1970

Isabella County Remonumentation

For Corners in
Isabella

(County)

Located In:

Corner Code#:

- | | | |
|---------------------------------------|--------------------------------|------------|
| 1. Public Land Survey | T. <u>15 N.</u> R. <u>4 W.</u> | <u>I-3</u> |
| | T. _____ R. _____ | _____ |
| | T. _____ R. _____ | _____ |
| 2. Public Controlling in Section | S. _____ T. _____ R. _____ | _____ |
| | S. _____ T. _____ R. _____ | _____ |
| 3. Miscellaneous Property in Section | S. _____ T. _____ R. _____ | _____ |
| | S. _____ T. _____ R. _____ | _____ |
| 4. Lot No. _____, Recorded Plat _____ | | |
| 5. Private Claims _____ | | |

STATE OF MICHIGAN
COUNTY OF ISABELLA
RECEIVED FOR RECORD

DEC 26 9 22 AM '96

000124

SHARON A. BROWN
REGISTER OF DEEDS

Register of Deeds Stamp & File Number

I, Jan S. Fokens, in a field survey on Nov., 1996, do hereby state that under requirements of P.A. 74, Michigan P.A. of 1970, the corner points mentioned in lines 1 and 2 above were in conformance with regulations and rules therefore as required in the current manual of survey instructions of the United States Department of the Interior, Bureau of Land Management or by a decree of a Court of Law and/or that the corner points mentioned in lines 3, 4 and 5 above were in conformance with the rules of the Michigan Board of Land Professionals or by a Decree of a Court of Law, established, re-established, monumented, recovered, found as expressed below.

NOTE: Not more than 2 corners, all in the same town and range, may be recorded on this certificate.

| A | B | C | D | E | F | G | H | I | J | K | L | M |
|----|----|----|----|----|----|----|---|---|---|---|---|---|
| 2 | 6 | 5 | 4 | | | | | 3 | 2 | 1 | | |
| 3 | | | | | | | | | | | | |
| 4 | 7 | 8 | 9 | 10 | 11 | 12 | | | | | | |
| 5 | | | | | | | | | | | | |
| 6 | 18 | 17 | 16 | 15 | 14 | 13 | | | | | | |
| 7 | | | | | | | | | | | | |
| 8 | 19 | 20 | 21 | 22 | 23 | 24 | | | | | | |
| 9 | | | | | | | | | | | | |
| 10 | 30 | 29 | 28 | 27 | 26 | 25 | | | | | | |
| 11 | | | | | | | | | | | | |
| 12 | 31 | 32 | 33 | 34 | 35 | 36 | | | | | | |
| 13 | | | | | | | | | | | | |

A. Description of original monument and accessories and/or subsequent restoration:

1. Original G.L.O. Survey:

Township lines Second Quarter 1837 by John Hodgson
Subdivision & Re-survey Fourth Quarter 1837 by Henry Nicholson
Page 250 original field notes

2. County Survey Records:

None

3. L.C.R.C.:

Liber 1, Page 142 A. V. Courtright July 16, 1973
Liber 1, Page 370 Herbert L. Fluharty May 4, 1976
Liber 3, Page 851 William B. Ruddell July 14, 1987

4. Surveys of Record:

Liber 5, Page 469 Found re-rod in monument box

5. Unrecorded Surveys:

Isabella County Road Commission - Section corner map
Project 169-A plans
MDOT

Found iron in monument box
Found monument box
Found monument box

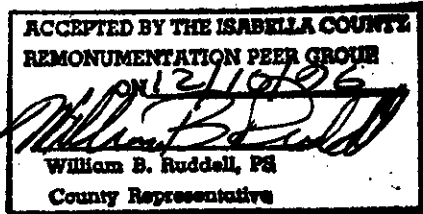

Witnesses noted
Witnesses noted
R.O.W. map

B. Description of corner evidence found and/or method applied in restoring or re-establishing corner:

This corner established in Isabella County Remonumentation Program. See dossier for detailed report.

1. Found 60d spike (referenced as re-rod) 0.75' deep in monument box 1' E. of centerline Mission and centerline Denver
2. Found 2" X 2" X 3" angle iron with cross member at 1.0' deep
3. Held position of spike in center of angle iron and cross member as corner
4. No further excavation completed

Accepted as best available evidence of the position of the original corner and replaced with Standard Monument Corner I-3 was approved for remonumentation at a Peer Review Committee meeting on December 10, 1996.

C. Description of monument for corner and accessories established to perpetuate locating the position of the corner:

Set Standard Isabella County Monument in Monument Box.
N.64°E. 53.05' Found nail and Ruddell tag in 8' drop pole with Ameritech box
S.54°E. 67.33' Found nail and tag in SE. face of 12" pine
S.28°E. 78.01' Found nail and metal disc in utility pole
N.50°W. 92.88' SE. corner stone wishing well

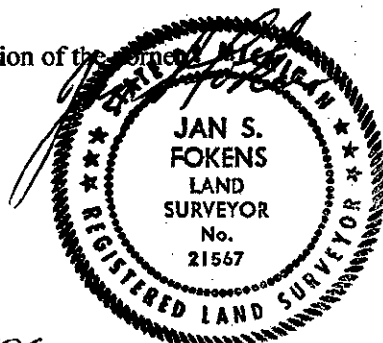

Signed by Jan S. Fokens
Surveyor's Michigan License No. 21567

Date DEC. 19, 1996