

MAR 09 1998

LAND CORNER RECORDATION CERTIFICATE

Filing Requirement of Act 74, Mich. P.A. 1970

SECTION

For Corners in  
Isabella

(County)

Located In:

Corner Code#

2800001912  
Filed for Record in  
ISABELLA COUNTY, MI  
SHARON A BROWN  
On 02-27-1998 At 03:38:20 pm.  
RE LAND COR 9.00  
Book DR Vol. 1 Pg. 234 - 234

1. Public Land Survey T. 16N. R. 5W. K-1
- T. \_\_\_\_\_ R. \_\_\_\_\_
- T. \_\_\_\_\_ R. \_\_\_\_\_
2. Public Controlling S. \_\_\_\_\_ T. \_\_\_\_\_ R. \_\_\_\_\_  
in Section S. \_\_\_\_\_ T. \_\_\_\_\_ R. \_\_\_\_\_
3. Miscellaneous S. \_\_\_\_\_ T. \_\_\_\_\_ R. \_\_\_\_\_  
Property in Section S. \_\_\_\_\_ T. \_\_\_\_\_ R. \_\_\_\_\_
4. Lot No. \_\_\_\_\_, Recorded Plat \_\_\_\_\_
5. Private Claims \_\_\_\_\_

Register of Deeds Stamp & File Number

I, Mark Robison, in a field survey on October 2, 1997, do hereby certify that under requirements of P.A. 74, Michigan P.A. of 1970, the corner points mentioned in lines 1 and 2 above were in conformance with regulations and rules therefore as required in the current manual of survey instructions of the United States Department of the Interior, Bureau of Land Management or by a decree of a Court of Law and/or that the corner points mentioned in lines 3, 4 and 5 above were in conformance with the rules of the Michigan Board of Land Surveyors or by a Decree of a Court of Law, established, re-established, monumented, re-monumented, recovered, found as expressed below.

NOTE: Not more than 2 corners, all in the same town and range, may be recorded on this certificate.

|    | A  | B  | C  | D  | E  | F  | G | H | I | J | K | L | M |
|----|----|----|----|----|----|----|---|---|---|---|---|---|---|
| 1  |    |    |    |    |    |    |   |   |   |   |   |   |   |
| 2  | 6  | 5  | 4  | 3  | 2  | 1  |   |   |   |   |   |   |   |
| 3  |    |    |    |    |    |    |   |   |   |   |   |   |   |
| 4  | 7  | 8  | 9  | 10 | 11 | 12 |   |   |   |   |   |   |   |
| 5  |    |    |    |    |    |    |   |   |   |   |   |   |   |
| 6  | 18 | 17 | 16 | 15 | 14 | 13 |   |   |   |   |   |   |   |
| 7  |    |    |    |    |    |    |   |   |   |   |   |   |   |
| 8  | 19 | 20 | 21 | 22 | 23 | 24 |   |   |   |   |   |   |   |
| 9  |    |    |    |    |    |    |   |   |   |   |   |   |   |
| 10 | 30 | 29 | 28 | 27 | 26 | 25 |   |   |   |   |   |   |   |
| 11 |    |    |    |    |    |    |   |   |   |   |   |   |   |
| 12 | 31 | 32 | 33 | 34 | 35 | 36 |   |   |   |   |   |   |   |
| 13 |    |    |    |    |    |    |   |   |   |   |   |   |   |

A. Description of original monument and accessories and/or subsequent restoration:

- Original G.L.O. Survey:  
Township Lines: 2<sup>nd</sup> Quarter by John Hodgson, 1837  
Subdivision & Re-survey: 4<sup>th</sup> Quarter by Henry Nicholson, 1837  
Pages 498-520 Original field notes
- County Survey of Records:  
Liber 3, Page 165, November 1901, E.R. Coburn  
Liber 3, Page 166, November 1901, E.R. Coburn  
Sm. Liber 1, Page 62-63, November, 1901, E.R. Coburn  
Sm. Liber 1, Page 64-65, November, 1901, E.R. Coburn
- L.C.R.C.  
Liber 1, Page 129 Paul B. Lapham  
Liber 4, Page 1227 David Erickson Found 1/2" rebar in S. road ditch
- Surveys of Record:  
Liber 1, Page 105 Hunter, Whittier, Assoc. Found 1/2" rerod  
Liber 1, Page 200 Paul B. Lapham & Assoc., December 29, 1972 Witnesses cited  
Liber 5, Page 317 David Erickson November 24, 1993 Found 1/2" rebar
- Unrecorded Surveys:  
P.B.L.&A., Certificate of Survey, Found 1/2" rerod

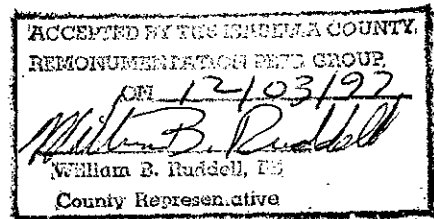

B. Description of corner evidence found and/or method applied in restoring or re-establishing corner:

This corner established in Isabella County Remonumentation Program. See dossier for detailed report.

Found 1/2" X 18" capped iron (Erickson) and all 1993 and 1972 witnesses.  
Corner is on South bank of South ditch.

Accepted as best available evidence of the position of the original corner and replaced with Standard Monument.

C. Description of monument for corner and accessories established to perpetuate locating the position of the corner:  
Set Standard Isabella County Monument in a Monument Box marked PS 27458.

N46°W 100.79' Nail & Tag in p.p.  
S40°W 22.79' Nail & Tag in 15" Ash  
S72°W 26.82' Nail & Tag in 24" Ash  
West 81.18' K-1, T.17N.-R.5W.

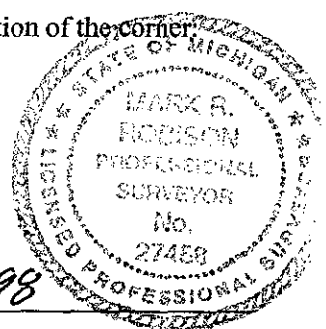

Signed by Mark R. Robison  
Surveyor's Michigan License No. 27458

Date 2-26-98