

12-21-55  
 150 Gal/m  
 1" snow

SEE JACKSON CO  
 MISC # 6

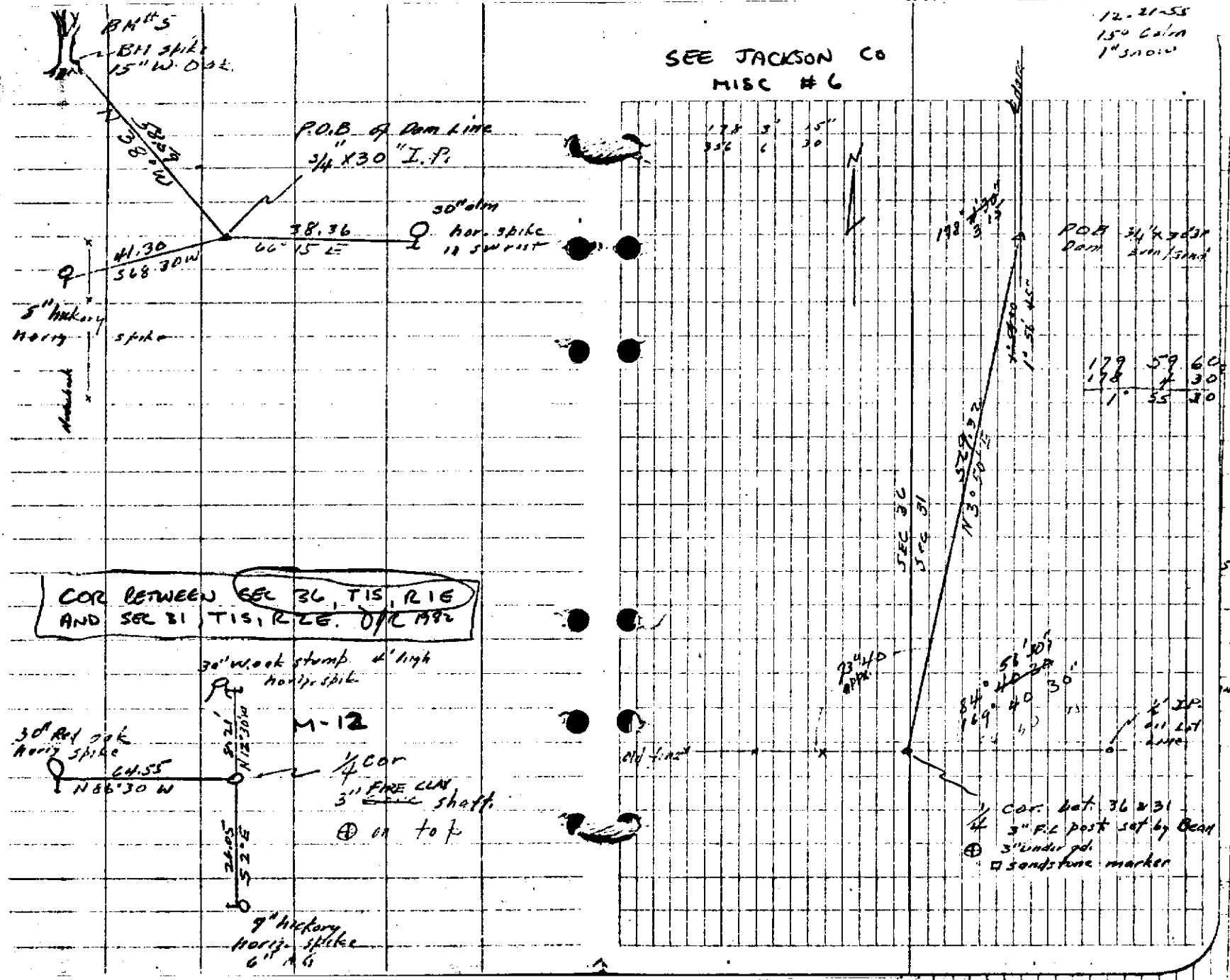

**COR BETWEEN SEC 36, T15, R16  
 AND SEC 31, T15, R16, D/C 1892**

B.M. 5  
 BH spike  
 15" W. D. & L.

P.O.B. of Dam Line  
 3/4" x 30" I.P.

178 3' 15"  
 356 6' 30"

P.O.B. 3/4" x 30"  
 Dam Iron Sand

179 59' 60"  
 198 7' 30"  
 1' 55' 30"

30' Red oak  
 Horiz spike  
 64.55  
 N 86° 30' W

30' wood stump 4' high  
 Horiz spike

M-12

1/4 cor  
 3" FIRE CLAY  
 shaft  
 ⊕ on top

9" hickory  
 Horiz spike  
 6" dia

23 1/2' D  
 APPX.

84° 40' 30"  
 169° 40' 30"

1/2 cor. bet. 36 & 31  
 3" FIRE post set by Bear  
 ⊕ 3" under gd.  
 □ sandstone marker