

Chairman Nan Galtman

NE CORNER SECTION 25  
TOMPKINS TOWNSHIP  
LAND CORNER RECORDATION CERTIFICATE  
Filing Requirement of Act 74, Mich. P.A. 1970

Date Dec. 8, 1994

For corners in

JACKSON (County)	Located In:	Corner Code #
1. Public Land Survey	T <u>1S</u> R <u>2W</u>	<u>M-9</u>
	T _____ R _____	_____
	T _____ R _____	_____
	T _____ R _____	_____
2. Property Corner in Section	S _____ T _____	_____
	S _____ T _____	_____
3. Miscellaneous Property in Sec.	S _____ T _____	_____
	S _____ T _____	_____

STATE OF MICHIGAN  
JACKSON COUNTY  
RECORDED

2 MAY 95 8:25 A.M.

GERALD J. McDEVITT  
REGISTER OF DEEDS

Register of Deeds Stamp & File Number

4. Lot No. \_\_\_\_\_ Recorded Plat \_\_\_\_\_  
5. Private Claims \_\_\_\_\_

	A	B	C	D	E	F	G	H	I	J	K	L	M
2	6		5		4		3		2		1		
3													
4	7		8		9		10		11		12		
5													
6	18		17		16		15		14		13		
7													
8	19		20		21		22		23		24		
9													
10	30		29		28		27		26		25		
11													
12	31		32		33		34		35		36		
13													

I, RONALD L. ENGER, in a field survey on OCTOBER 5, 19 94, do hereby certify that under requirements of P.A. 74, Michigan P.A. of 1970, the corner points mentioned in lines 1 and 2 above were in conformance with regulations and rules thereore as required in the current manual of survey instructions of the United States Department of the Interior, Bureau of Land Management or by a decree of a Court of Law and/or that the corner points mentioned in lines 3, 4 and 5 above were in conformance with the rules of the Michigan Board of Land Surveyors or by a Decree of a Court of Law, established, re-established, monumented, re-monumented, recovered, found as expressed below.

NOTE: Not more than 4 corners, all in the same town and range, may be recorded on this certificate.

A. Description of original monument and accessories and/or subsequent restoration:

- POST SET IN ORIGINAL GOVERNMENT SURVEY BY JOSEPH WAMPLER, DEPUTY SURVEYOR, ON JANUARY 26TH, 1823, WITH THE FOLLOWING WITNESSES:  
W.O. 24 N46W 9 (5.94')  
B.O. 30 S20½W 95 (62.7')
- ON OCTOBER 23, 1885, JOHN HOLCROFT REPORTED: "CORNER GONE. FOUND ROOT OF 2ND WITNESS. SET POST WITH IT WHICH AGREES WITH JOG FOR RIVES CORNER 40LKS NORTH.  
W. OAK 8 S23¼W 75 ¾ (50.0') \$ 2.00 REMONUMENTATION  
Y. DO. 6 WEST 192½ (127.05') \$ 9.00 CORNER REMONUMENTATION

CONTINUED ON BACK

B. Description of corner evidence found and/or method applied in restoring or reestablishing corner:

SEARCHED AT APPARENT LOCATION OF CORNER AND FOUND 3/4" CONDUIT WITH CAP 7863 IN MONUMENT BOX FROM JACKSON COUNTY ROAD COMMISSION WITNESSES. REMOVED CONDUIT AND EXCAVATED THRU THE MONUMENT BOX AND FOUND 3/4" PIPE DIRECTLY BELOW THE SHORT PIECE OF CONDUIT AND DIRECTLY OVER A FIRECLAY POST. REMOVED PIPE. ACCEPTED FIRECLAY AS CORNER POINT PERPETUATED BY JOHN HOLCROFT IN 1885. LEFT FIRECLAY IN PLACE AND SET 5/8" X 24" REBAR WITH JACKSON COUNTY REMONUMENTATION CAP LS #28409 DIRECTLY OVER THE FIRECLAY.

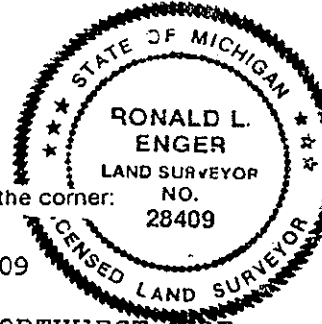

C. Description of monument for corner and accessories established to perpetuate locating the position of the corner:

- M-9 T1S R2W  
5/8" X 24" REBAR WITH JACKSON COUNTY REMONUMENTATION CAP LS # 28409
- |          |                |        |  |
|----------|----------------|--------|--|
| 29° NAZ  | 22" OAK        | 66.92' | 60D SPIKE IN WEST SIDE                   |
| 46° NAZ  | 8" OAK         | 45.75' | NAIL AND TAG LS #28409 IN NORTHWEST SIDE |
| 218° NAZ | 15" DOUBLE OAK | 40.83' | 60D SPIKE IN EAST SIDE                   |
| 316° NAZ | 6" HICKORY     | 35.20' | FOUND NAIL AND SHINER IN NORTH SIDE      |

NOTE: NAZ IS MAGNETIC AZIMUTH FROM THE NORTH.

Signed by Ronald L. Enger Date DECEMBER 8, 1994  
Surveyor's Michigan License No. 28409

M-9 T1S R2W  
PART A CONTINUED

3. JACKSON COUNTY ROAD COMMISSION WITNESSES (UNDATED)

44°E 10" OAK 49.15'  
N30°E 20" OAK 66.82'  
N45°W 3" HICKORY 35.15'  
S40°W 12" DBL. OAK 40.96'  
IN LINE WITH THE FENCE WEST  
MON BOX SET 9/1977  
26.5' S OF RIVES CORNER

4. RICHARD E. GUTEKUNST, RLS 7863, RECORDED CORNER IN LIBER 3 OF CORNERS, PAGE 23 IN JUNE, 1977, AS A SET 3/4" IRON ON TOP OF TWO 1/2" IRONS.

S 41°± W	18" OAK	40.84'
N 69°± W	DBL. 8" OAK	34.39'
N 32°± E	18" OAK	68.29'
N 66°± E	16" OAK	59.17'
WEST	CAPPED IRON	33.0'