

**JACKSON COUNTY  
APPROVED LAND CORNER  
P.A. 345 of 1990**

Notary  
Chairman *David E. Eubank*  
Date 7-8-98

NORTH 1/4 POST, SECTION 34  
PARMA TOWNSHIP

**LAND CORNER RECORDATION CERTIFICATE**  
Filing Requirement of Act 74, Mich. P.A. 1970

**SURVEY &  
MONUMENTATION**

SEP 16 1998

For corners in  
**JACKSON**  
(County)

Located In: Corner Code #

- 1. Public Land Survey T 2 S R 3 W
- 2. Property Controlling S \_\_\_ T \_\_\_ R \_\_\_
- 3. Miscellaneous S \_\_\_ T \_\_\_ R \_\_\_
- Property in Sec. S \_\_\_ T \_\_\_ R \_\_\_

H-11



Mindy Reilly - Jackson Co.

CORREM

2080950  
Page: 1 of 1  
07/21/1998 10:30A  
L-1575 P-1171

SECTION

Register of Deeds Stamp & File Number

- 4. Lot No. \_\_\_\_\_ Recorded Plat \_\_\_\_\_
- 5. Private Claims \_\_\_\_\_

A	B	C	D	E	F	G	H	I	J	K	L	M
2	6	5	4	3	2	1						
3												
4	7	8	9	10	11	12						
5												
6	18	17	16	15	14	13						
7												
8	19	20	21	22	23	24						
9												
10	30	29	28	27	26	25						
11												
12	31	32	33	34	35	36						
13												

I, **DEAN R. GUTEKUNST**, in a field survey on September 4, 19 97, do hereby certify that under requirements of P.A. 74, Michigan P.A. of 1970, the corner points mentioned in lines 1 and 2 above were in conformance with regulations and rules therefore as required in the current manual of survey instructions of the United States Department of the Interior, Bureau of Land Management or by a decree of a Court of Law and/or that the corner points mentioned in lines 3, 4 and 5 above were in conformance with the rules of the Michigan Board of Land Surveyors or by a Decree of a Court of Law; established, re-established, monumented, re-monumented, recovered, found as expressed below:

**NOTE: Not more than 4 corners, all in the same town and range, may be recorded on this certificate.**

A. Description of original monument and accessories and/or subsequent restoration:

Original Government Post set by Lucius Lyon, Deputy Surveyor, 1825.  
W. Oak 8" North 125 links (82.50')  
B. Oak 8" S 6 1/2 W 80 links (52.80')

No perpetuation found for the 1880's.

Perpetuation by Richard E. Gutekunst, RIS #7863, dated June 17, 1972.

NE to SE corner concrete bridge pillar 77.63' Found iron in blacktop.  
NW to SW corner concrete bridge pillar 75.88'

Not recorded in P. A. - 74.

B. Description of corner evidence found and/or method applied in restoring or reestablishing corner:

Found 1/2" iron pipe in North Concord Road (blacktop) just South of the I-94 bridge.

Backhoe excavation under iron did not reveal any additional evidence of the original corner. Area may have had extensive excavation in building I-94 bridge.

Accepted found iron as the best available evidence of the position of the corner.

Set a Standard Jackson County Monument to replace the iron found.

Corner is 2'± West of the center line of blacktop.

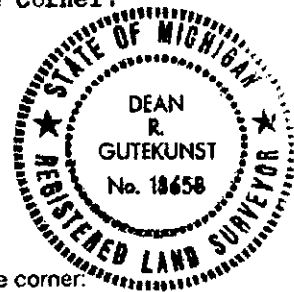

C. Description of monument for corner and accessories established to perpetuate locating the position of the corner:

H-11 T2S, R3W Corner is a 4" diameter X 30" Cast Iron Harrison monument with a brass cap stamped LS 18658, which is a standard monument for Jackson County.

N 15 W Southeast corner of concrete bridge pier 74.99'  
N 15 E Southwest corner of concrete bridge pier 76.50'  
N 75 W Northeast corner of Angle iron Corner post 60.69'  
S 35 E Found vertical nail and cap in top of South end guard rail post 47.94'  
S 45 W Found vertical nail and cap in top of South end guard rail post 36.21'

Monument box set over monument by Jackson County Road Commission.

Signed by *Dean R. Gutekunst*

Date July 1, 1998

Surveyor's Michigan License No. 18658