

**JACKSON COUNTY
APPROVED LAND CORNER**

P.A. 345 of 1990

WEST 1/4 POST, SECTION 18, SPRING ARBOR TOWNSHIP

Chairman Alan L. Schepelman

Date Nov. 13, 1996

**LAND CORNER RECORDATION CERTIFICATE
Filing Requirement of Act 74, Mich. P.A. 1970**

#2022286
Liber 1533 Page 163
Page 1 of 1
Jackson Co., MI
Recorded
12/11/96 11:28A
Jerry McDavitt
Register of Deeds

corners in

| Jackson (County) | Located In: | Corner Code # |
|---------------------------------|-------------------------|---------------|
| Public Land Survey | T <u>3S</u> R <u>2W</u> | <u>A-6</u> |
| | T _____ R _____ | _____ |
| | T _____ R _____ | _____ |
| | T _____ R _____ | _____ |
| Property Controlling in Section | S _____ T _____ R _____ | _____ |
| | S _____ T _____ R _____ | _____ |
| Miscellaneous Property in Sec. | S _____ T _____ R _____ | _____ |
| | S _____ T _____ R _____ | _____ |

Register of Deeds Stamp & File Number

4. Lot No. _____, Recorded Plat _____
5. Private Claims _____

| | A | B | C | D | E | F | G | H | I | J | K | L | M |
|----|----|---|----|---|----|---|----|---|----|---|----|---|---|
| 2 | 6 | | 5 | | 4 | | 3 | | 2 | | 1 | | |
| 3 | | | | | | | | | | | | | |
| 4 | 7 | | 8 | | 9 | | 10 | | 11 | | 12 | | |
| 5 | | | | | | | | | | | | | |
| 6 | 18 | | 17 | | 16 | | 15 | | 14 | | 13 | | |
| 7 | | | | | | | | | | | | | |
| 8 | 19 | | 20 | | 21 | | 22 | | 23 | | 24 | | |
| 9 | | | | | | | | | | | | | |
| 10 | 30 | | 29 | | 28 | | 27 | | 26 | | 25 | | |
| 11 | | | | | | | | | | | | | |
| 12 | 31 | | 32 | | 33 | | 34 | | 35 | | 36 | | |
| 13 | | | | | | | | | | | | | |

Alan L. Schepelman in a field survey on May 29, 1996

do hereby certify that under requirements of P.A. 74, Michigan P.A. of 1970, the corner points mentioned in lines 1 and 2 above were in conformance with regulations and rules therefore as required in the current manual of survey instructions of the United States Department of the Interior, Bureau of Land Management or by a decree of a Court of Law and/or that the corner points mentioned in lines 3, 4 and 5 above were in conformance with the rules of the Michigan Board of Land Surveyors or by a Decree of a Court of Law; established, re-established, monumented, re-monumented, recovered, found as expressed below:

NOTE: Not more than 4 corners, all in the same town and range, may be recorded on this certificate.

A. Description of original monument and accessories and/or subsequent restoration:

POINT NOT SET IN ORIGINAL GOVERNMENT SURVEYS.

B. Description of corner evidence found and/or method applied in restoring or reestablishing corner:

CORNER FALLS IN THE CENTER OF AN EAST-WEST DRAIN. SINGLE PROPORTIONED BETWEEN A-5 AND A-7 FOR THE CORNER POSITION. SET 1" X 60" ALUMINUM PIPES NORTH AND SOUTH ON THE SECTION LINES. THERE WAS NO JOG AT A-7 IN THE ORIGINAL NOTES BECAUSE THEY CLOSED ON THE POST AND A-5 WAS 4 LINKS SOUTH OF M-5, T3S, R3W. A-6 IS THEN 2 LINKS (1.32') SOUTH OF M-6. NO CORNER WAS SET BECAUSE OF THE DRAIN. REFERENCE MONUMENTS WERE SET 50.00' NORTH AND SOUTH OF M-6, T3S, R3W.

*REFERENCE MONUMENTS WERE SET FOR M-6, T3S, R3W AND ARE 1" X 60" ALUMINUM PIPES WITH JACKSON COUNTY REMONUMENTATION CAP STAMPED "M-6 REF-1 (2) T3S R3W LS 35998".

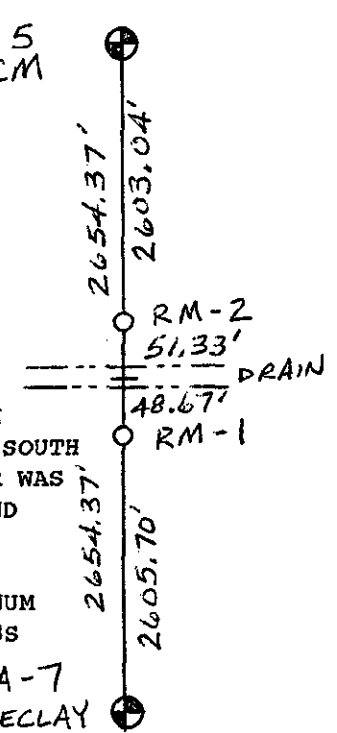

C. Description of monument for corner and accessories established to perpetuate locating the position of the corner:

A-6 IS IN DRAIN AND NO MONUMENT WAS SET AT THE CORNER POSITION.

| | |
|---|--------|
| REFERENCE MONUMENT-1, SOUTH ON THE SECTION LINE | 48.67' |
| S45°E NAIL & TAG #35998 IN NW SIDE OF 14" ELM | 22.49' |
| NORTH SOUTH EDGE OF WATER OF DRAIN | 33.4' |
| EAST SURVEY MARKER SIGN POST | 1.0' |

| | |
|---|--------|
| REFERENCE MONUMENT-2, NORTH ON THE SECTION LINE | 51.33' |
| SOUTH NORTH EDGE OF WATER OF DRAIN | 43.0' |
| EAST SURVEY MARKER SIGN POST | 1.0' |

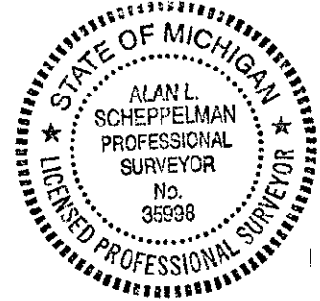

Signed by Alan L. Schepelman Date 08/09/96

Surveyor's Michigan License No. 35998