

**JACKSON COUNTY  
APPROVED LAND CORNER  
P.A. 343 of 1990**

CENTER OF SECTION 18, SPRING ARBOR TOWNSHIP

Chairman Alan L. Scheppelman  
Date Nov. 13, 1996

**LAND CORNER RECORDATION CERTIFICATE  
Filing Requirement of Act 74, Mich. P.A. 1970**

#2022267  
Liber 1533 Page 164  
Page 1 of 1  
Jackson Co., MI  
Recorded  
12/11/96 11:28A  
Jerry McDevitt  
Register of Deeds

For corners in Jackson (County)	Located In:	Corner Code #
1. Public Land Survey	T <u>3S</u> R <u>2W</u>	<u>B-6</u>
	T _____ R _____	_____
	T _____ R _____	_____
	T _____ R _____	_____
2. Property Controlling In Section	S _____ T _____ R _____	_____
	S _____ T _____ R _____	_____
3. Miscellaneous Property in Sec.	S _____ T _____ R _____	_____
	S _____ T _____ R _____	_____

Register of Deeds Stamp & File Number

4. Lot No. \_\_\_\_\_, Recorded Plat \_\_\_\_\_  
5. Private Claims \_\_\_\_\_

	A	B	C	D	E	F	G	H	I	J	K	L	M
2	6	5	4	3	2	1							
3													
4	7	8	9	10	11	12							
5													
6	18	17	16	15	14	13							
7													
8	19	20	21	22	23	24							
9													
10	30	29	28	27	26	25							
11													
12	31	32	33	34	35	36							
13													

Alan L. Scheppelman June 3 1996  
in a field survey on \_\_\_\_\_, 19 \_\_\_\_\_

I hereby certify that under requirements of P.A. 74, Michigan P.A. of 1970, the corner points mentioned in lines 1 and 2 above were in conformance with regulations and rules therefore as required in the current manual of survey instructions of the United States Department of the Interior, Bureau of Land Management or by a decree of a Court of Law and/or that the corner points mentioned in lines 3, 4 and 5 above were in conformance with the rules of the Michigan Board of Land Surveyors or by a Decree of a Court of Law; established, re-established, monumented, re-monumented, recovered, found as expressed below:

**NOTE: Not more than 4 corners, all in the same town and range, may be recorded on this certificate.**

A. Description of original monument and accessories and/or subsequent restoration:  
**POINT NOT SET IN ORIGINAL GOVERNMENT SURVEYS.**

B. Description of corner evidence found and/or method applied in restoring or reestablishing corner:  
**SET 1" X 60" ALUMINUM PIPE WITH JACKSON COUNTY REMONUMENTATION CAP AT THE INTERSECTION OF THE 1/4 LINES.**

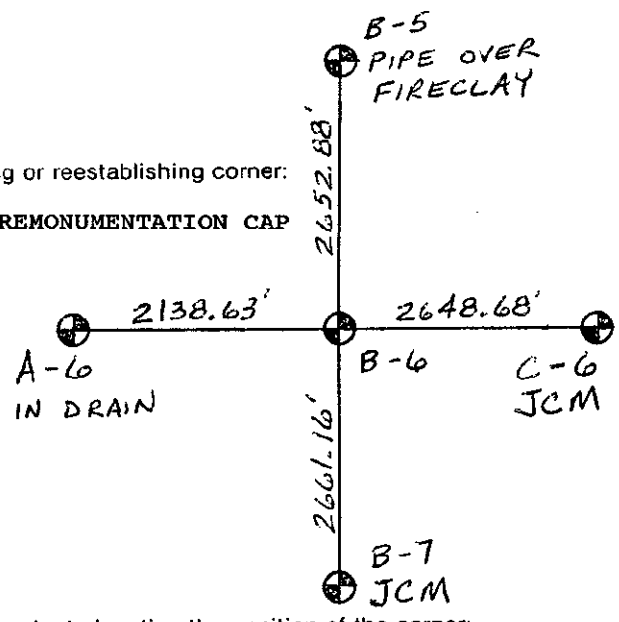

C. Description of monument for corner and accessories established to perpetuate locating the position of the corner:

- 1" X 60" ALUMINUM PIPE WITH JACKSON COUNTY REMONUMENTATION CAP STAMPED "B-6 T3S R2W LS NO. 35998".
- N42°E NAIL & TAG #35998 IN WEST SIDE OF RR TIE FENCE POST 14.35'
- S38°E NAIL & TAG #35998 IN SW SIDE OF RR TIE FENCE POST 14.34'
- S05°W NAIL & TAG #35998 IN EAST SIDE OF 14" ELM 200.80'
- N42°W NAIL & TAG #35998 IN EAST SIDE OF 10" ELM 34.88'
- NORTH EAST-WEST FENCE 1.5'
- EAST NORTH-SOUTH FENCE 10.5'
- NORTH SURVEY MARKER SIGN POST 0.8'

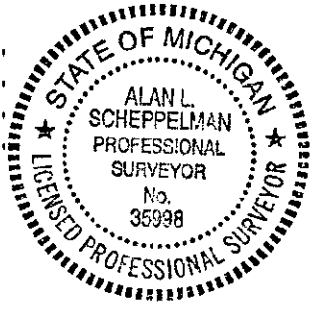

Signed by Alan L. Scheppelman  
Surveyor's Michigan License No. 35998

06/24/96