

Chairman Arden S. Pierson SW CORNER OF SECTION 26, SPRING ARBOR TWP.

Date Dec 20, 1994

LAND CORNER RECORDATION CERTIFICATE
 Filing Requirement of Act 74, Mich. P.A. 1970

For corners in

<u>Jackson</u> (County)	Located In:	Corner Code #
	3S 2W	I-11
1. Public Land Survey	T ___ R ___	<u>SURVEY &</u>
	T ___ R ___	<u>REMONUMENTATION</u>
	T ___ R ___	
	T ___ R ___	
2. Property Controlling in Section	S ___ T ___ R ___	<u>MAY 6 3 1995</u>
	S ___ T ___ R ___	
3. Miscellaneous Property in Sec.	S ___ T ___ R ___	<u>COMMISSION</u>
	S ___ T ___ R ___	
4. Lot No. _____, Recorded Plat _____		
5. Private Claims _____		

STATE OF MICHIGAN
 JACKSON COUNTY
 REGISTER

30 DEC 94 11:19 A.M.

Register of Deeds Stamp & File Number

	A	B	C	D	E	F	G	H	I	J	K	L	M
2	6	5	4	3	2	1							
3													
4	7	8	9	10	11	12							
5													
6	18	17	16	15	14	13							
7													
8	19	20	21	22	23	24							
9													
10	30	29	28	27	26	25							
11													
12	31	32	33	34	35	36							
13													

Arden S. Pierson PS September 13 94
 I, _____, in a field survey on _____, 19 _____, do hereby certify that under requirements of P.A. 74, Michigan P.A. of 1970, the corner points mentioned in lines 1 and 2 above were in conformance with regulations and rules therefore as required in the current manual of survey instructions of the United States Department of the Interior, Bureau of Land Management or by a decree of a Court of Law and/or that the corner points mentioned in lines 3, 4 and 5 above were in conformance with the rules of the Michigan Board of Land Surveyors or by a Decree of a Court of Law; established, re-established, monumented, re-monumented, recovered, found as expressed below:

NOTE: Not more than 4 corners, all in the same town and range, may be recorded on this certificate.

A. Description of original monument and accessories and/or subsequent restoration:

I-11 - Original survey by Lucius Lyon DS, 1825, County Surveyor records show he set a post as the corner with witnesses: 16" Hickory -S13°W- 79 links 18" Hickory -N53°E- 42 links County Surveyor records also show in a survey by H.F. Bean, dated May-June, 1886, that he set a fireclay post with witnesses: 14" White Oak -S89°W- 41 links (27.06') 12" White Oak -S60°E- 54 links (35.64')*

*(SEE BACK OF SHEET)

B. Description of corner evidence found and/or method applied in restoring or reestablishing corner:

Section 26, Spring Arbor Township

I-11 - Found 5/8" rod in monument box 2' West of centerline of road. Dug down and found the top 2/3 of fireclay surrounded by tile and brick 2' below surface - And accepted as a careful and faithful perpetuation of the location of the original corner. Replaced fireclay with Standard Jackson County Monument 3" below the top of monument box and placed fireclay on the North side of monument.

\$ 2.00 REMONUMENTATION
 \$ 9.00 CORNER REMONUMENTATION

C. Description of monument for corner and accessories established to perpetuate locating the position of the corner:

I-11 (SW corner of Section 26)
 Jackson County Monument

Witness sign post set -West- 30.0'
 Nail & tag #13039 N. side 23" Oak -S85°E- 29.52'
 Nail & tag #13039 NE side 23" Oak -S60°E- 36.28'*
 Nail & tag #13039 NE side 18" Oak -S45°E- 45.72'
 Nail & tag #13039 SW side 26" Oak -S25°E- 77.04'

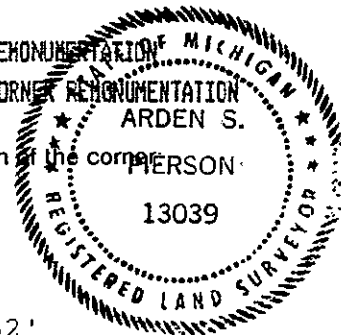

*Standard Jackson County Monument is a 1/2" iron rod 36" long with a Jackson County Remonumentation disk encased in a 4" concrete cylinder.

Signed by Arden S. Pierson Date November 1, 1994

Surveyor's Michigan License No. 13039

SW CORNER OF SECTION 26, SPRING ARBOR TOWNSHIP

Recorded in Liber 3, page 140, by Ronald W. Keller PS #20707, dated August 18, 1978. He shows he found a monument box but Did Not Witness Corner.

Jackson County Road Commission Records from May 25, 1993, the following the Witnesses:

28" Oak -N30°W- 74.39'
12" Oak -S45°W- 50.50'