

JACKSON COUNTY  
APPROVED LAND CORNER

P.A. 345 of 1990 CENTER OF SECTION 35, SPRING ARBOR TWP LIBER 1451 PAGE 167

Chairman Arden S. Pierson

Date Dec. 20, 1994

LAND CORNER RECORDATION CERTIFICATE  
Filing Requirement of Act 74, Mich. P.A. 1970

For corners in  
Jackson  
(County)

Located In: Corner Code #

- 1. Public Land Survey T 3S R 2W J-12
- T R
- T R
- T R
- 2. Property Controlling S T R
- in Section S T R
- 3. Miscellaneous S T R
- Property in Sec. S T R

**SURVEY &  
REMONUMENTATION**

**MAY 9 1995**

**COMMISSION**

STATE OF MICHIGAN  
JACKSON COUNTY  
RECORDED

30 DEC 94 11:20 A.M.

GERALD J. McBEVITT  
REGISTER OF DEEDS

Register of Deeds Stamp & File Number

- 4. Lot No. \_\_\_\_\_, Recorded Plat \_\_\_\_\_
- 5. Private Claims \_\_\_\_\_

	A	B	C	D	E	F	G	H	I	J	K	L	M
2	6	5	4	3	2	1							
3													
4	7	8	9	10	11	12							
5													
6	18	17	16	15	14	13							
7													
8	19	20	21	22	23	24							
9													
10	30	29	28	27	26	25							
11													
12	31	32	33	34	35	36							
13													

Arden S. Pierson PS, in a field survey on November 30, 1994, do hereby certify that under requirements of P.A. 74, Michigan P.A. of 1970, the corner points mentioned in lines 1 and 2 above were in conformance with regulations and rules therefore as required in the current manual of survey instructions of the United States Department of the Interior, Bureau of Land Management or by a decree of a Court of Law and/or that the corner points mentioned in lines 3, 4 and 5 above were in conformance with the rules of the Michigan Board of Land Surveyors or by a Decree of a Court of Law; established, re-established, monumented, re-monumented, recovered, found as expressed below:

**NOTE: Not more than 4 corners, all in the same town and range, may be recorded on this certificate.**

A. Description of original monument and accessories and/or subsequent restoration:

J-12 - Not set in original survey.

Recorded in Liber 3, page 141, by Ronald W. Keller, dated August 18, 1978. He shows in a sketch that he used the center of Section 35.

Jackson County Road Commission Records show the following Witnesses for J-12: Axle shaft with tile & stones raised w/ 1/2" iron

- 20" Oak -S55°E- 55.07'\*
- 24" Oak -S25°W- 34.65'
- 40" Oak -S50°W- 57.48'
- 14" Oak -N40°E- 50.47'

B. Description of corner evidence found and/or method applied in restoring or reestablishing corner:

**Section 35, Spring Arbor Township \$ 7.00 CORNER REMONUMENTATION**

J-12 - Intersected lines from opposite quarter-section corners excavated to set Standard Jackson County Monument and found 1/2" pipe over furnace grate (buried 30") 0.30 feet NE of monument location. Corner is in centerline of Sears Road, in line with fence line South.

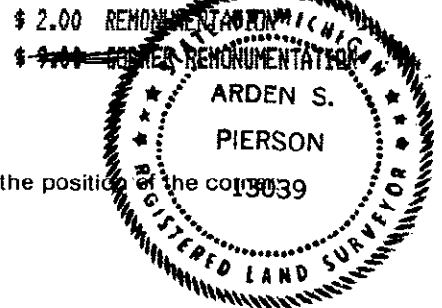

C. Description of monument for corner and accessories established to perpetuate locating the position of the corner:

J-12 (Center corner Section 35)  
Jackson County Monument

- Witness sign post set -South- 30.0'
- Nail & tag #13039 in W. side 18" Walnut -N44°E- 42.45'
- Nail & tag #13039 in W. side 28" Oak -S36°W- 34.68'
- Nail & tag #13039 in W. side 13" Walnut -S10°W- 43.52'
- Nail & tag #13039 in SW side 29" Oak -S55°E- 56.17'\*

\*Standard Jackson County Monument is a 1/2" iron rod 36" long with a Jackson County Remonumentation disk encased in a 4" concrete cylinder.

Signed by Arden S. Pierson

Date December 1, 1994

Surveyor's Michigan License No. 13039