

**JACKSON COUNTY
APPROVED LAND CORNER
P.A. 344 of 1990**

EAST 1/4 POST, SECTION 13, CONCORD TOWNSHIP

Chairman Alan L. Schepelman
Date Nov. 13, 1996

**LAND CORNER RECORDATION CERTIFICATE
Filing Requirement of Act 74, Mich. P.A. 1970**

#2022271
Liber 1533 Page 168
Page 1 of 1
Jackson Co., MI
Recorded
12/11/96 11:31A
Jerry McDevitt
Register of Deeds

For corners in

Jackson (County)	Located In:	Corner Code #
1. Public Land Survey	T 3S R3W	M-6
	T _____ R _____	_____
	T _____ R _____	_____
	T _____ R _____	_____
2. Property Controlling in Section	S _____ T _____ R _____	_____
	S _____ T _____ R _____	_____
3. Miscellaneous Property in Sec.	S _____ T _____ R _____	_____
	S _____ T _____ R _____	_____
4. Lot No. _____, Recorded Plat _____		
5. Private Claims _____		

Register of Deeds Stamp & File Number

Alan L. Schepelman in a field survey on May 29, 1996
do hereby certify that under requirements of P.A. 74, Michigan P.A. of 1970, the corner points mentioned
in lines 1 and 2 above were in conformance with regulations and rules therefore as required in the
current manual of survey instructions of the United States Department of the Interior, Bureau of Land
Management or by a decree of a Court of Law and/or that the corner points mentioned in lines 3, 4 and 5
above were in conformance with the rules of the Michigan Board of Land Surveyors or by a Decree of a
Court of Law; established, re-established, monumented, re-monumented, recovered, found as
expressed below:

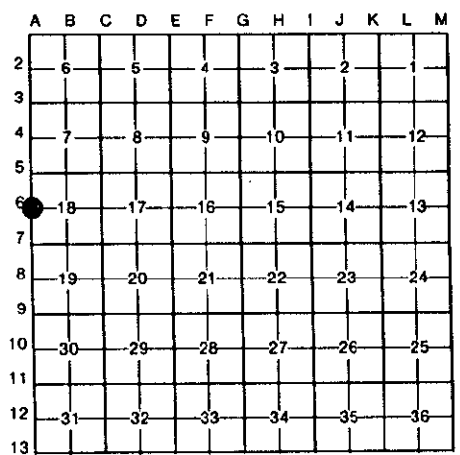

NOTE: Not more than 4 corners, all in the same town and range, may be recorded on this certificate.

A. Description of original monument and accessories and/or subsequent restoration:

LUCIUS LYON, D.S. 40.00 SET QUARTER SECTION POST
RESURVEYED, 1825 W. OAK 14, S5 1/2 W 13.36 (881.76') AND NO OTHER TREE
(RAN LINE NORTH - SOUTH, BACKWARDS)

B. Description of corner evidence found and/or method applied in restoring or reestablishing corner:

CORNER FALLS IN THE CENTER OF AN EAST-WEST DRAIN. SINGLE PROPORTIONED
BETWEEN M-5 AND M-7 FOR THE CORNER POSITION. SET 1" X 60" ALUMINUM
PIPES 50.00' NORTH AND SOUTH ON THE SECTION LINES. NO CORNER WAS SET
AT M-6 BECAUSE OF THE DRAIN.

*REFERENCE MONUMENTS ARE 1" X 60" ALUMINUM PIPES WITH JACKSON COUNTY
REMONUMENTATION CAP STAMPED "M-6 REF-1 (2) T3S R3W LS 35998".

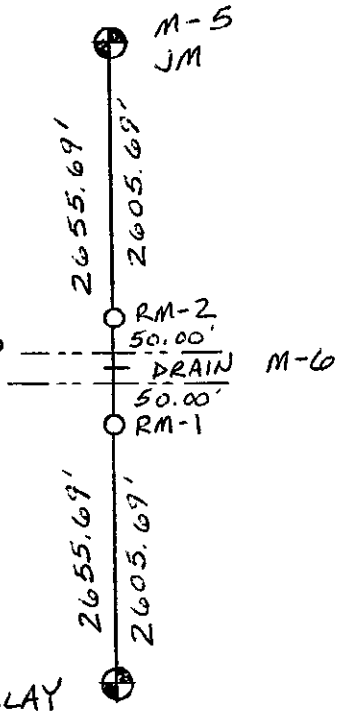

C. Description of monument for corner and accessories established to perpetuate locating the position of the corner:

M-6 IN IS DRAIN

REFERENCE MONUMENT-1, SOUTH ON THE SECTION LINE	50.00'
S45°E NAIL & TAG #35998 IN NW SIDE OF 14" ELM	22.49'
NORTH SOUTH EDGE OF WATER OF DRAIN	33.4'
EAST SURVEY MARKER SIGN POST	1.0'
REFERENCE MONUMENT-2, NORTH ON THE SECTION LINE	50.00'
SOUTH NORTH EDGE OF WATER OF DRAIN	43.0'
EAST SURVEY MARKER SIGN POST	1.0'

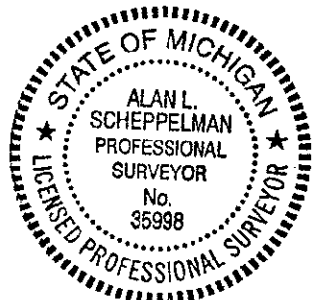

Signed by Alan L. Schepelman Date 12/09/96

Surveyor's Michigan License No. 35998