

LAND CORNER RECORDATION CERTIFICATE  
 Filing Requirement of Act 74, Mich. P.A. 1970

STATE OF MICHIGAN  
 JACKSON COUNTY  
 RECORDED

30 DEC 94 11:22 A.M.

GERALD J. McDEWITT  
 REGISTER OF DEEDS

For corners in  
Jackson  
 (County)

Located In: Corner Code #

- |                                    |                         |             |
|------------------------------------|-------------------------|-------------|
| 1. Public Land Survey              | T <u>3S</u> R <u>2W</u> | <u>M-13</u> |
|                                    | T <u>3S</u> R <u>1W</u> | <u>A-13</u> |
|                                    | T <u>4S</u> R <u>2W</u> | <u>M-1</u>  |
|                                    | T <u>4S</u> R <u>1W</u> | <u>A-1</u>  |
| 2. Property Controlling in Section | S _____ T _____ R _____ | _____       |
|                                    | S _____ T _____ R _____ | _____       |
| 3. Miscellaneous Property in Sec.  | S _____ T _____ R _____ | _____       |
|                                    | S _____ T _____ R _____ | _____       |

**SURVEY & REMONUMENTATION**

Register of Deeds Stamp & File Number

4. Lot No. \_\_\_\_\_, Recorded Plat \_\_\_\_\_  
 5. Private Claims \_\_\_\_\_

MAY 09 1996

COMMISSION

	A	B	C	D	E	F	G	H	I	J	K	L	M
2	6	5	4	3	2	1							
3													
4	7	8	9	10	11	12							
5													
6	18	17	16	15	14	13							
7													
8	19	20	21	22	23	24							
9													
10	30	29	28	27	26	25							
11													
12	31	32	33	34	35	36							
13													

I, Arden S. Pierson PSn a field survey on November 1, 19 94, do hereby certify that under requirements of P.A. 74, Michigan P.A. of 1970, the corner points mentioned in lines 1 and 2 above were in conformance with regulations and rules therefore as required in the current manual of survey instructions of the United States Department of the Interior, Bureau of Land Management or by a decree of a Court of Law and/or that the corner points mentioned in lines 3, 4 and 5 above were in conformance with the rules of the Michigan Board of Land Surveyors or by a Decree of a Court of Law; established, re-established, monumented, re-monumented, recovered, found as expressed below:

NOTE: Not more than 4 corners, all in the same town and range, may be recorded on this certificate.

A. Description of original monument and accessories and/or subsequent restoration:

M-13 - Original survey by Joseph Wampler DS, 1824, (PAGES 573-575 GLO Notes) H.F. Bean, Surveyor notes 1886, Pages 608 and 609 GLO notes - Book Post and two witnesses standing  
 10" Swamp Oak - N71°E - 105 1/2 links (69.63')  
 10' Maple - S41 1/2°E - 72 links (47.52')

SEE BACK OF SHEET

\$ 2.00 REMONUMENTATION

\$ 9.00 CORNER REMONUMENTATION

B. Description of corner evidence found and/or method applied in restoring or reestablishing corner:

Section 36, Spring Arbor Township

M-13 - Found Iron & cap #20707 - 1' West and 6' North of intersection of Thorne and Kimmel Roads. Excavated below and found large blue stone with (2) 1/2" pipes on East side - Removed stone and found fireclay intact. Accepted the fireclay as a careful and faithful perpetuation of the position of the original corner. Replaced fireclay with Standard Jackson County Monument 3" ball road surface.

C. Description of monument for corner and accessories established to perpetuate locating the position of the corner:

M-13 (SE corner of Section 36)

Jackson County Monument

- Witness sign post set -West- 31.0'
- Nail & tag #13039 E. side 19" Walnut -N14°W- 98.89'
- Nail & tag #13039 W. side 11" Hickory -N22°E- 76.11'
- Nail & tag #13039 W side 18" Walnut -S08°E- 104.53'
- Nail & tag #13039 NE side 7" Ash -S50°E- 63.56'

(THIS CORNER IS COMMON TO ADJOINING TOWNSHIPS)

\*Standard Jackson County Monument is a 1/2" iron rod 36" long with a Jackson County Remonumentation disk encased in a 4" concrete cylinder.

Signed by Arden S. Pierson Date November 1, 1994

Surveyor's Michigan License No. 13039

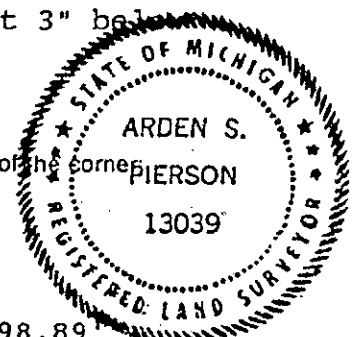

**SE CORNER SECTION 36, SPRING ARBOR TOWNSHIP M-13**

Certification by H.F. Bean. surveyor (page 620 GLO notes - Book ).  
"post set are fireclay, three inches in diameter and two feet  
long"

**JACKSON COUNTY ROAD COMMISSION**

Notes record the following witnesses for this corner

- 10" Walnut - S12°E - 104.30'
- 14" Butternut - N75°W - 43.09'
- 10" Oak - N12°E - 109.56'
- 10" Locust - N12°W - 99.12'