

**SURVEY &
REMONUMENTATION**

MAY 10 1999

KALKASKA COUNTY, MICHIGAN
RECEIVED

SECTION

LAND CORNER RECORDATION CERTIFICATE
Filing Requirement of Act 74, Mich. P.A. 1970

1994 DEC 23 AM 9:26

corners in

KALKASKA	Located In:	Corner Code #
(County)		
1994 REMONUMENTATION		
Public Land Survey	T 27N R 6W	L-9
	T _____ R _____	_____
	T _____ R _____	_____
	T _____ R _____	_____
Property Controlling	S _____ T _____ R _____	_____
in Section	S _____ T _____ R _____	_____
Miscellaneous	S _____ T _____ R _____	_____
Property in Sec.	S _____ T _____ R _____	_____

Joan Hall
REG. OF DEEDS

Register of Deeds Stamp & File Number

Lot No. _____, Recorded Plat _____
Private Claims _____

EUGENE FARRIER, in a field survey on NOV. 12, 1994, hereby certify that under requirements of P.A. 74, Michigan P.A. of 1970, the corner points mentioned in lines 1 and 2 above were in conformance with regulations and rules therefore as required in the recent manual of survey instructions of the United States Department of the Interior, Bureau of Land Management or by a decree of a Court of Law and/or that the corner points mentioned in lines 3, 4 and 5 above were in conformance with the rules of the Michigan Board of Land Surveyors or by a Decree of a Court of Law; established, re-established, monumented, re-monumented, recovered, found as assessed below:

	A	B	C	D	E	F	G	H	I	J	K	L	M
2	6	5	4	3	2	1							
3													
4	7	8	9	10	11	12							
5													
6	18	17	16	15	14	13							
7													
8	19	20	21	22	23	24							
9													
10	30	29	28	27	26	25							
11													
12	31	32	33	34	35	36							
13													

NOTE: Not more than 4 corners, all in the same town and range, may be recorded on this certificate.

Description of original monument and accessories and/or subsequent restoration:

L-9: Cor. common to Sec. 24 & 25, T27N-R6W
1850 GLO re-survey: set post, Beech 10", N52W, 15, Beech 14", S47E, 39
6-3-1889, E. Mosher, noted cor., no accessories
1936, MDOT, Right-of-way map, noted cor., no accessories
2-93, Wilcox Assoc., noted cor., no accessories

Description of corner evidence found and/or method applied in restoring or reestablishing corner:

L-9: Cor. common to Sec. 24 & 25, T27N-R6W
Set 5/8" x 36" R.B. w/alu. cap 0.4' above ground surface, looked for cor. 6' E. did not find. *set by S.P.*
On 12-20-94 the Kalkaska Co. peer group approved the above monument as a careful and faithful reestablishment of the position of the original corner.

Ratified by Peer Group
P.A. 345-1990 Kalkaska County

Chairman *Eugene Farrier*

Date 12-20-94

Description of monument for corner and accessories established to perpetuate locating the position of the corner:

L-9: Cor. common to Sec. 24 & 25, T27N-R6W
Set 5/8" x 36" R.B. w/alu. cap 0.4' above ground surface, looked for cor. 6' E. did not find.
N10W, 72.05', set nail & tag 8" Maple in clump
N13E, 73.65', set nail & tag 4" Beech
N30E, 76.95', set nail & tag 6" Maple
N86E, 76.26', set nail & tag 6" Maple in clump
Cor. is 55' +/- N. C/L M-72.

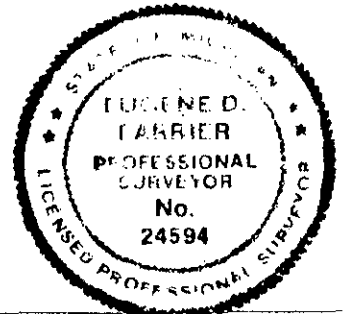

Surveyed by *Eugene Farrier*

Date 12-22-94

Surveyor's Michigan License No. 24594