

SURVEY & REMONUMENTATION

MAR 03 1998

KENT COUNTY REMONUMENTATION

LAND CORNER RECORDATION CERTIFICATE
Filing Requirement of Act 74, Mich. P.A. 1970

SECTION

For corners in

KENT COUNTY

(County)

Located In:

Corner Code #

1. Public Land Survey	T <u>5N</u>	R <u>9W</u>	<u>E-7</u>
	T	R	
	T	R	
	T	R	
2. Property Controlling in Section	S	T	R
	S	T	R
3. Miscellaneous Property in Sec.	S	T	R
	S	T	R

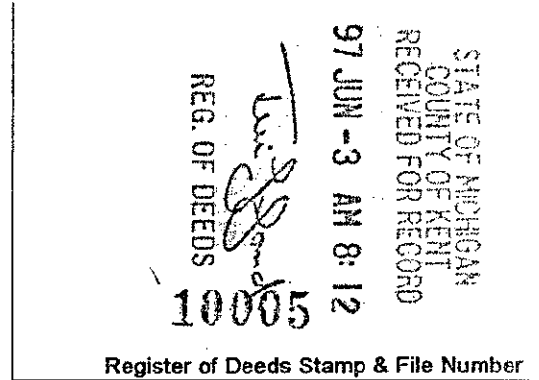

4. Lot No. _____, Recorded Plat _____
5. Private Claims _____

I, Kirk Breitels, in a field survey on Apr. 14, 1997 do hereby state that under requirements of P.A. 74, Michigan P.A. of 1970, the corner points mentioned in lines 1 and 2 above were in conformance with regulations and rules therefore as required in the current manual of survey instructions of the United States Department of the Interior, Bureau of Land Management or by a decree of a Court of Law and/or that the corner points mentioned in lines 3, 4 and 5 above were in conformance with the rules of the Michigan Board of Land Surveyors or by a Decree of a Court of Law, established, re-established, monumented, recovered, found as expressed below:

A	B	C	D	E	F	G	H	I	J	K	L	M
1												
2	6		5		4		3		2			
3												
4	7		8		9		10		11		12	
5												
6	18		17		16		15		14		13	
7												
8	19		20		21		22		23		24	
9												
10	30		29		28		27		26		25	
11												
12	31		32		33		34		35		36	
13												

NOTE: Not more than 2 corners, all in the same town and range, may be recorded on this certificate.

A. Description of original monument and accessories and/or subsequent restoration:

E-7	1830	GLO	Mullett	Set Post
	1966	Kent Co. Wit.		1" Iron
	1975	LCRC #845	Nederveld	1/2" Iron in Mon. Box
	1981	LCRC #2487	Bonnema	Set Kent County Monument in Mon. Box
	1990	LCRC #5360	Starr	Kent County Monument

The position of this corner was previously approved by the Kent County Remonumentation Peer Group, monumented by Douglas W. Bonnema on 11/25/81 and was recorded per LCRC #2487

B. Description of corner evidence found and/or method applied in restoring or reestablishing corner:

E-7 Found standard Kent Co. Mon. (Harrison) per witnesses from above LCRC as set by Douglas W. Bonnema in place of the 3/4" Iron he found inside a Mon. Box. Said Iron checks with Kent Co. Wit., LCRC #845 and Exxel Eng. records.

<u>LCRC #2487</u>		<u>LCRC #5360</u>
KC tag 10" Elm	S25°W 74.88'	Nail & tag 14" Elm S25°W 74.53' "X" on culv.
KC tag 10" Elm	N45°W 50.68'	Nail & tag post N04°E 35.57' N78°E 82.70'
KC tag 24" Willow	N25°E 86.85'	Nail & tag 10" Elm N44°W 50.68'
PK & KC tag top curb	S20°E 44.50'	Nail & tag 10" Elm N58°E 81.46'
"X" to culv.	N75°E 82.74'	Nail & tag Quad 12" Apple S13°E 126.91'

The selected location is accepted by me and is generally accepted by professional surveyors as the best available evidence of the position of the original corner.

C. Description of monument for corner and accessories established to perpetuate locating the position of the corner:

E-7	Standard Kent County Monument
	Nail & KC Remon. tag E. side 18" Elm S25°W 74.46'
	Nail & KC Remon. tag W. side RR tie post N04°E 35.54'
	Nail & KC Remon. tag SW side 10" Stump N44°W 50.64'
	Nail & KC Remon. tag NW side 15" Elm N58°E 81.74'
	"X" cut on top N. end conc. culv. N78°E 82.70'
	Capped Rerod (MYK) S40°E 47.18'
	On C/L asphalt roads E-W & S

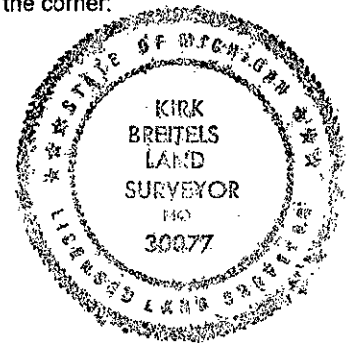

Signed by Kirk Breitels
Surveyor's Michigan License No. 30077

Date 5/22/97

P.A. 345 1990 KENT COUNTY

PEER APPROVED 5/22/97

CHAIRMAN Harry Hubert