

SURVEY & REMONUMENTATION

MAR 03 1998

KENT COUNTY REMONUMENTATION

LAND CORNER RECORDATION CERTIFICATE
Filing Requirement of Act 74, Mich. P.A. 1970

SECTION

For corners in
KENT COUNTY
(County)

Located In:	Corner Code #
T <u>5N</u> R <u>9W</u>	<u>E-12</u>
T <u> </u> R <u> </u>	<u> </u>
T <u> </u> R <u> </u>	<u> </u>
T <u> </u> R <u> </u>	<u> </u>
S <u> </u> T <u> </u> R <u> </u>	<u> </u>
S <u> </u> T <u> </u> R <u> </u>	<u> </u>
S <u> </u> T <u> </u> R <u> </u>	<u> </u>

STATE OF MICHIGAN
COUNTY OF KENT
RECEIVED FOR RECORD
97 APR 29 AM 8:18
REG. OF DEEDS
Eric J. Bond

9735

Register of Deeds Stamp & File Number

4. Lot No. _____, Recorded Plat _____
5. Private Claims _____

I, Kirk Breitels, in a field survey on Jan. 28, 1997 do hereby state that under requirements of P.A. 74, Michigan P.A. of 1970, the corner points mentioned in lines 1 and 2 above were in conformance with regulations and rules therefore as required in the current manual of survey instructions of the United States Department of the Interior, Bureau of Land Management or by a decree of a Court of Law and /or that the corner points mentioned in lines 3, 4 and 5 above were in conformance with the rules of the Michigan Board of Land Surveyors or by a Decree of a Court of Law; established, re-established, monumented, recovered, found as expressed below:

NOTE: Not more than 2 corners, all in the same town and range, may be recorded on this certificate.

A	B	C	D	E	F	G	H	I	J	K	L	M
1												
2	6	5	4	3	2	1						
3												
4	7	8	9	10	11	12						
5												
6	18	17	16	15	14	13						
7												
8	19	20	21	22	23	24						
9												
10	30	29	28	27	26	25						
11												
12	31	32	33	34	35	36						
13												

A. Description of original monument and accessories and/or subsequent restoration:

E-12	1830	GLO	Mullett	Set Post
	1972	LCRC #260	Bonnema	Set 3/4" Iron
	1980	LCRC #1500	Merdzinski	Set Kent County Monument
	1990	LCRC #5365	Starr	Kent County Monument

The position of this corner was previously approved by the Kent County Remonumentation Peer Group, monumented by John A. Merdzinski on 12/9/80 and was recorded per LCRC #1500

B. Description of corner evidence found and/or method applied in restoring or reestablishing corner:

E-12 Found standard Kent Co. Mon. (Harrison) per witnesses from above LCRC as set by John A. Merdzinski in place of a 3/4" Iron he found. Said Iron checks with LCRC #260.

LCRC #1500	LCRC #5365
Nail & tag 24" Oak N85°W 39.07'	Nail & tag 28" Oak N86°W 39.00'
Nail & tag 24" Ash N40°E 40.61'	Nail & tag Tri. 8"-10"-12" Poplar N45°W 26.95'
Nail & tag 26" Oak N80°E 54.63'	Nail & tag 24" Ash N44°E 40.64'
Nail & tag 24" Oak S10°W 31.60'	Nail & tag 10" Poplar S14°E 25.31'
Nail & tag 6" Oak S40°W 49.56'	Nail & tag 24" Oak S13°W 31.86'
Nail & tag 4" Maple S65°W 57.60'	Nail & tag 8" Oak S40°W 49.61'

The selected location is accepted by me and is generally accepted by professional surveyors as the best available evidence of the position of the original corner.

C. Description of monument for corner and accessories established to perpetuate locating the position of the corner:

E-12 Standard Kent County Monument	
Nail & KC Remon. tag N. side 32" Oak	N86°W 39.00'
Nail & KC Remon. tag SW side Tri. 8"-10"-12" Poplar	N45°W 26.92'
Nail & KC Remon. tag SE side 24" Ash	N44°E 40.64'
Nail & KC Remon. tag E. side 14" Poplar	S14°E 25.31'
Nail & KC Remon. tag E. side 28" Oak	S13°W 31.68'
Nail & KC Remon. tag NW side 10" Oak	S40°W 49.64'
C/L creek: East 23'± & North 11'± & West 31'±	

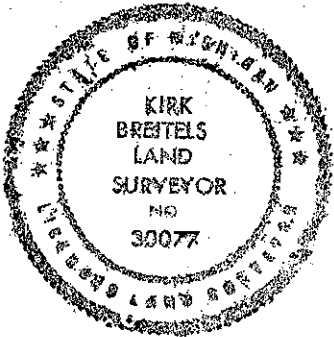

Signed by *Kirk Breitels*
Surveyor's Michigan License No. 30077

Date 3/27/97

P.A. 345 1990 KENT COUNTY
PEER APPROVED 3/27/97
CHAIRMAN *Harry Hubert*