

1/2  
**SURVEY &  
 REMONUMENTATION**

MAR 03 1998

KENT COUNTY REMONUMENTATION

**LAND CORNER RECORDATION CERTIFICATE**  
 Filing Requirement of Act 74, Mich. P.A. 1970

For corners in SECTION  
 KENT COUNTY

Located In:	Corner Code #
1. Public Land Survey T 5N R 9W	F-12
T R	
T R	
T R	
2. Property Controlling in Section S T R	
S T R	
3. Miscellaneous S T R	
Property in Sec. S T R	

STATE OF MICHIGAN  
 COUNTY OF KENT  
 RECEIVED FOR RECORD  
 97 NOV 13 PM 1:00  
 REG. OF DEEDS  
*Lucy Stand*

10265

Register of Deeds Stamp & File Number

4. Lot No. \_\_\_\_\_, Recorded Plat \_\_\_\_\_  
 5. Private Claims \_\_\_\_\_

I, Kirk Breitels, in a field survey on Sept. 3, 1997 do hereby state that under requirements of P.A. 74, Michigan P.A. of 1970, the corner points mentioned in lines 1 and 2 above were in conformance with regulations and rules therefore as required in the current manual of survey instructions of the United States Department of the Interior, Bureau of Land Management or by a decree of a Court of Law and /or that the corner points mentioned in lines 3, 4 and 5 above were in conformance with the rules of the Michigan Board of Land Surveyors or by a Decree of a Court of Law; established, re-established, monumented, recovered, found as expressed below:

NOTE: Not more than 2 corners, all in the same town and range, may be recorded on this certificate.

	A	B	C	D	E	F	G	H	I	J	K	L	M
1													
2	6		5		4		3		2		1		
3													
4	7		8		9		10		11		12		
5													
6	18		17		16		15		14		13		
7													
8	19		20		21		22		23		24		
9													
10	30		29		28		27		26		25		
11													
12	31		32		33		34		35		36		
13													

A. Description of original monument and accessories and/or subsequent restoration:

F-12 1830---GLO---Not Set  
 Williams & Works---No information  
 Kent Co. Wits.---Iron (per Exxel)  
 8" Maple NW 43.1' 20" Maple NNE 27.15' 10" Basswood NE 63.9'  
 1990---Survey---Nederveld---Shows Iron 2618.70' North of S 1/4 cor.

P.A. 345 1990 KENT COUNTY  
 PEER APPROVED 9/25/97  
 CHAIRMAN *Humphreys*

B. Description of corner evidence found and/or method applied in restoring or reestablishing corner:

F-12 Found Capped Rerod (Nederveld) 0.3' N. & 0.2' W. of Intersection of 1/4 lines.  
 Survey information by Exxel Engineering indicates an intersection of 1/4 lines (± to Iron found), but witnesses per Kent Co. Wit. map are all gone or for another corner.

Measured S 1/4 to Capped Rerod: 2618.64' - 2618.70' Nederveld

The Capped Rerod (Nederveld) is accepted by me and is generally accepted by professional surveyors as the best available evidence of the position of the corner.

C. Description of monument for corner and accessories established to perpetuate locating the position of the corner:

F-12 Set Standard Kent Co. Monument (Harrison) in place of the Capped Rerod (Nederveld)  
 Nail & KC Remon. tag N. side 15" & 30" Maple N70°W 24.44'  
 Nail & KC Remon. tag E. side 10"-30" clust. Maples N10°W 30.90'  
 Nail & KC Remon. tag SE side 36" Sycamore N40°E 67.26'  
 Nail & KC Remon. tag N. side 24" Sycamore N80°E 42.59'  
 E-W fence is N. 21'±  
 Mon. at N. bank Coldwater River

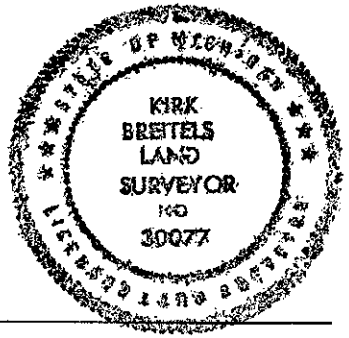

Signed by *Kirk Breitels*  
 Surveyor's Michigan License No. 30077

Date 10/30/97