

SURVEY & REMONUMENTATION

MAR 03 1998

KENT COUNTY REMONUMENTATION

SECTION

LAND CORNER RECORDATION CERTIFICATE
Filing Requirement of Act 74, Mich. P.A. 1970

For corners in
KENT COUNTY
(County)

Located In:	Corner Code #
T <u>5N</u> R <u>9W</u>	<u>G-4</u>
T _____ R _____	_____
T _____ R _____	_____
T _____ R _____	_____
S _____ T _____ R _____	_____
S _____ T _____ R _____	_____
S _____ T _____ R _____	_____
S _____ T _____ R _____	_____

STATE OF MICHIGAN
COUNTY OF KENT
RECEIVED FOR RECORD
97 JUN -3 AM 8:12
REG. OF DEEDS
Luci S. Bond

10011

Register of Deeds Stamp & File Number

4. Lot No. _____, Recorded Plat _____
5. Private Claims _____

I, Kirk Breitels, in a field survey on Apr. 15, 1997 do hereby state that under requirements of P.A. 74, Michigan P.A. of 1970, the corner points mentioned in lines 1 and 2 above were in conformance with regulations and rules therefore as required in the current manual of survey instructions of the United States Department of the Interior, Bureau of Land Management or by a decree of a Court of Law and /or that the corner points mentioned in lines 3, 4 and 5 above were in conformance with the rules of the Michigan Board of Land Surveyors or by a Decree of a Court of Law; established, re-established, monumented, recovered, found as expressed below:

A	B	C	D	E	F	G	H	I	J	K	L	M
1												
2	6	5	4	3	2	1						
3												
4	7	8	9	10	11	12						
5												
6	18	17	16	15	14	13						
7												
8	19	20	21	22	23	24						
9												
10	30	29	28	27	26	25						
11												
12	31	32	33	34	35	36						
13												

NOTE: Not more than 2 corners, all in the same town and range, may be recorded on this certificate.

A. Description of original monument and accessories and/or subsequent restoration:

G-4	1830	GLO	Mullett	Set Post
	1928	Kent Co. Wit.		1" Iron
	1977	LCRC #1103	Glaza	5/8" Iron in Mon. Box
	1980	LCRC #1336	Byl	Mon. Box
	1981	LCRC #2239	Jonker	Set Kent County Monument in Mon. Box
	1990	LCRC #5375	Starr	Kent County Monument

The position of this corner was previously approved by the Kent County Remonumentation Peer Group, monumented by Robert J. Jonker on 11/6/81 and was recorded per LCRC #2239

B. Description of corner evidence found and/or method applied in restoring or reestablishing corner:

G-4 Found standard Kent Co. Mon. (Harrison) per witnesses from above LCRC as set by Robert J. Jonker in place of the 5/8" Iron over a 1" Iron he found inside a Mon. Box. Both Irons check with Kent Co. Wit. and LCRC's #1103 & #1336.

<u>LCRC #2239</u>	<u>LCRC #5375</u>
Remon. tag 8" Cherry N90°W 47.75'	Nail & tag 10" Cherry N90°W 47.58'
Remon. tag P. Pole N30°W 101.72'	Nail & tag P. Pole N30°W 101.72'
Remon. tag 8" Maple S28°W 115.48'	Nail & tag 12" Maple S28°W 115.46'
Remon. tag fence post 61.66'	Nail & tag fence post N60°E 61.84'

The selected location is accepted by me and is generally accepted by professional surveyors as the best available evidence of the position of the original corner.

C. Description of monument for corner and accessories established to perpetuate locating the position of the corner:

G-4	Standard Kent County Monument		
	Nail & KC Remon. tag S. side 14" Cherry	N90°W	47.54'
	Nail & KC Remon. tag NE side P. Pole	N30°W	101.72'
	Nail & KC Remon. tag E. side Tw. 14" Maple	S28°W	115.36'
	Nail & KC Remon. tag S. side leaning fence post	N60°E	61.95'
	SW corner concrete headwall	N30°E	56.88'
	C/L N-S blacktop road is 1.5'± West		

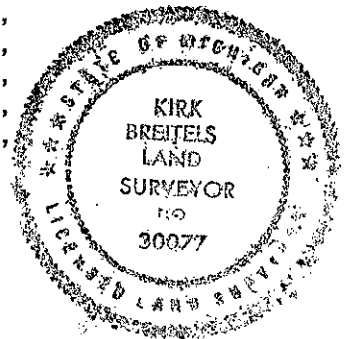

Signed by *Kirk Breitels*

Date 5/22/97

Surveyor's Michigan License No. 30077
P.A. 345 1990 KENT COUNTY
PEER APPROVED 5/22/97
CHAIRMAN *Harry Stuber*