

SURVEY & REMONUMENTATION

MAR 03 1998

KENT COUNTY REMONUMENTATION

LAND CORNER RECORDATION CERTIFICATE
Filing Requirement of Act 74, Mich. P.A. 1970

STATE OF MICHIGAN
COUNTY OF KENT
RECEIVED FOR RECORD
97 APR 29 AM 8:19

REG. OF DEEDS

Handwritten signature

9753

Register of Deeds Stamp & File Number

SECTION

For corners in

KENT COUNTY
(County)

Located In:

Corner Code #

- | | | | | | |
|------------------------------------|---|----|---|----|------|
| 1. Public Land Survey | T | 5N | R | 9W | H-11 |
| | T | | R | | |
| | T | | R | | |
| | T | | R | | |
| 2. Property Controlling in Section | S | | R | | |
| | S | | R | | |
| 3. Miscellaneous Property in Sec. | S | | R | | |
| | S | | R | | |

4. Lot No. _____, Recorded Plat _____
5. Private Claims _____

I, Kirk Breitels, in a field survey on Feb. 5, 1997 do hereby state that under requirements of P.A. 74, Michigan P.A. of 1970, the corner points mentioned in lines 1 and 2 above were in conformance with regulations and rules therefore as required in the current manual of survey instructions of the United States Department of the Interior, Bureau of Land Management or by a decree of a Court of Law and/or that the corner points mentioned in lines 3, 4 and 5 above were in conformance with the rules of the Michigan Board of Land Surveyors or by a Decree of a Court of Law; established, re-established, monumented, recovered, found as expressed below:

NOTE: Not more than 2 corners, all in the same town and range, may be recorded on this certificate.

	A	B	C	D	E	F	G	H	I	J	K	L	M
1													
2	6		5		4		3		2		1		
3													
4	7		8		9		10		11		12		
5													
6	18		17		16		15		14		13		
7													
8	19		20		21		22		23		24		
9													
10	30		29		28		27		26		25		
11													
12	31		32		33		34		35		36		
13													

A. Description of original monument and accessories and/or subsequent restoration:

H-11	1830	GLO	Mullett	Set Post
		Kent Co. Wit.		Iron
	1974	LCRC #759	Bonnema	3/4" Iron
		LCRC #2244	Jonker	Set Kent County Monument
	1994	LCRC #7008	Byl	Kent County Monument

The position of this corner was previously approved by the Kent County Remonumentation Peer Group, monumented by Robert J. Jonker on 11/6/81 and was recorded per LCRC #2244

B. Description of corner evidence found and/or method applied in restoring or reestablishing corner:

H-11 Found standard Kent Co. Mon. (Harrison) per witnesses from above LCRC as set by Robert J. Jonker in place of the 3/4" Iron over a Pointed Stone he found. Said Iron and Stone check with Kent Co. Wit. and LCRC #759.

<u>LCRC #2244</u>		<u>LCRC #7008</u>
Remon. tag P. Pole	S50°W 87.66'	Nail & tag P. Pole S50°W 86.24'
Remon. tag 36" Maple	N66°W 71.42'	Nail & tag 36" Maple N66°W 71.53'
Remon. tag 36" Maple	N12°W 27.86'	Nail & tag 36" Maple N12°W 27.88'
Remon. tag 12" Walnut	N57°E 54.74'	Nail & tag 12" Walnut N57°E 54.74'
		Nail & tag P. Pole S25°E 62.35'

The selected location is accepted by me and is generally accepted by professional surveyors as the best available evidence of the position of the original corner.

C. Description of monument for corner and accessories established to perpetuate locating the position of the corner:

H-11 Standard Kent County Monument			
Nail & KC Remon. tag SE side P. Pole	S50°W	86.22'	
Nail & KC Remon. tag SW side 38" Maple	N66°W	71.51'	
Nail & KC Remon. tag E. side 38" Maple	N12°W	27.88'	
Nail & KC Remon. tag NW side 14" Walnut	N57°E	54.74'	
Nail & KC Remon. tag E. side P. Pole	S25°E	62.33'	
C/L "X" Asph. Rd. is 0.5'± South			

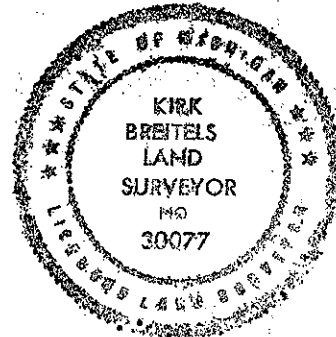

Signed by

Handwritten signature of Kirk Breitels

Date

3/27/97

Surveyor's Michigan License No. 30077

P.A. 345 1990 KENT COUNTY

PEER APPROVED 3/27/97

CHAIRMAN *Handwritten signature*