

SURVEY & REMONUMENTATION

MAR 03 1998

KENT COUNTY REMONUMENTATION

SECTION

LAND CORNER RECORDATION CERTIFICATE
Filing Requirement of Act 74, Mich. P.A. 1970

For corners in

KENT COUNTY

(County)

Located In:

Corner Code #

1. Public Land Survey

T 5N R 9W

I-1

T	R	
T	R	
T	R	
T	R	
S	T	R
S	T	R
S	T	R
S	T	R

2. Property Controlling in Section

3. Miscellaneous Property in Sec.

4. Lot No. _____, Recorded Plat _____

5. Private Claims _____

I, Kirk Breitels, in a field survey on June 5, 1997 do hereby state that under requirements of P.A. 74, Michigan P.A. of 1970, the corner points mentioned in lines 1 and 2 above were in conformance with regulations and rules therefore as required in the current manual of survey instructions of the United States Department of the Interior, Bureau of Land Management or by a decree of a Court of Law and/or that the corner points mentioned in lines 3, 4 and 5 above were in conformance with the rules of the Michigan Board of Land Surveyors or by a Decree of a Court of Law; established, re-established, monumented, recovered, found as expressed below:

NOTE: Not more than 2 corners, all in the same town and range, may be recorded on this certificate.

	A	B	C	D	E	F	G	H	I	J	K	L	M
1													
2	6		5		4		3		2		1		
3													
4	7		8		9		10		11		12		
5													
6	18		17		16		15		14		13		
7													
8	19		20		21		22		23		24		
9													
10	30		29		28		27		26		25		
11													
12	31		32		33		34		35		36		
13													

A. Description of original monument and accessories and/or subsequent restoration:

- I-1 1830---GLO---Mullett---Set Post, 74 links (48.84') East of I-13, T6N, R9W
- 1918---Williams & Works---Found Stone
- 1954---Williams & Works---Found Stone (tipped over)-Set Iron
 - 14" dbl. Elm NE 32.55' 16" Elm SE 49.70' (same as Kent Co. Wits.)
 - 12" Elm SSE 61.0' MBT Pole NW 54.65' Meas. 2758.8' S. to E 1/4 cor.
- 1982---LCRC #3090 for I-13, T6N, R9W---Jonker---1 1/2" Iron 48.8' East of said I-13, T6N, R9W
- 1983---Survey---Byl---1 1/4" Iron Pipe
 - 6" Ash WNW 58.25' C/L Street sign SE 45.7' SW cor. 35-6-9 W 48.85'

B. Description of corner evidence found and/or method applied in restoring or reestablishing corner:

- I-1 Found 1 1/4" Iron Pipe 0.12' North of Twp. line and 48.80' East of I-13, T6N, R9W, (Kent Co. Mon.) over top of 3/4" Iron Pipe on West side of Stone. All 1954 witnesses gone.

Fd. 1983 witnesses: C/L 15" Elm WNW 58.5'±
Meas. S. to E 1/4 corner Sec. 3, 5-9: 2757.57' (1954 W&W: 2758.8')

The 1 1/4" Iron Pipe and 3/4" Iron Pipe next to a Stone are accepted by me and is generally accepted by professional surveyors as the best available evidence of the original corner.

C. Description of monument for corner and accessories established to perpetuate locating the position of the corner:

- I-1 Set Standard Kent Co. Mon. (Harrison) on Twp. line next to Stone in place of the 1 1/4" Iron Pipe and 3/4" Iron Pipe.
- | | | |
|--|-------|--------|
| Kent Co. Mon. (I-13, T6N, R13W) | West | 48.80' |
| N. side stop sign post | S15°E | 52.95' |
| S. side W. post of "arrow" sign | N10°E | 16.23' |
| Set Nail & KC Remon. tag N. side 20" Elm | N50°W | 58.40' |

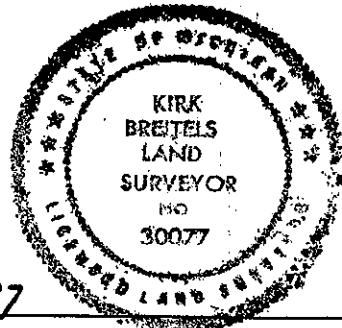

Signed by Kirk Breitels
Surveyor's Michigan License No. 30077

Date 8/28/97

P.A. 345 1990 KENT COUNTY

PEER APPROVED 7/24/97

CHAIRMAN: Harry Hubert