

SURVEY & REMONUMENTATION

MAR 03 1998

KENT COUNTY REMONUMENTATION

SECTION _____

LAND CORNER RECORDATION CERTIFICATE
Filing Requirement of Act 74, Mich. P.A. 1970

For corners in
KENT COUNTY

(County)

Located In: _____ Corner Code # _____

1. Public Land Survey

T 5N R 9W J-10

2. Property Controlling in Section

S _____ T _____ R _____

3. Miscellaneous Property in Sec.

S _____ T _____ R _____

4. Lot No. _____, Recorded Plat _____
5. Private Claims _____

I, Kirk Breitels, in a field survey on Sept. 2, 1997 do hereby state that under requirements of P.A. 74, Michigan P.A. of 1970, the corner points mentioned in lines 1 and 2 above were in conformance with regulations and rules therefore as required in the current manual of survey instructions of the United States Department of the Interior, Bureau of Land Management or by a decree of a Court of Law and/or that the corner points mentioned in lines 3, 4 and 5 above were in conformance with the rules of the Michigan Board of Land Surveyors or by a Decree of a Court of Law, established, re-established, monumented, recovered, found as expressed below:

NOTE: Not more than 2 corners, all in the same town and range, may be recorded on this certificate.

A. Description of original monument and accessories and/or subsequent restoration:

J-10 1830---GLO---Not Set
Williams & Works---No information
Kent Co. Wits.---No information

P.A. 345 1990 KENT COUNTY
PEER APPROVED 9/25/97
CHAIRMAN Henry Huber

B. Description of corner evidence found and/or method applied in restoring or reestablishing corner:
J-10 Established intersection of 1/4 lines and found nothing at corner.
Fence corner for fences North and West is 2' South and 6' West.

No other information available.

The Intersection of 1/4 lines is accepted by me and is generally accepted by professional surveyors as the best available evidence of the position of the corner.

C. Description of monument for corner and accessories established to perpetuate locating the position of the corner:
J-10 Set Standard Kent Co. Monument (Harrison) at the Intersection of 1/4 lines.

- Nail & KC Remon. tag N. side 14" Elm N70°W 66.86'
- Nail & KC Remon. tag NW side 32" Beech S30°W 72.70'
- Nail & KC Remon. tag E. side 36" Beech S00°E 73.29'
- Nail & KC Remon. tag E. side 36" Beech S25°E 49.87'
- Nail & KC Remon. tag SE side 26" Beech N40°E 45.43'
- Nail & KC Remon. tag SW side 14" Maple N35°W 62.20'

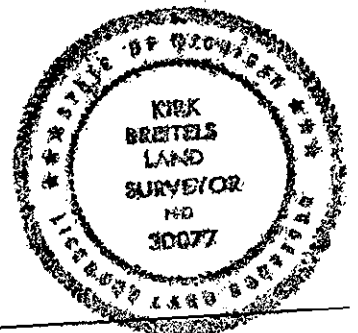

Signed by Kirk Breitels
Surveyor's Michigan License No. 30077

Date 10/30/97

STATE OF MICHIGAN
COUNTY OF KENT
RECEIVED FOR RECORD
97 NOV 13 PM 1:01
REG. OF DEEDS
W. J. Bond

10269

Register of Deeds Stamp & File Number

	A	B	C	D	E	F	G	H	I	J	K	L	M
1													
2	6		5		4		3		2				
3													
4	7		8		9		10		11		12		
5													
6	18		17		16		15		14		13		
7													
8	19		20		21		22		23		24		
9													
10	30		29		28		27		26		25		
11													
12	31		32		33		34		35		36		
13													