

SURVEY & REMONUMENTATION

KENT COUNTY REMONUMENTATION

MAR 03 1998

LAND CORNER RECORDATION CERTIFICATE
Filing Requirement of Act 74, Mich. P.A. 1970

STATE OF MICHIGAN
 COUNTY OF KENT
 RECEIVED FOR RECORD
 97 APR 29 AM 8:19
 REG. OF DEEDS
Lucy Bond

For corners in **SECTION**
KENT COUNTY

	Located In:	Corner Code #
(County)		
1. Public Land Survey	T <u>5N</u> R <u>9W</u>	<u>J-13</u>
	T <u> </u> R <u> </u>	<u> </u>
	T <u> </u> R <u> </u>	<u> </u>
	T <u> </u> R <u> </u>	<u> </u>
2. Property Controlling in Section	S <u> </u> T <u> </u> R <u> </u>	<u> </u>
	S <u> </u> T <u> </u> R <u> </u>	<u> </u>
3. Miscellaneous Property in Sec.	S <u> </u> T <u> </u> R <u> </u>	<u> </u>
	S <u> </u> T <u> </u> R <u> </u>	<u> </u>

9769

Register of Deeds Stamp & File Number

4. Lot No. _____, Recorded Plat _____
5. Private Claims _____

I, Kirk Breitels, in a field survey on Mar. 13, 1997 do hereby state that under requirements of P.A. 74, Michigan P.A. of 1970, the corner points mentioned in lines 1 and 2 above were in conformance with regulations and rules therefore as required in the current manual of survey instructions of the United States Department of the Interior, Bureau of Land Management or by a decree of a Court of Law and /or that the corner points mentioned in lines 3, 4 and 5 above were in conformance with the rules of the Michigan Board of Land Surveyors or by a Decree of a Court of Law; established, re-established, monumented, recovered, found as expressed below:

NOTE: Not more than 2 corners, all in the same town and range, may be recorded on this certificate.

	A	B	C	D	E	F	G	H	I	J	K	L	M
1													
2		6		5		4		3		2		1	
3													
4		7		8		9		10		11		12	
5													
6		18		17		16		15		14		13	
7													
8		19		20		21		22		23		24	
9													
10		30		29		28		27		26		25	
11													
12		31		32		33		34		35		36	
13													

A. Description of original monument and accessories and/or subsequent restoration:

J-13	1830	GLO	Mullett	Set Post
		Kent Co. Wit.		Stone, brick, crockery
	1984	Exxel Eng.		Cor. 11.0' East of J-1, 4-9
	1995	LCRC #8754	Jonker	Set Kent County Monument

The position of this corner was previously approved by the Kent County Remonumentation Peer Group, monumented by Robert J. Jonker on 8/24/95 and was recorded per LCRC #8754

B. Description of corner evidence found and/or method applied in restoring or reestablishing corner:

J-13 Found standard Kent Co. Mon. (Harrison) per witnesses from above LCRC as set by Robert J. Jonker 11.0' East of J-1, T4N, R9W. Agrees with Exxel Eng. information.

LCRC #8754

KC Remon. tag NE side P. Pole	S65°E	166.9'
KC Remon. tag SE side 18" Ash	N45°E	79.6'
PK Nail NE side P. Pole	N40°W	92.05'
PK Nail & washer NE side P. Pole	S50°W	90.28'
Iron East 11.0'		

The selected location is accepted by me and is generally accepted by professional surveyors as the best available evidence of the position of the original corner.

C. Description of monument for corner and accessories established to perpetuate locating the position of the corner:

J-13 Standard Kent County Monument

Nail & KC Remon. tag NE side P. Pole	S65°E	166.87'
Nail & KC Remon. tag SE side 18" Ash	N45°E	79.56'
Nail & KC Remon. tag NE side new P. Pole	N40°W	90.98'
Nail & KC Remon. tag NW side new P. Pole	S50°W	91.07'
Iron pipe, J-1, T4N, R9W	West	11.00'
On C/L gravel road E-W ±		

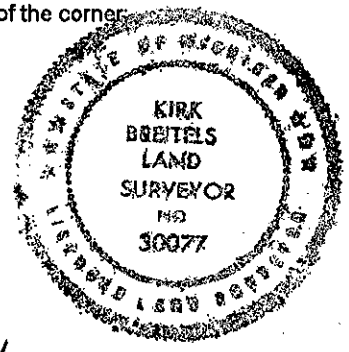

Signed by *Kirk Breitels*

Date 3/27/97

Surveyor's Michigan License No. 30077

P.A. 345 1990 KENT COUNTY
PEER APPROVED 3/27/97
CHAIRMAN *Harry Hubers*